

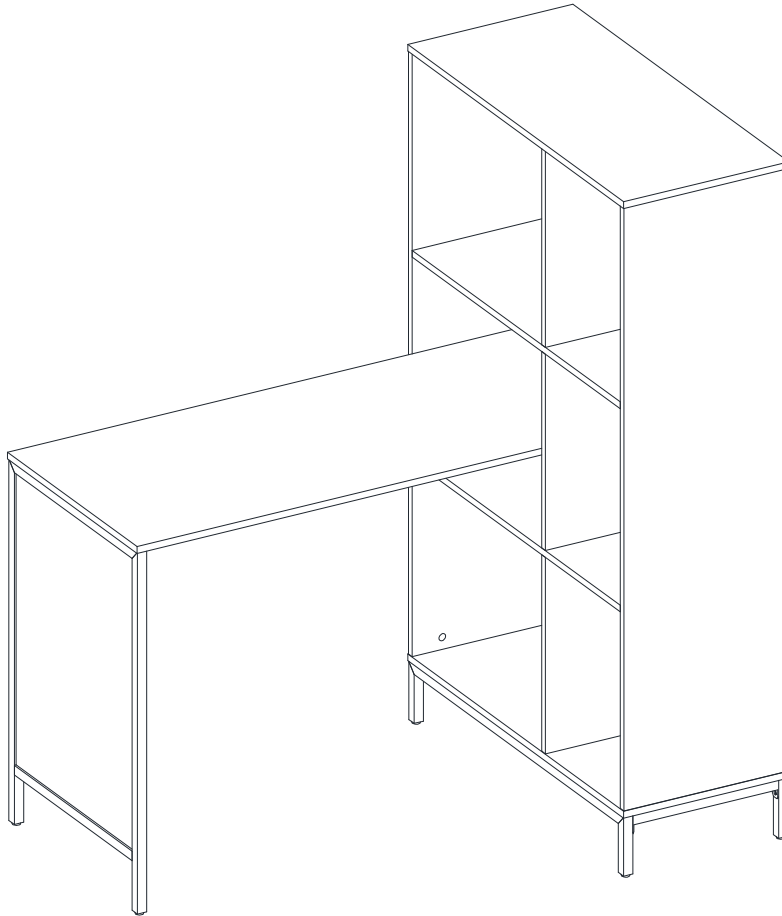

LOT NUMBER: _____
DATE PURCHASED: __/__/__

Turing 48" Corner Desk with Power Strip

Model # SPLS-TU48CD



ADULT ASSEMBLY REQUIRED DUE TO THE PRESENCE OF SMALL PARTS, SHARP POINTS, SHARP EDGES AS RECEIVED

If you have any questions regarding assembly or if parts are missing, DO NOT return this item to the store where it was purchased. Please call our toll-free customer service number and have your instructions and parts list ready to provide the model name, part name or factory number:

1-866-942-5362

Pacific Standard Time: 8:30 a.m. - 4:30 p.m., Monday - Friday
Or visit our web site 24 hours a day, 7 days a week for product assistance at

www.whalenfurniture.com

Or e-mail your request to **parts@whalenfurniture.com**

**THIS INSTRUCTION BOOKLET CONTAINS IMPORTANT SAFETY INFORMATION.
PLEASE READ AND KEEP FOR FUTURE REFERENCE.**

Date 2020-01-29 Rev. 0001-A

MAXIMUM RECOMMENDED WEIGHT LOADS

MANUFACTURER: Whalen Furniture Manufacturing
CATALOG: Turing 48" Corner Desk with Power Strip
MODEL # SPLS-TU48CD

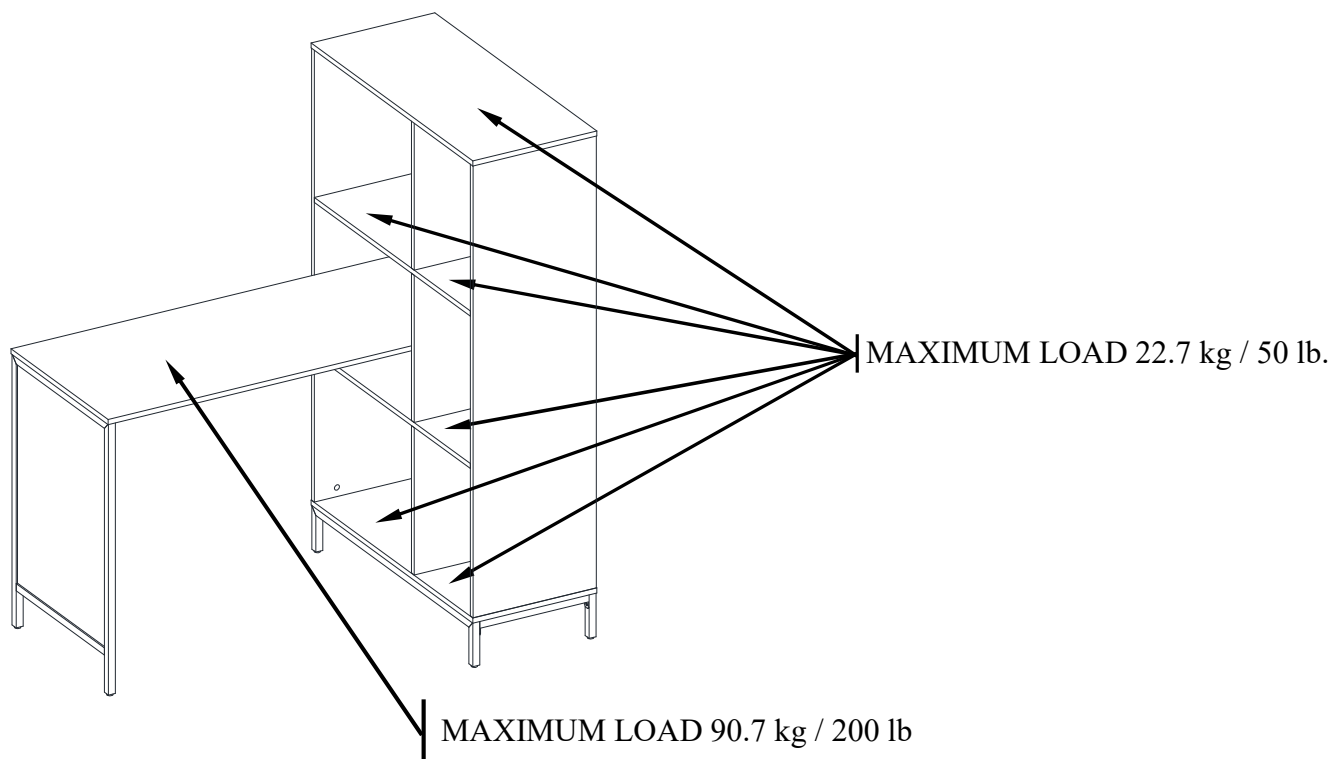

⚠ WARNING

THIS UNIT IS INTENDED ONLY FOR USE WITHIN THE MAXIMUM WEIGHTS INDICATED. USE WITH LOAD HEAVIER THAN THE MAXIMUM WEIGHTS INDICATED MAY RESULT IN INSTABILITY, CAUSING POSSIBLE INJURY.

SPECIAL NOTE

Please read the instruction sheets completely before assembly. Examine all packaging material before discarding carton. Remove any remaining staples from the carton before discarding. Remove all parts from carton and separate into groups as indicated on part list. Please ensure all parts are included prior to assembly. Use of power tools to complete assembly is not recommended.

IMPORTANT

Before you begin: Open, identify and count all parts prior to assembly. Lay out parts on a flat and non-abrasive surface. You will need the parts identified on page 6 and 7 of this instruction manuals.

NOTE: IT IS VERY IMPORTANT TO USE GLUE WITH DOWELS. EXCESS GLUE CAN BE WIPED OFF WITH DAMP CLOTH.

Insert the Dowel at least half way by tapping lightly with a rubber mallet, IF NECESSARY.

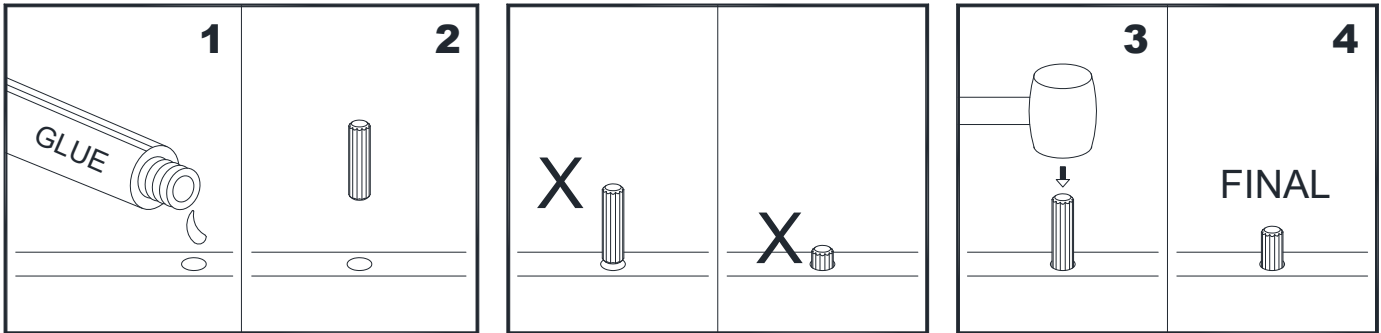

CAM LOCK SYSTEM OPERATION

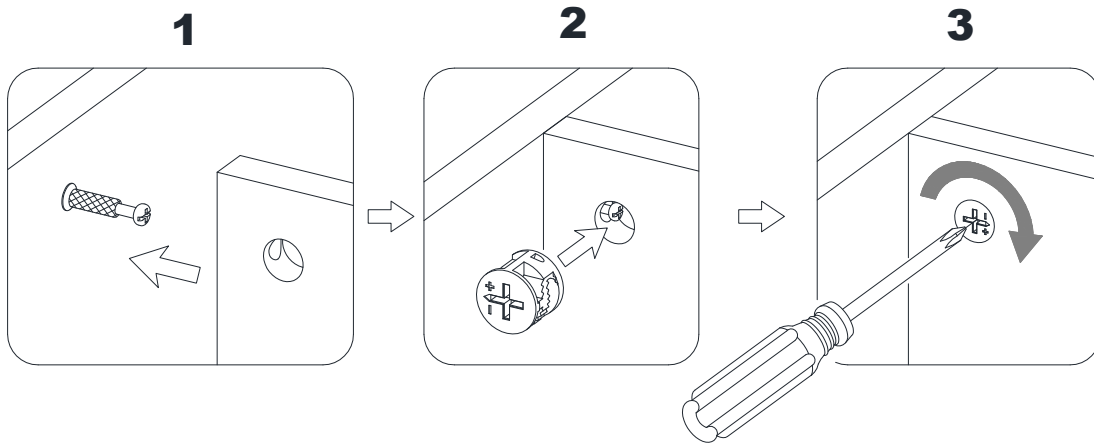

HOW THE KNOCK DOWN (KD) ASSEMBLY SYSTEM WORKS

1. Screw the Cam Bolt into the pre-drilled small holes on the panel. Connect both panels together; making sure the Cam Bolt goes into the pre-drilled hole at the end of the panel with the Cam Lock.
2. Insert the Cam Lock into the pre-drilled large hole in the panel. Make sure the arrow on the Cam Lock is pointed towards the Cam Bolt.
3. Once the Cam Bolt is connected inside the Cam Lock, take a Phillips screwdriver (not included) and tighten the Cam Lock clockwise.
4. Cover the cam locks with the PVC stickers provided.

You are now ready to assemble the KD unit.

FURNITURE POWER DISTRIBUTION CENTER IMPORTANT SAFETY INSTRUCTIONS

Carefully read all instructions before installing and operating fixture

**IF YOU HAVE ANY QUESTIONS REGARDING THE PROPER INSTALLATION
CONSULT A QUALIFIED ELECTRICIAN.**

**⚠ WARNING TO REDUCE THE RISK OF FIRE, ELECTRICAL SHOCK OR
INJURY TO PERSONS, PLEASE FOLLOW THE BELOW:**

- Use only insulated staples or plastic ties (not included) to secure the cords.
- Route and secure cords so that they will not be pinched or damaged when the desk is pushed up against the wall.
- Make sure cord is not pinched between desk and floor.
- Use the unit for indoor use only.
- Do not use an extension cord to connect this unit to a wall outlet.
- Use a power strip with integral over-current protection to supply other electrical devices or accessories in desk.
- This unit must be plugged into a properly grounded outlet.
- The socket-outlet should be installed near the equipment and should be easily accessible.
- Maximum load of connected equipment cannot exceed a total of 12 amps and 120 volts.
- Do not open or disassemble this unit for any reason.

SAVE THESE INSTRUCTIONS

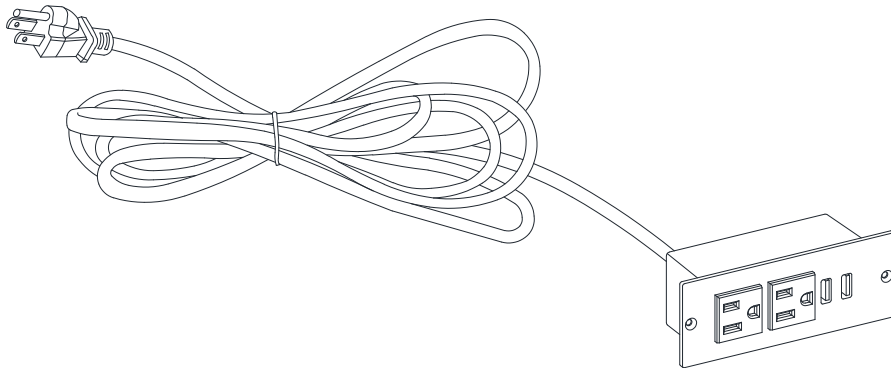

Furniture Power Distribution Unit User Guide

Please read this user guide before installing and using your power distribution Center.

INTRODUCTION

The integrated power and USB center offer 480 Mbps high transmission rate and can connect up to two devices, such as a digital camera, MP3 player, cell phone or wireless mouse.

SPECIFICATIONS

cULus listed, rated for: 120 V ac, 12 A, 60 Hz

NOTES

- To reach USB 2.1 high speed, your computer or host adapter card must support USB 2.1. This hub is also backwards compatible with USB 1.1.
- When using the hub with a computer that has a version 1.1 USB interface, all of the devices attached to the hub will run at USB 1.1 speed.

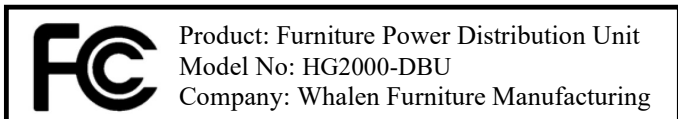

NOTE: This equipment has been tested and found to comply with the limits for a Class B digital device, pursuant to part 15 of the FCC Rules. These limits are designed to provide reasonable protection against harmful interference in a residential installation. This equipment generates, uses and can radiate radio frequency energy and, if not installed and used in accordance with the instructions, may cause harmful interference to radio communications. However, there is no guarantee that interference will not occur in a particular installation.

If this equipment does cause harmful interference to radio or television reception, which can be determined by turning the equipment off and on, the user is encouraged to try to correct the interference by one or more of the following measures:

- Reorient or relocate the receiving antenna.
- Increase the separation between the equipment and receiver.
- Connect the equipment into an outlet on a circuit different from that to which the receiver is connected.
- Consult the dealer or an experienced radio/TV technician for help.

This device complies with Part 15 of the FCC Rules. Operation is subject to the following two conditions: (1) This device may not cause harmful interference, and (2) this device must accept any interference received, including interference that may cause undesired operation.

CAN ICES-3 (B)/NMB-3(B)

This Class B digital apparatus complies with Canadian ICES-003.

Whalen Furniture Manufacturing
1578 Air Wing Road, San Diego, CA 92154, USA
1-866-942-5362

WARNINGS

- ! Your hub automatically shuts off any port with a low or excessive current.
- ! If USB Hub Current Limit Exceeded appears on your screen, disconnect the affected USB device, click Reset on the screen, and reconnect the device.
- ! If one of your hub ports is disabled, but USB Hub Current Limit Exceeded does not appear:
 - Disconnect and reconnect the affected device.
 - If the port still does not work, disconnect the hub and the device, and then reconnect.
- ! Keep your desktop hub dry; if it gets wet, wipe it dry immediately.
- ! Do not modify or tamper with your desktop hub's internal components. It may cause a malfunction and invalidate its warranty.
- ! Modifications not approved by the party responsible for compliance could void user's authority to operate the equipment.

Parts and Hardware List

Please read completely through the instructions and verify that all listed parts and hardware are present before beginning assembly.

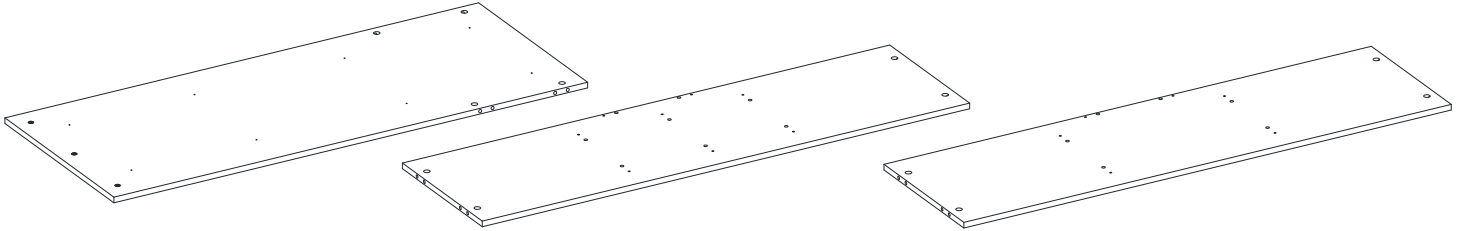

A- Desk Top (Qty. 1) B- Bookcase Left Side Panel (Qty. 1) C- Bookcase Right Side Panel (Qty. 1)

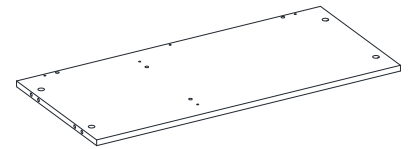
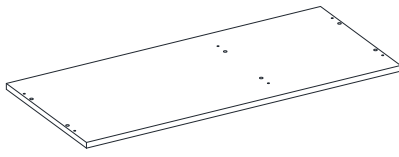
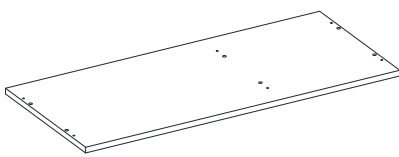

D- Bookcase Top Panel (Qty. 1)

E- Bookcase Bottom Panel (Qty. 1)

F- Upper Shelf (Qty. 1)

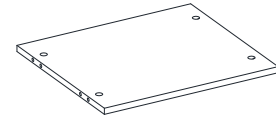
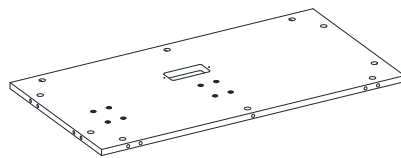
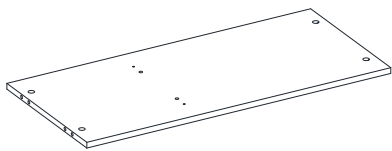

G- Lower Shelf (Qty. 1)

H- Back Panel (Qty. 1)

I- Upper/Lower Partition Panel (Qty. 2)

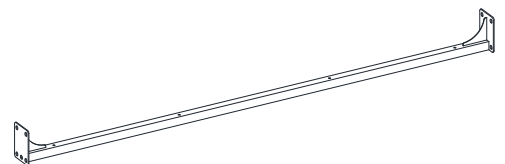
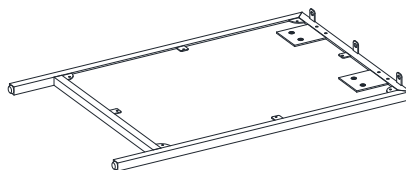
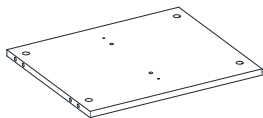

J- Middle Partition Panel (Qty. 1)

K- Desk Side Frame (Qty. 1)

L- Desk Top Stretcher (Qty. 2)

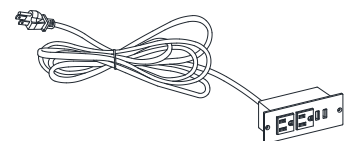
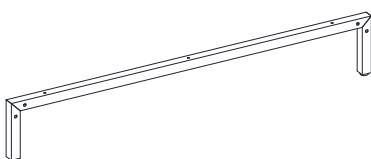

M- Base Long Support
(Qty. 2)

N- Base Short Support
(Qty. 2)

O- Power Center
(Qty. 1)

Parts and Hardware List

Please read completely through the instructions and verify that all listed parts and hardware are present before beginning assembly.

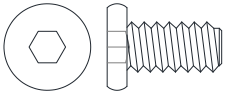

(1) 1/4" x 12 mm Bolt
(Qty. 27+1 extra)



(2) Lock Washer
(Qty. 27+1 extra)

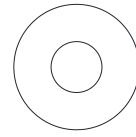

(3) Flat Washer
(Qty. 27+1 extra)



(4) Cam Lock
(Qty. 42+2 extra)

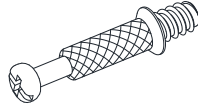

(5) Cam Bolt
(Qty. 42+2 extra)

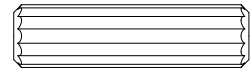

(6) M8 x 30 mm Wood Dowel
(Qty. 40+2 extra)

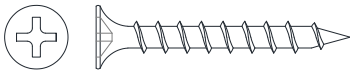

(7) M4 x 32 mm Screw
(Qty. 18+1 extra)



(8) M3.5 x 12 mm Screw
(Qty. 2+1 extra)

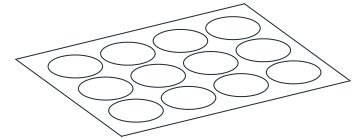

(9) PVC Cover
(Qty. 42+2)



Hex Wrench
(Qty. 1)

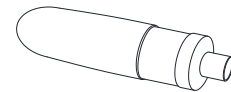

Glue
(Qty. 1)

Tools required (not included): Phillips screwdriver.

Assembly Instructions

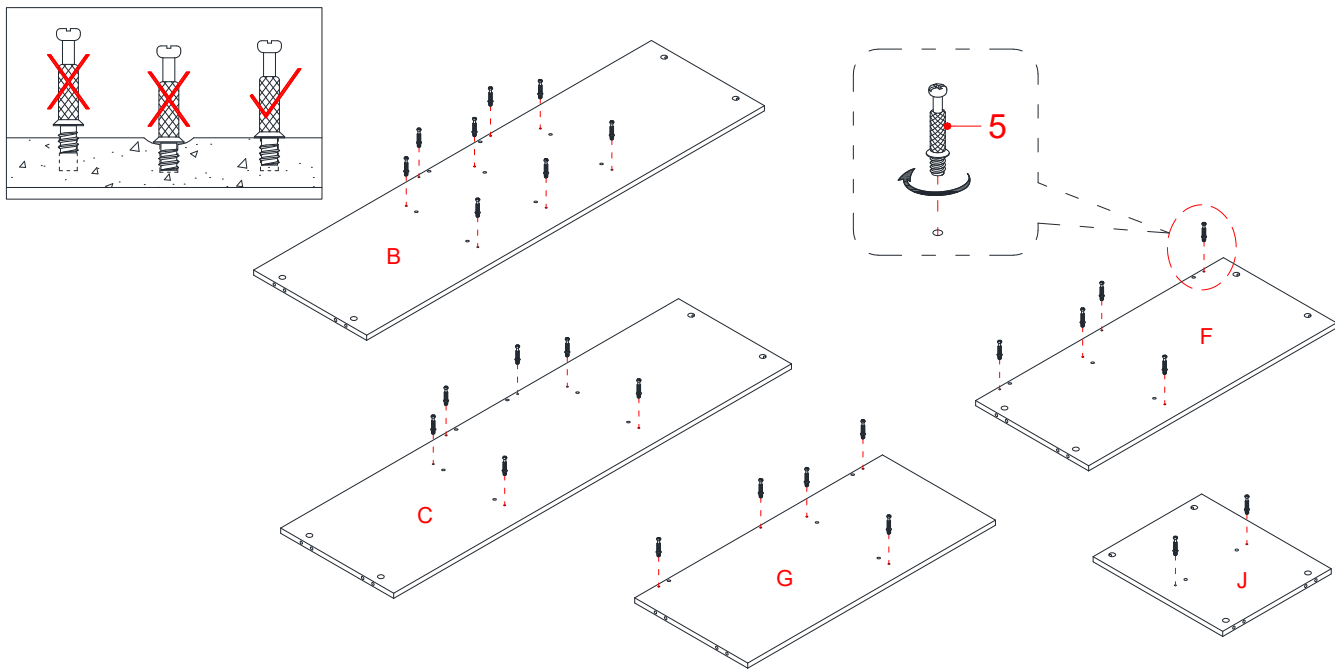

NOTE: Please do not fully tighten all bolts until you finish assembling all parts. Once assembled, go back and fully tighten all bolts. This will make the assembly easier.

1. Unpack the unit and confirm that you have all the hardware and required parts. Assemble the unit on a carpeted floor or the empty carton to avoid any scratch.
2. Securely screw the Cam Bolts (5) into the designated small holes on the Panels (B, C, F, G and J) with a Phillips screwdriver. DO NOT overtighten the Cam Bolts.

NOTE: Screw-in cam bolts must be screwed down flush.

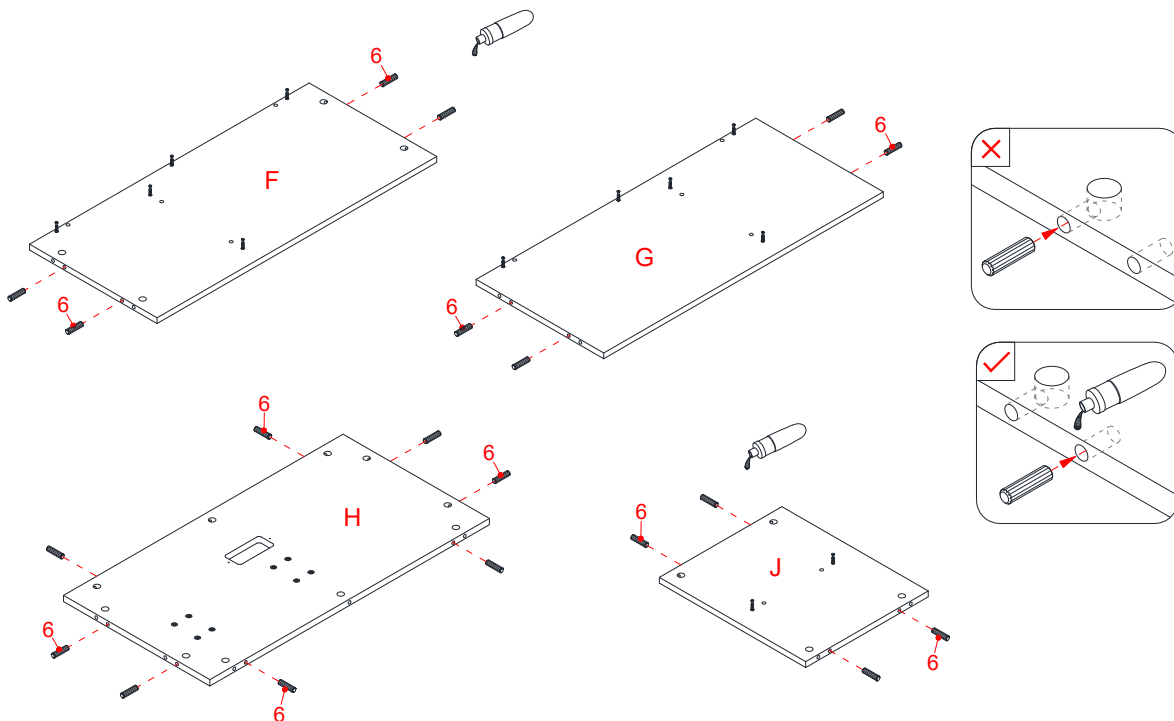

3. Glue the 30 mm Wood Dowels (6) into the inner holes on the Shelves (F and G) and the Panels (H and J). Make sure that you use a small amount of glue with both ends of all dowels.

NOTE: It is very important to use a small amount of glue on both ends of dowels.

Assembly Instructions

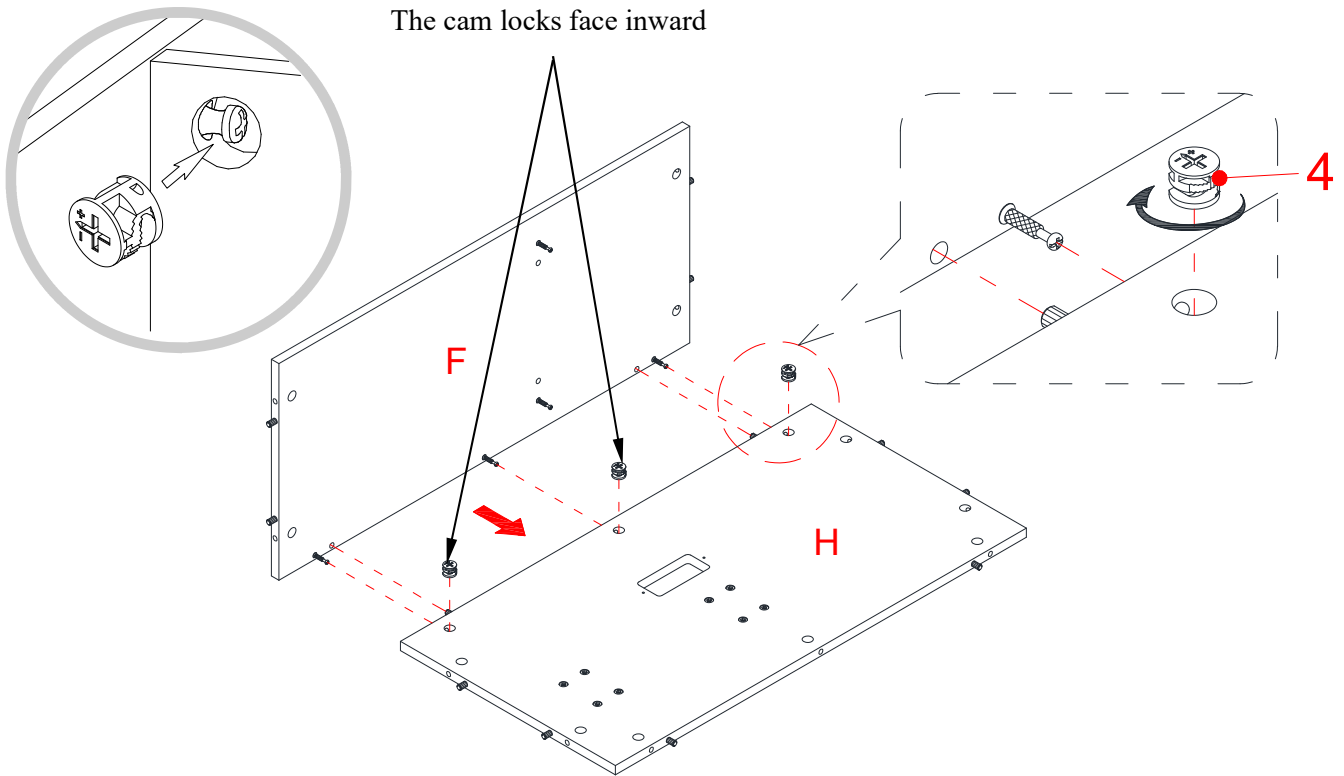

4. Align and attach the Upper Shelf (F) to the Back Panel (H) by engaging three Cam Locks (4). (Refer to page 3 on Cam Lock system operation supplement).

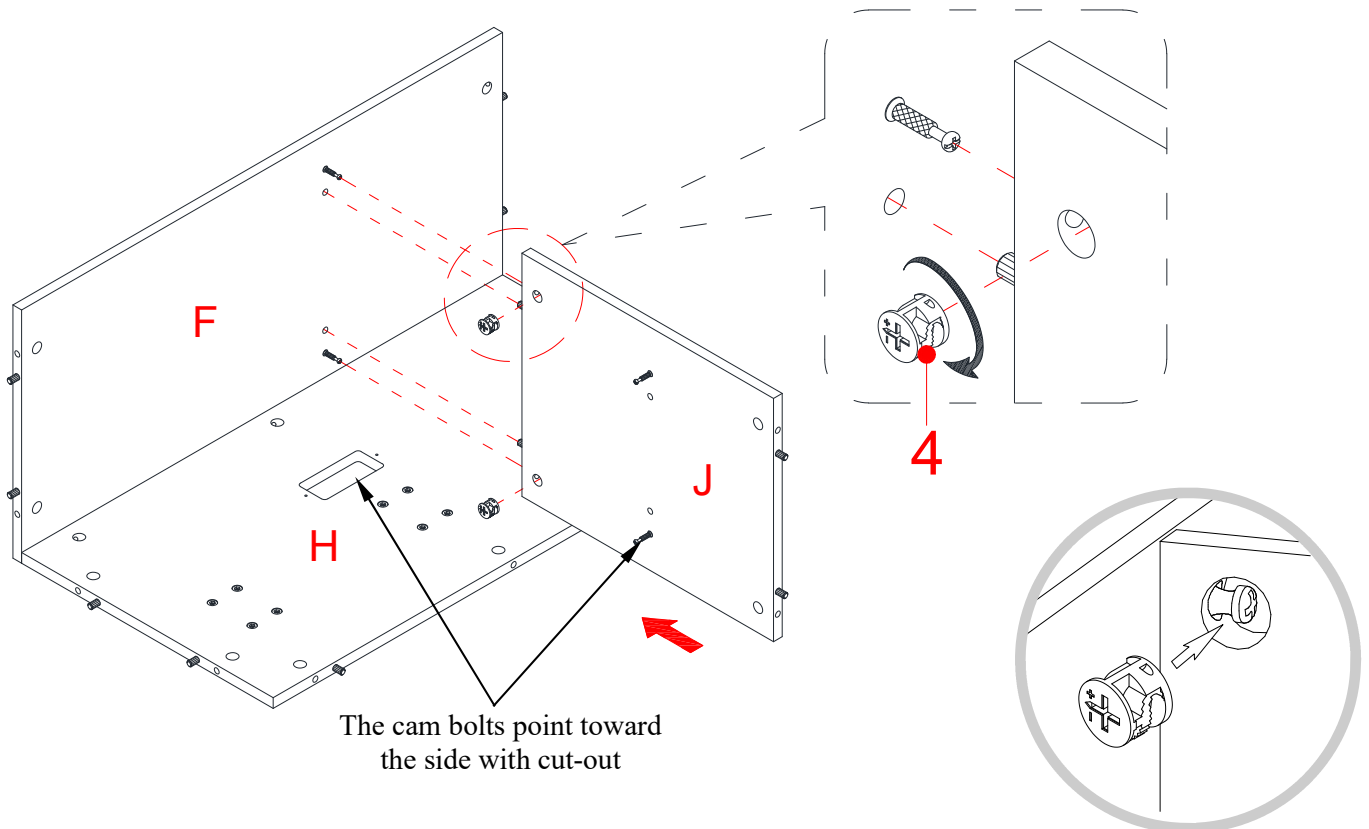

5. Align and attach the Middle Partition Panel (J) to the Upper Shelf (F) by engaging two Cam Locks (4).

Assembly Instructions

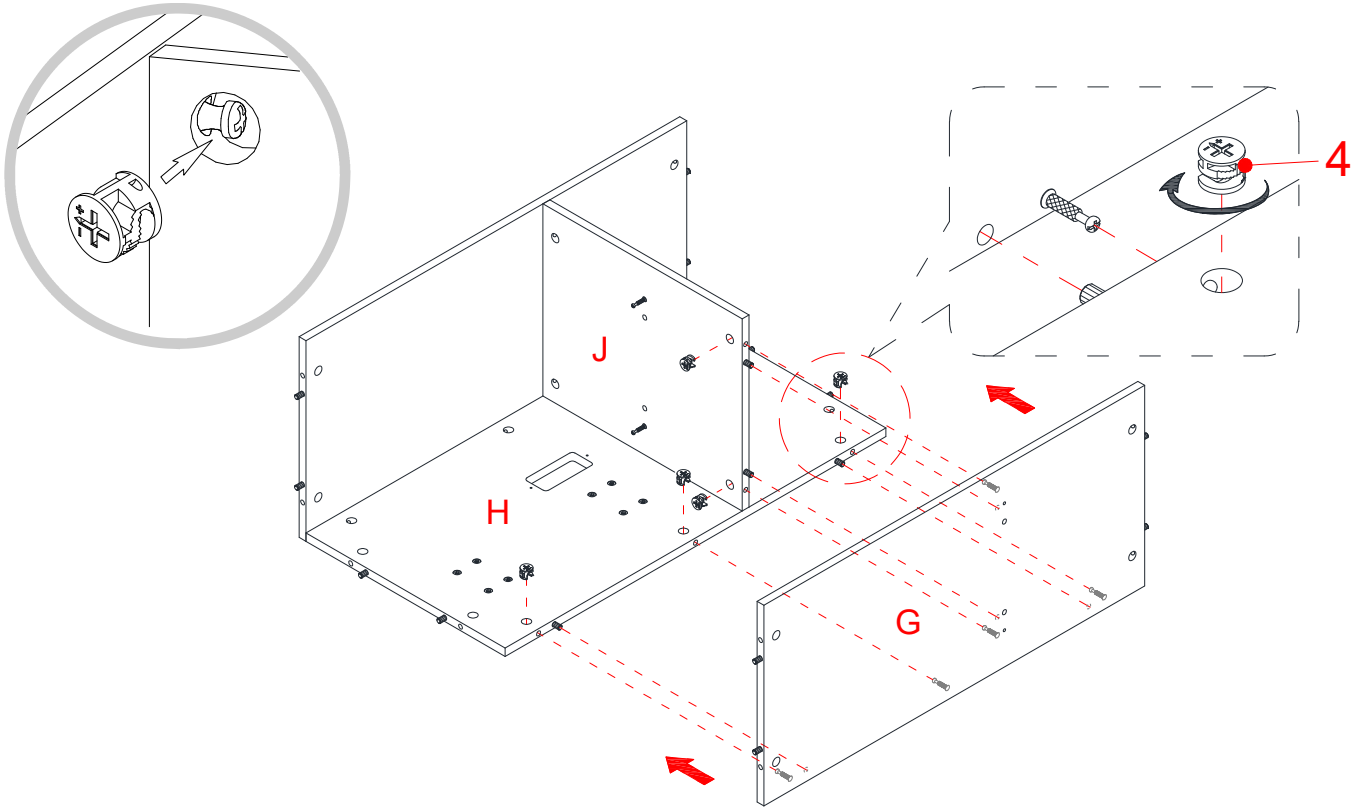

6. Align and attach the Lower Shelf (G) to the previous assembly by engaging five Cam Locks (4).

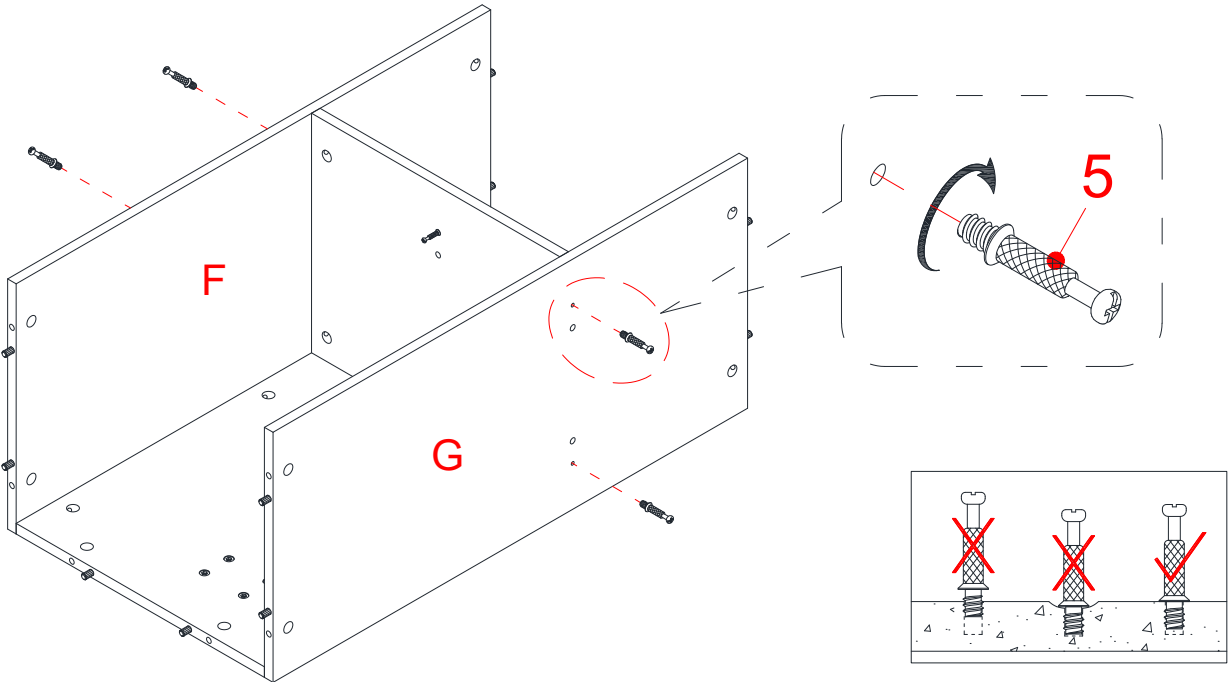

7. Securely screw the Cam Bolts (5) into the designated small holes on the Shelves (F and G) using a Phillips screwdriver.

Assembly Instructions

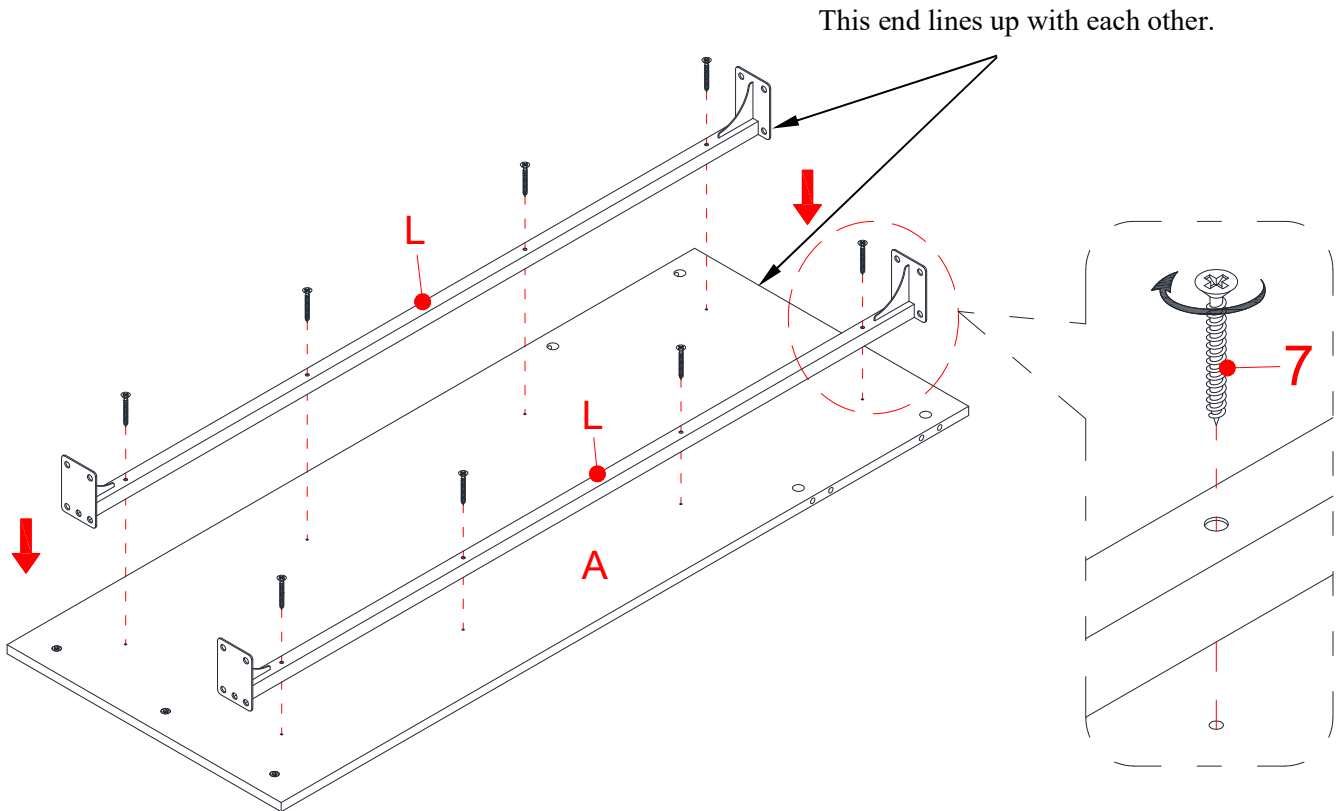

- Using the pilot holes as a guide, align and attach two Desk Top Stretchers (L) to the Desk Top (A) with eight 32 mm Screws (7).

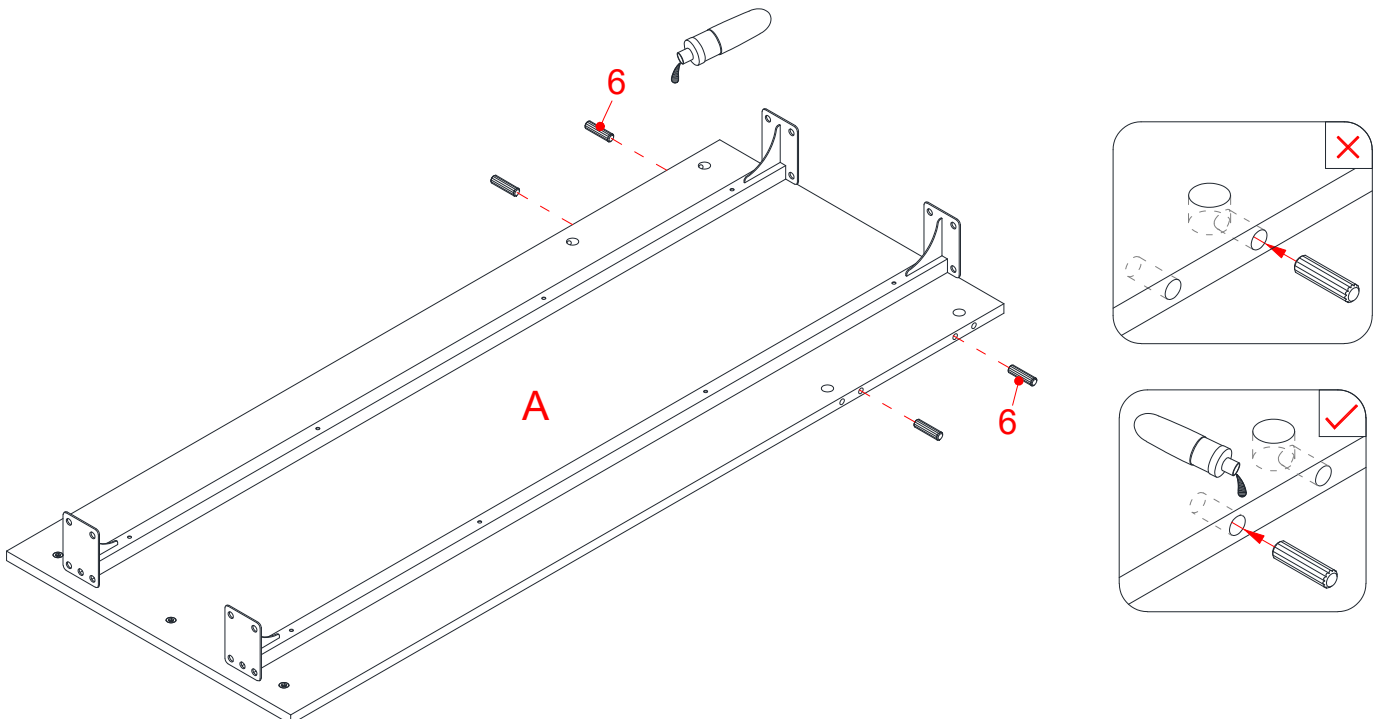

- Glue four Wood Dowels (6) into the inner holes of Desk Top (A).

Assembly Instructions

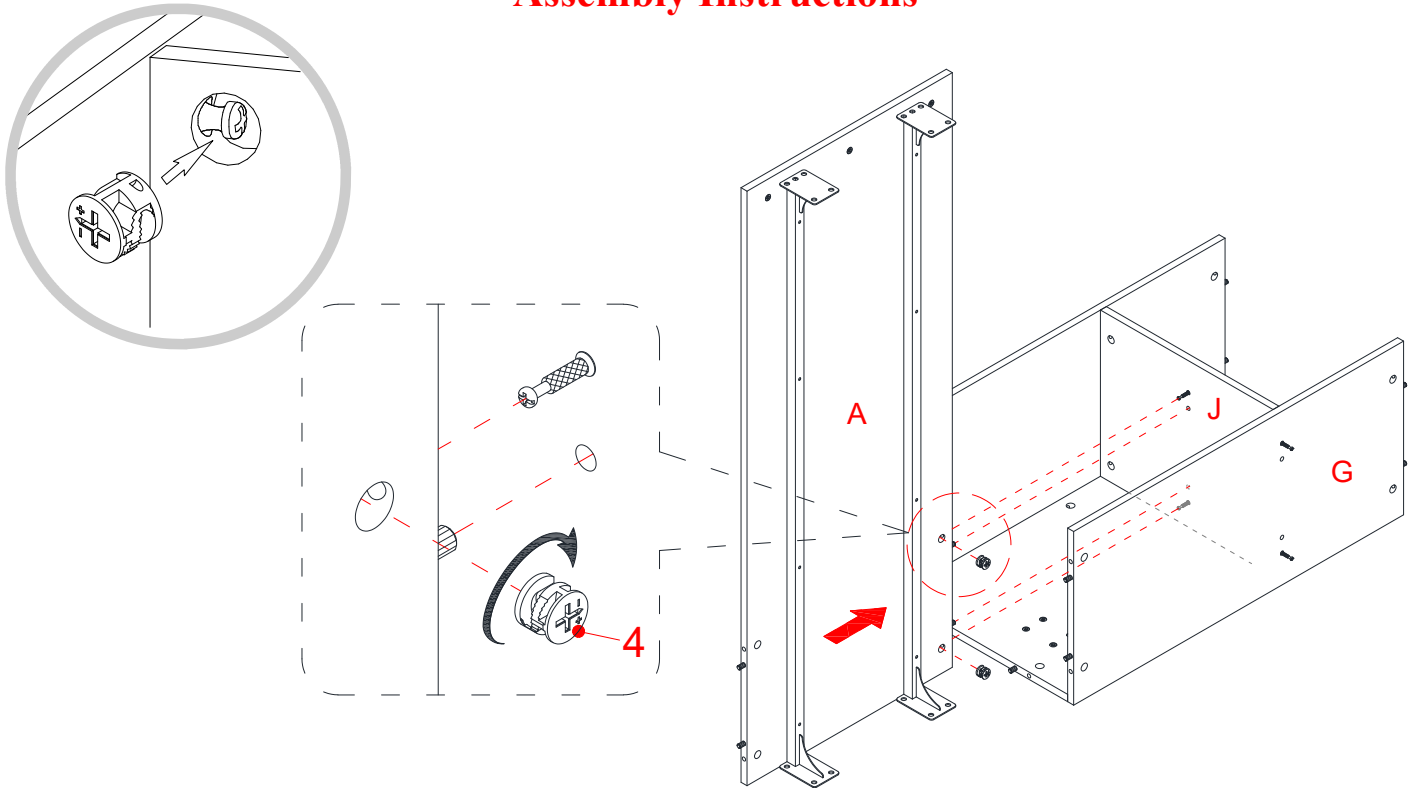

10. Using the wood dowels as a guide, align and attach the Desk Top (A) to the Middle Partition Panel (J) by engaging two Cam Locks (4).

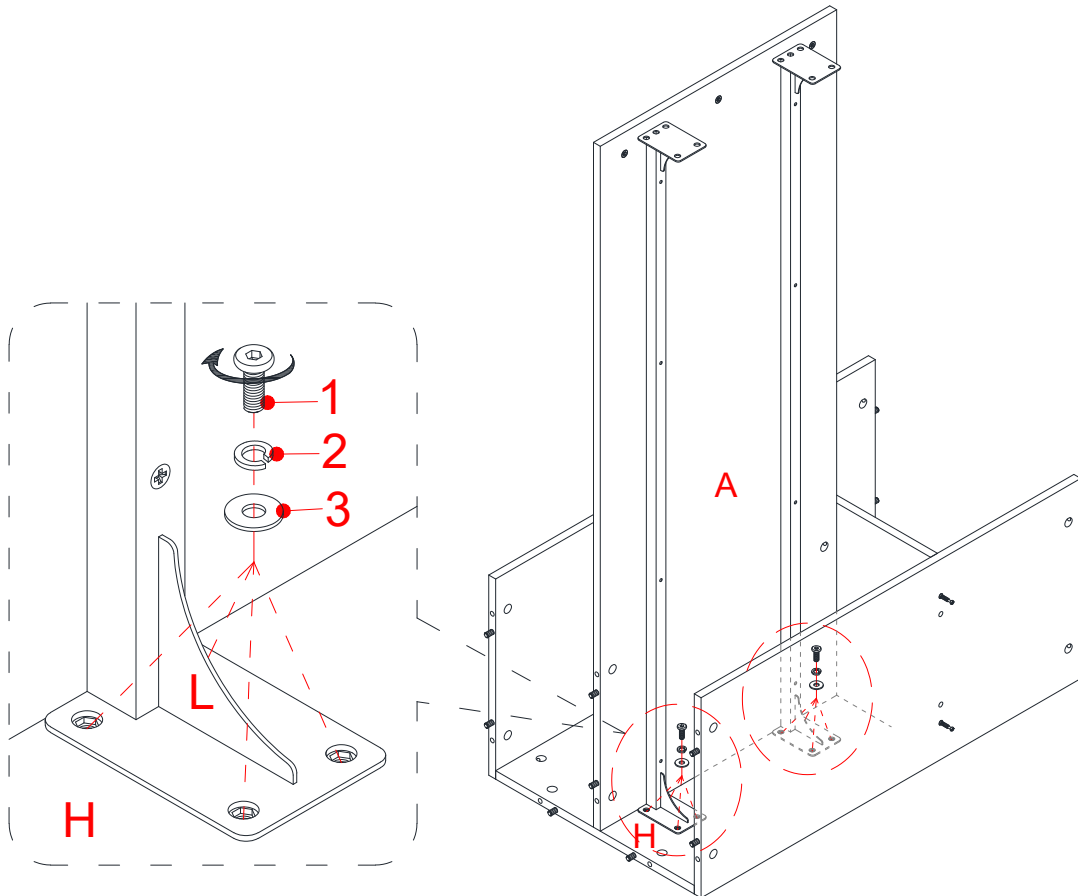

11. Fasten the assembled Desk Top Stretchers (L) to the Back Panel (H) by attaching eight 12 mm Bolts (1) and eight Washers (2 and 3).

Assembly Instructions

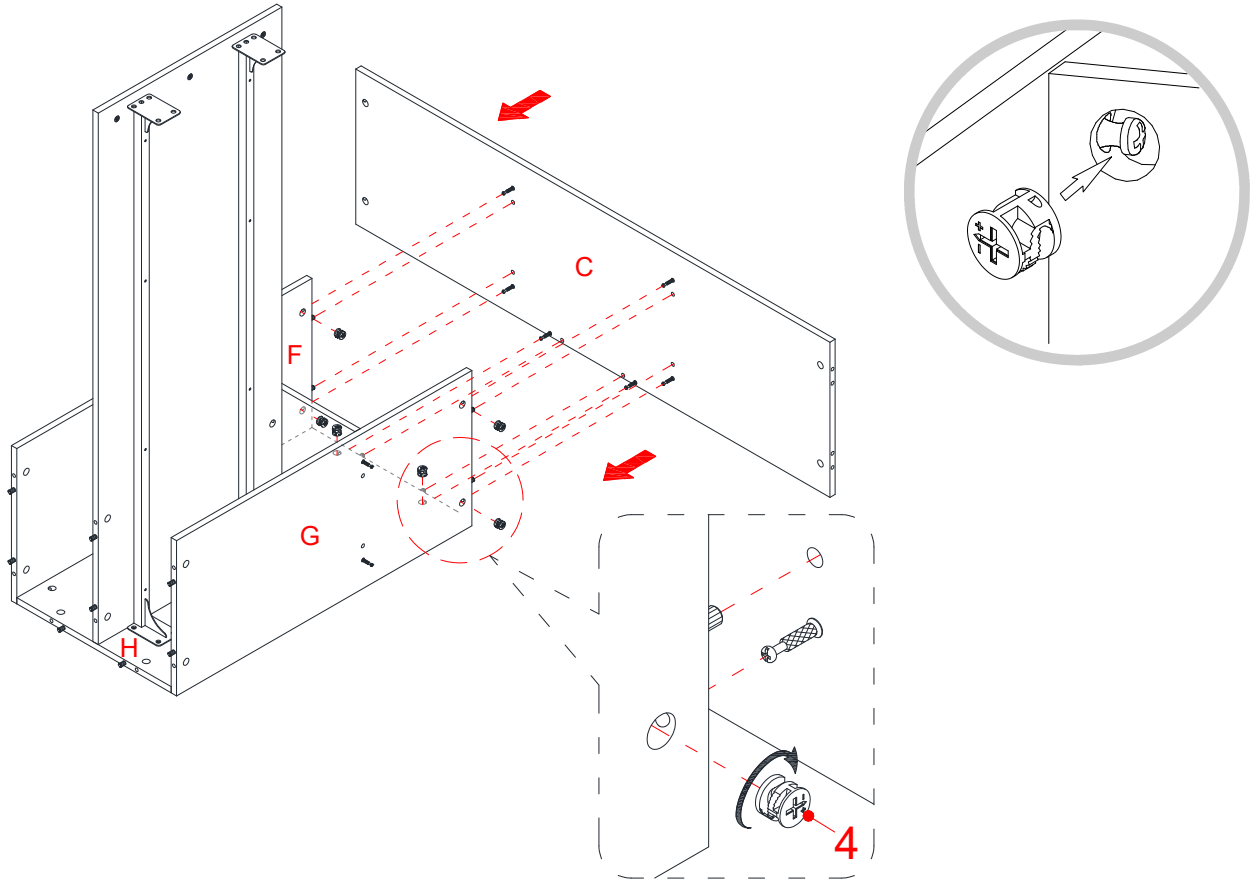

12. Align and attach the Bookcase Right Side Panel (C) to the assembled Shelves (F and G) and Back Panel (H) by engaging six Cam Locks (4).

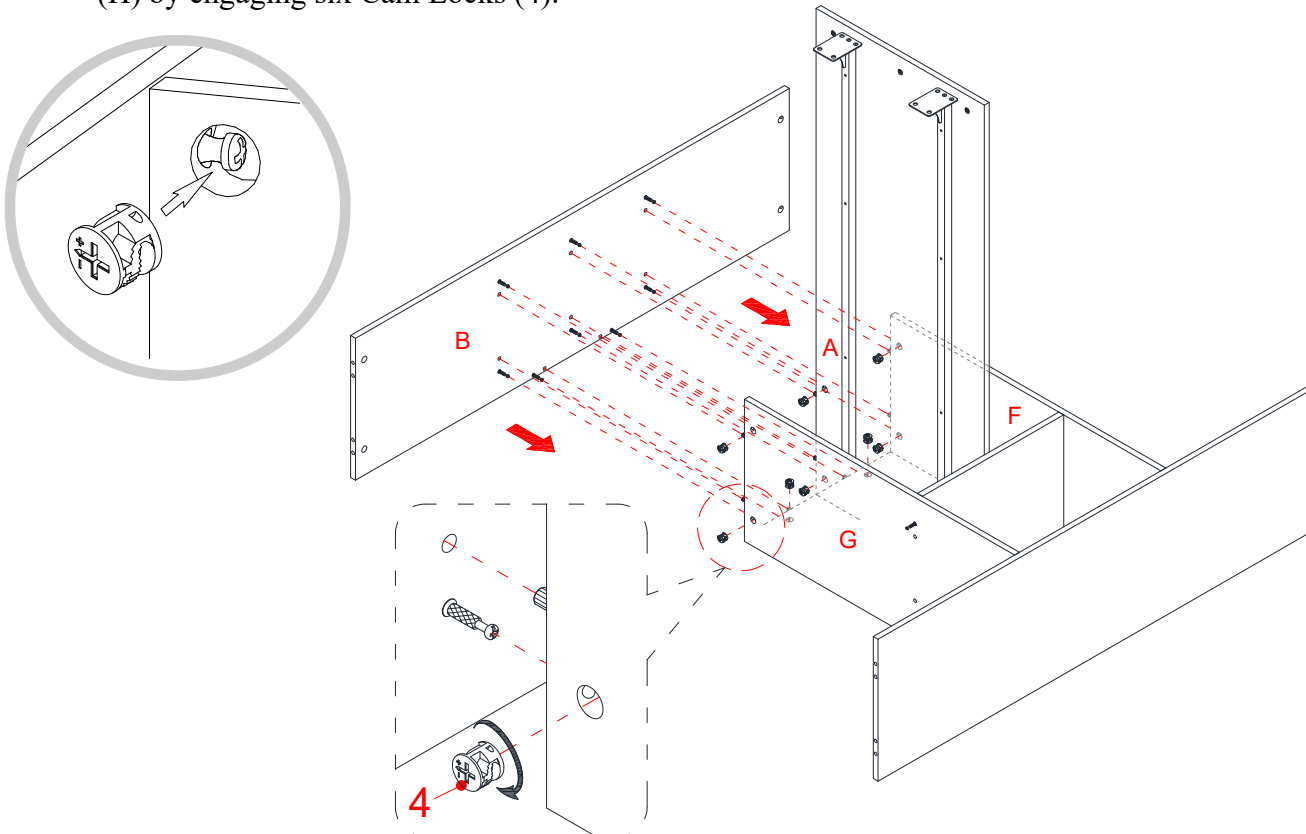

13. Align and attach the Bookcase Left Side Panel (B) to the assembled unit by engaging eight Cam Locks (4).

Assembly Instructions

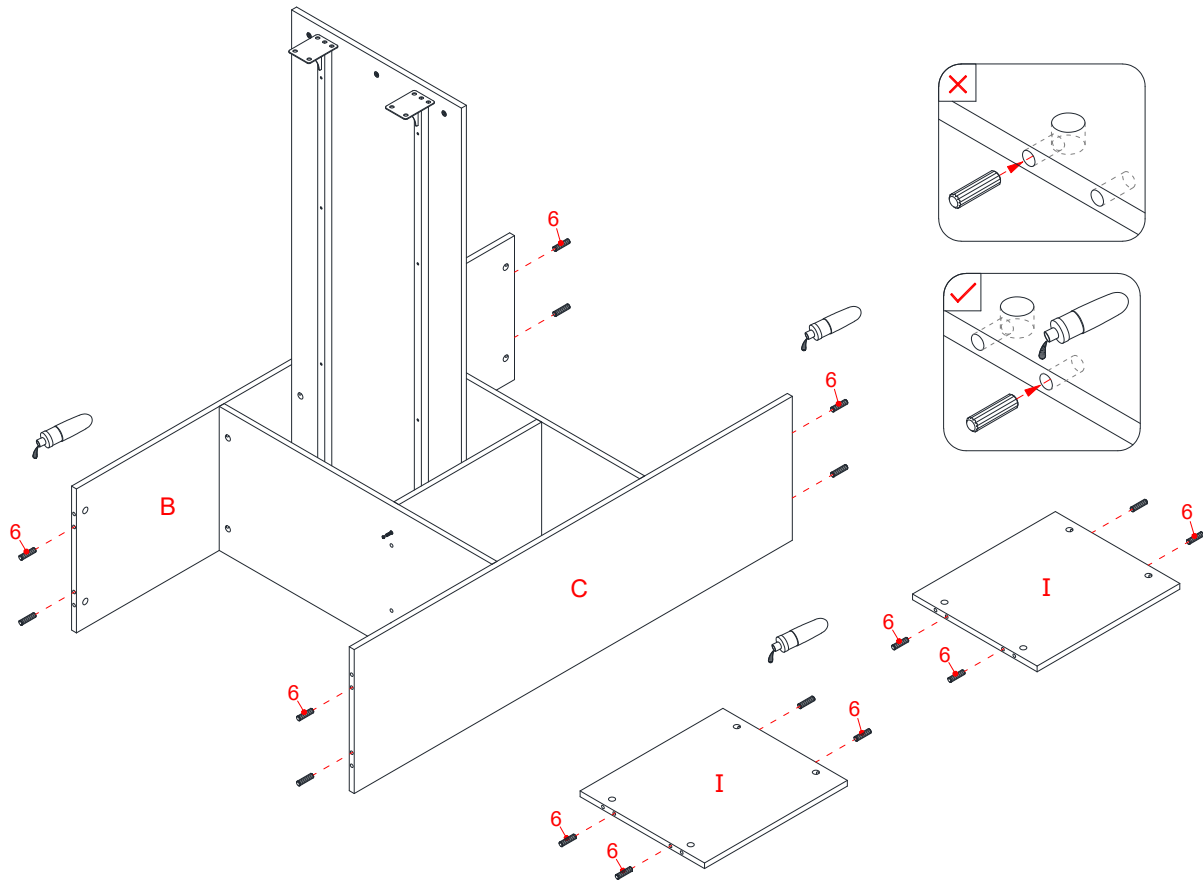

14. Glue the Wood Dowels (6) into the inner holes of assembled Side Panels (B and C), Upper and Lower Partition Panels (I).

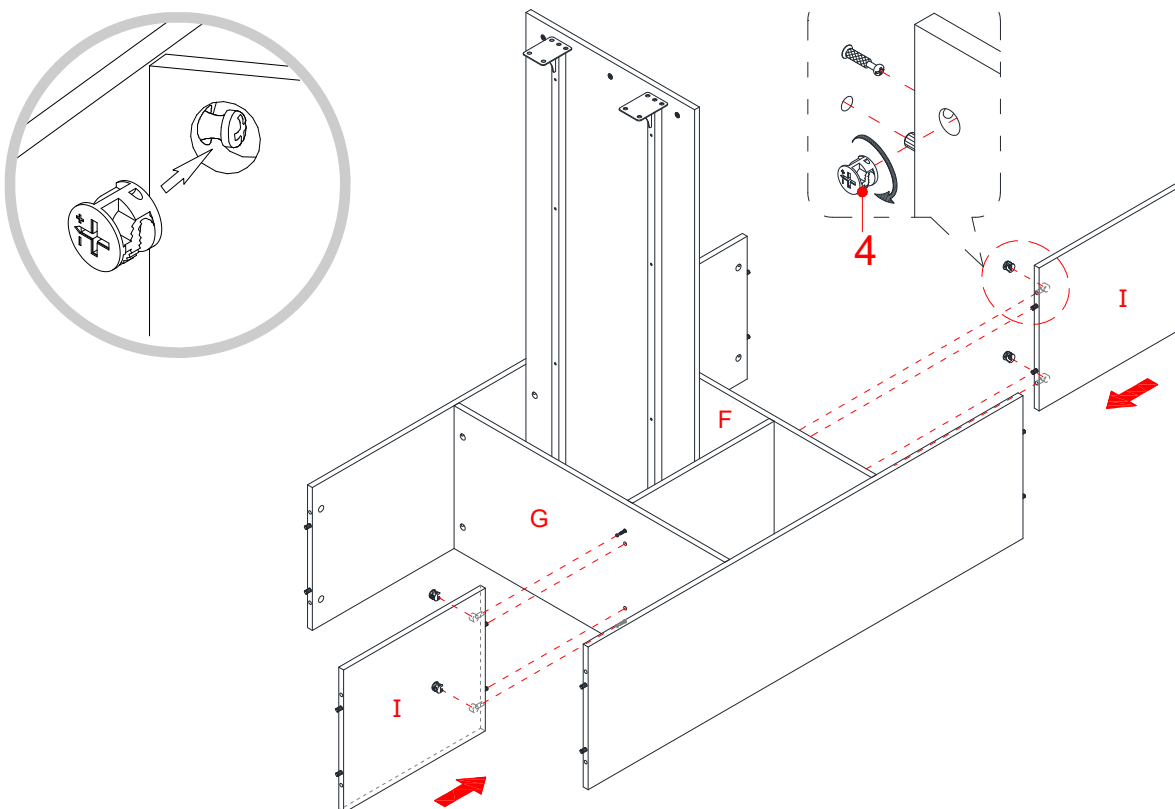

15. Align and attach the Upper/Lower Partition Panels (I) to the assembled Shelves (F and G) respectively by engaging two Cam Locks (4) per panel.

Assembly Instructions

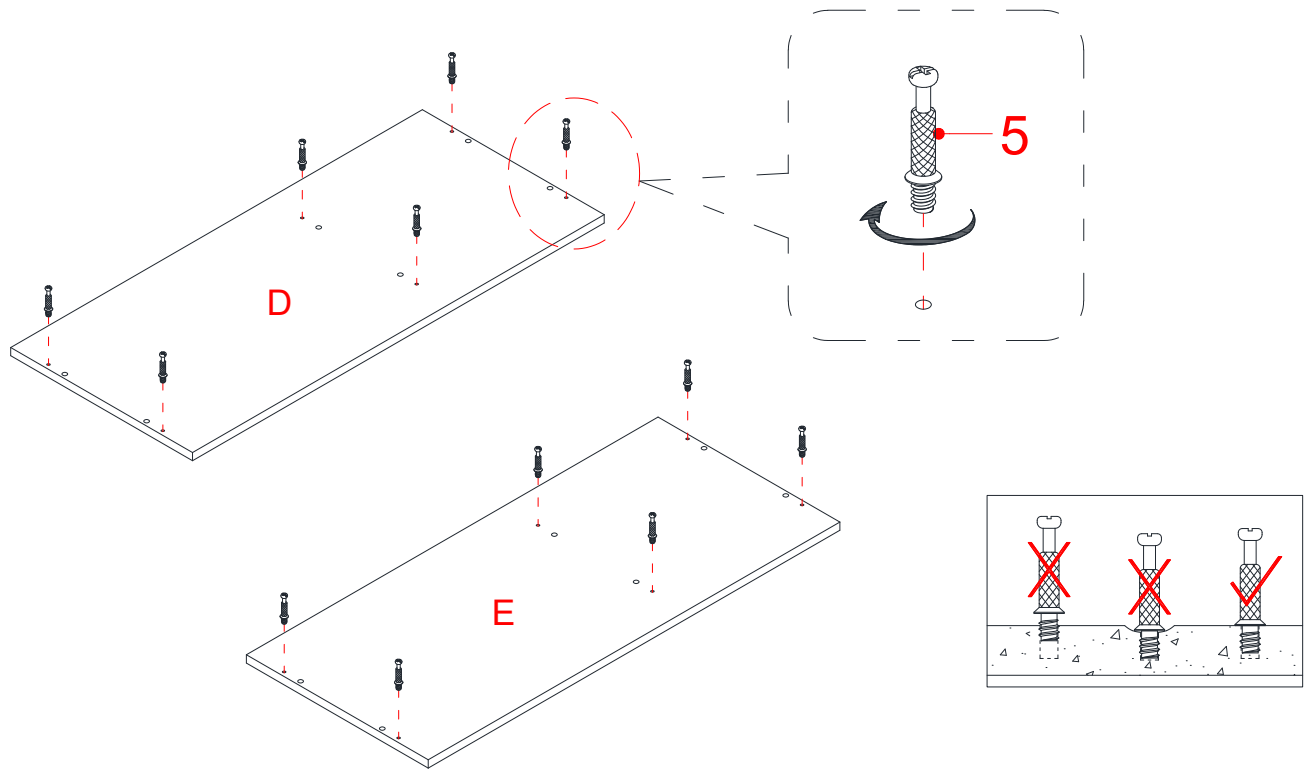

16. Securely screw the Cam Bolts (5) into the designated small holes on the Panels (D and E) using a Phillips screwdriver.

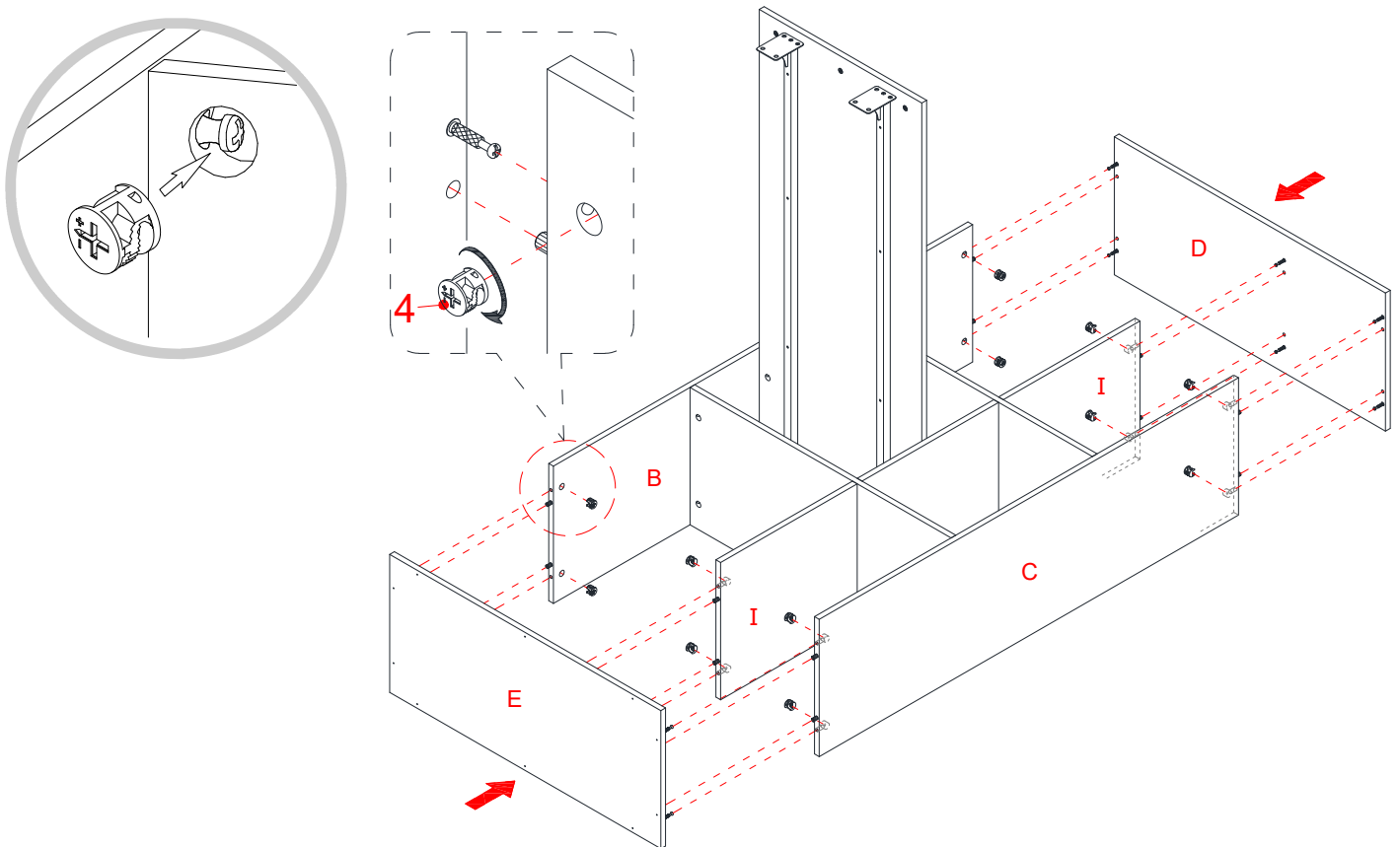

17. Align the large holes on Bookcase Top and Bottom Panels (D and E) with the inserted wood dowels (6) and press them together. Attach them into place by engaging twelve Cam Locks (4).

Assembly Instructions

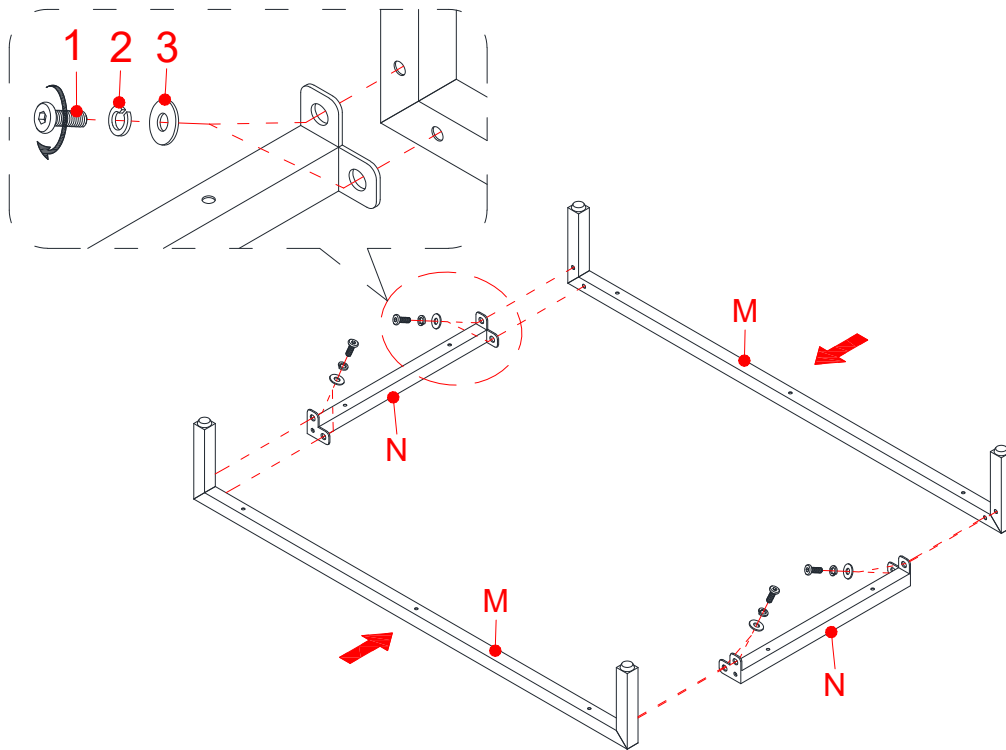

18. Attach two Base Short Supports (N) between the Base Long Supports (M) with eight 12 mm Bolts (1) and eight Washers (2 and 3).

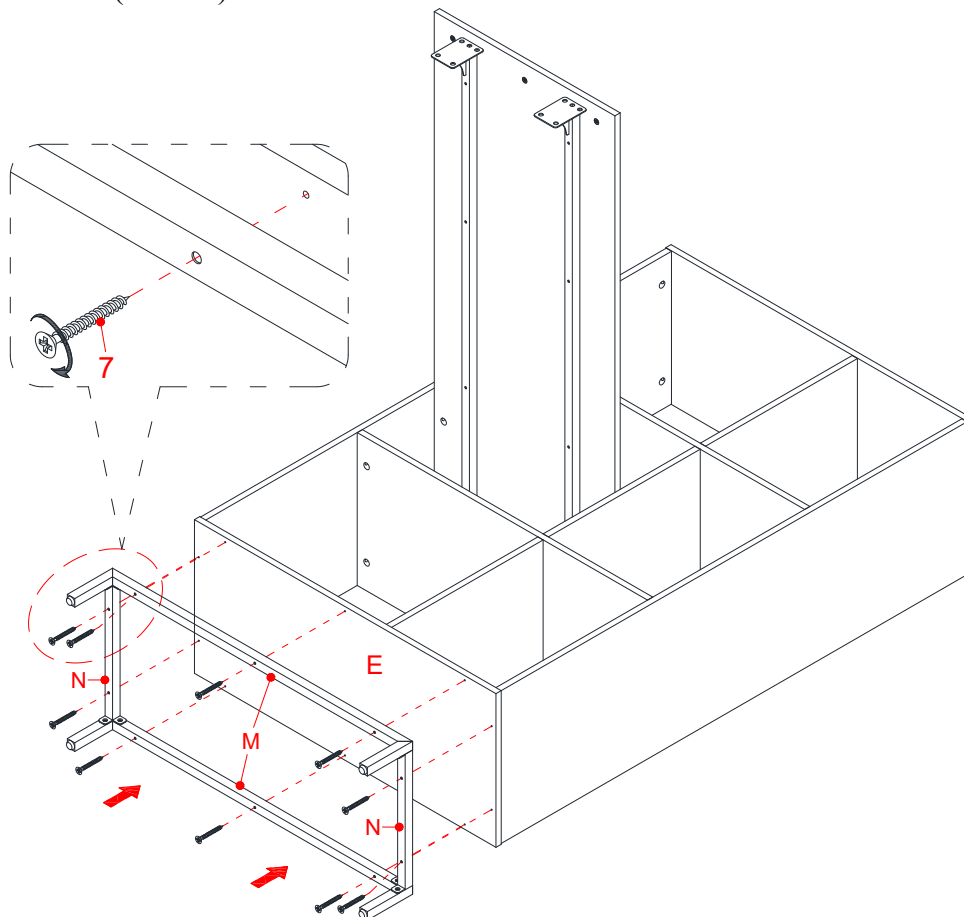

19. Using the pilot holes as a guide, align and attach the assembled Base to the Bookcase Bottom Panel (E) with ten 32 mm Screws (7).

Assembly Instructions

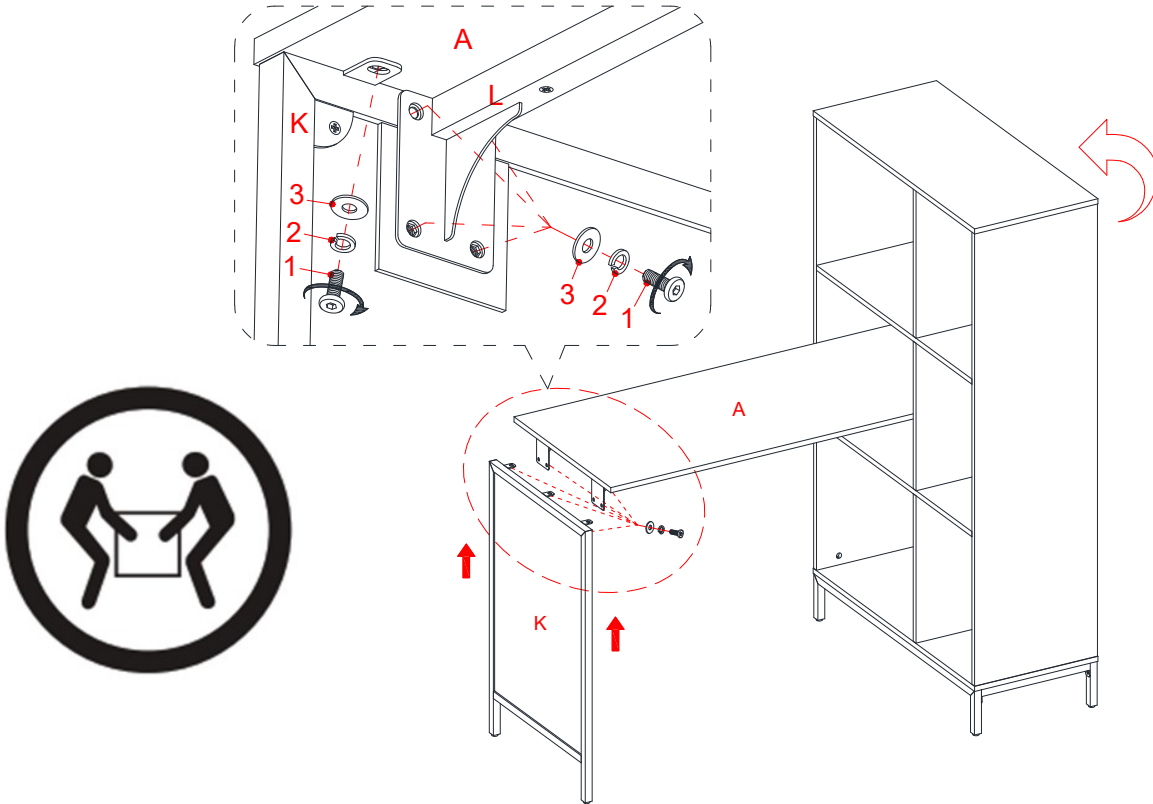

20. Ask for assistance to stand the assembled unit upright.

21. Attach the Desk Side Frame (K) to the Desk Top (A) with eleven 12 mm Bolts (1) and eleven Washers (2 and 3).

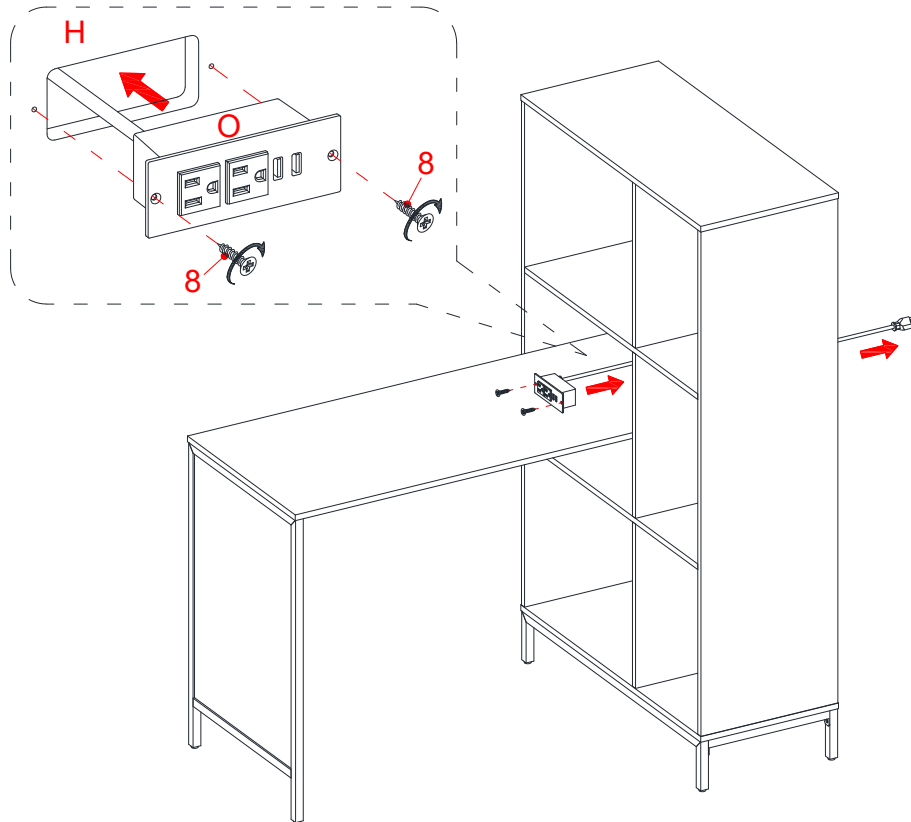

22. Feed the wire of Power Center (O) through the cutout on the Back Panel (H) and push into the cutout. Make sure the wire is not pinched. Secure it into place with two 12 mm Screws (8).

Assembly Instructions

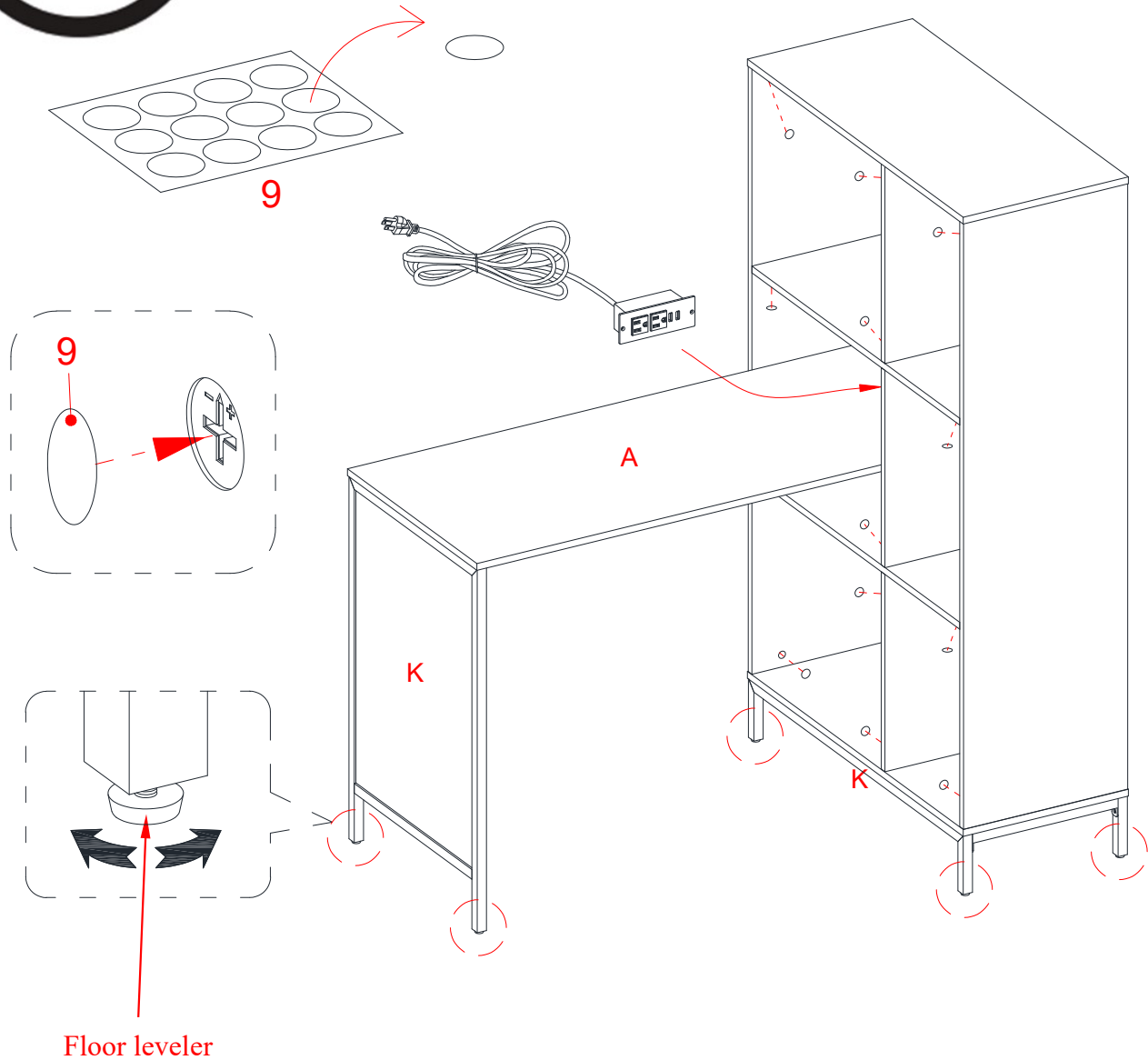

23. Cover the visible cam locks with the PVC Covers (9) provided.

24. Position the unit at the desired location against a wall. If necessary, adjust the pre-attached floor levelers at the bottom of the Desk Side Frame (K) and Base Supports (M) to level the unit.

25. The unit is now ready for use.

Care and Maintenance

- Use a soft, clean cloth that will not scratch the surface when dusting.
- Use of furniture polish is not necessary. Should you choose to use polish, test first in an inconspicuous area.
- Using solvents of any kind on your furniture may damage the finish.
- Never use water to clean your furniture as it may cause damage to the finish.
- Always use coasters under beverage glasses and flowerpots.
- Liquid spills should be removed immediately. Using a soft, clean cloth, blot the spill gently. Avoid rubbing.
- Always use protective pads under hot dishes and plates. Heat can cause chemical changes that may create spotting within the furniture finish.
- In the event that your furniture is stained or otherwise damaged during use, we recommend that you call a professional to repair your furniture.
- Check bolts/screws periodically and tighten them if necessary.

Further advice about wood furniture care

It is best to keep your furniture in a climate-controlled environment. Extreme temperature and humidity changes can cause fading, warping, shrinking and splitting of wood. It is advised to keep furniture away from direct sunlight as sun may damage the finish.

Proper care and cleaning at home will extend the life of your purchase. Following these important and helpful tips will enhance your furniture as it ages.

We hope you enjoy your purchase for many years.
Thank you for your purchase!

QUALITY GUARANTEE

We are confident that you will be delighted with your Whalen Furniture purchase.

Should this product be defective in workmanship or materials or fail under normal use, we will repair or replace it for up to one (1) year from date of purchase. Every Whalen Furniture product is designed to meet your highest expectations. We guarantee that you will immediately see the value of our fine furniture.

This warranty gives you specific legal rights and you may also have other rights which vary from state to state or province to province.

Whalen Furniture Manufacturing
1578 Air Wing Road, San Diego CA, 92154, USA
Customer Service: 866-942-5362
8:30 a.m. - 4:30 p.m., PST, Monday to Friday
www.whalenfurniture.com