

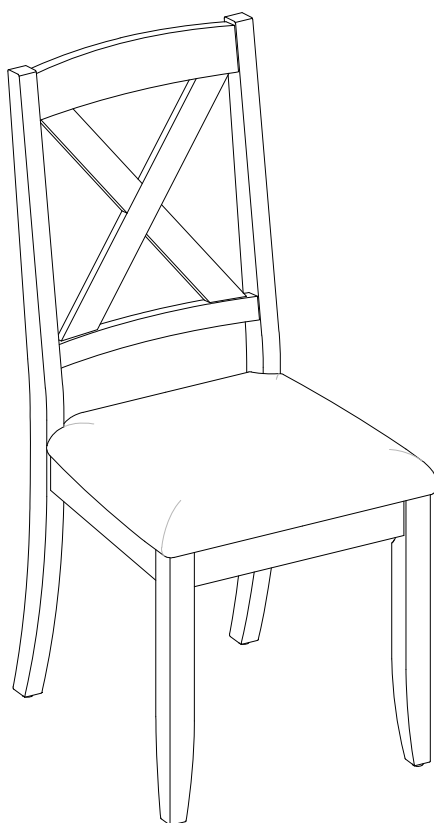

LOT NUMBER: _____
DATE OF PURCHASE: __/__/__

Evans Creek 2-pk Dining Chairs Model # CTCDC-1



ADULT ASSEMBLY REQUIRED

If you have any questions regarding assembly or if parts are missing, **DO NOT** return this item to the store where it was purchased. Please call our customer service number and have your instructions and parts list ready to provide the model name, part name or factory number:

1-866-942-5362

Pacific Standard Time: 8:30 a.m. - 4:30 p.m., Monday - Friday

Or visit our web site 24 hours a day, 7 days a week for product assistance at

www.whalenfurniture.com

Or e-mail your request to **parts@whalenfurniture.com**

**THIS INSTRUCTION BOOKLET CONTAINS IMPORTANT SAFETY INFORMATION.
PLEASE READ AND KEEP FOR FUTURE REFERENCE.**

QUALITY GUARANTEE

We are confident that you will be delighted with your Whalen Furniture purchase.

Should this product be defective in workmanship or materials or fail under normal use, we will repair or replace it for up to one (1) year from date of purchase. Every Whalen Furniture product is designed to meet your highest expectations. We guarantee that you will immediately see the value of our fine furniture.

This warranty gives you specific legal rights and you may also have other rights which vary from province to province (state to state).

Customer Service: 1-866-942-5362

8:30 a.m. - 4:30 p.m., PST, Monday to Friday

www.whalenfurniture.com

MAXIMUM RECOMMENDED WEIGHT LOADS

1. Maximum load weight 136 kg (300 pounds).



WARNING THIS UNIT IS INTENDED ONLY FOR USE WITHIN THE MAXIMUM WEIGHTS INDICATED. USE WITH LOAD HEAVIER THAN THE MAXIMUM WEIGHTS INDICATED MAY RESULT IN INSTABILITY, CAUSING POSSIBLE INJURY.

GENERAL INFORMATION, TIPS & TRICKS

1. Please read the Assembly Instructions prior to assembling the unit.
2. To avoid damage, assemble the unit on a sturdy, level and non-abrasive surface.
3. Keep all hardware and parts out of the reach of children.
4. Please wait until all steps are completed before fully tightening bolts.
5. Make sure all nuts, bolts and screws are tightly fastened before the unit is used.
6. Check that all bolts and screws are tight at least every 3 months or as needed.

Please call for replacement parts or assistance: 1-866-942-5362

Parts and Hardware List

Please read completely through the instructions and verify that all listed parts and hardware are present before beginning assembly.

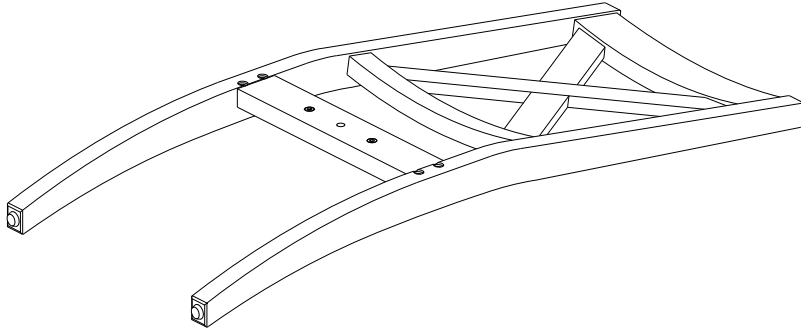

A- Chair Backrest (2)

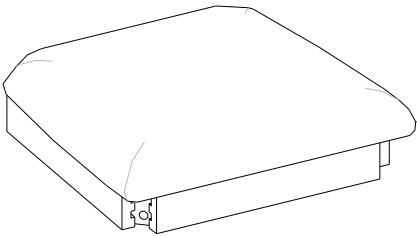

B- Seat Frame with Cushion (2)

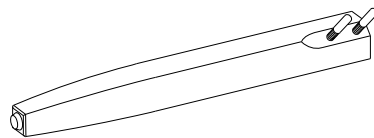

C- Front Leg (4)

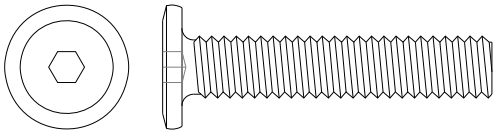

(1) M8 x 40 mm Bolt (4+1 extra)

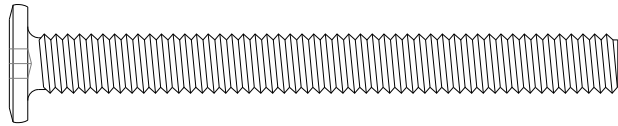

(2) M8 x 80 mm Bolt (8+1 extra)

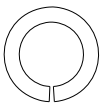

(3) Lock Washer
(20+1 extra)

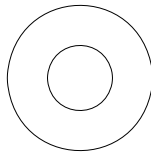

(4) Flat Washer
(20+1 extra)

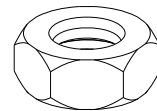

(5) M8 Hex Nut
(8+1 extra)

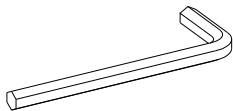

4 mm Allen Wrench (1)

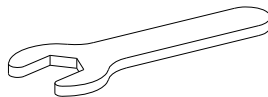

Open Wrench (1)

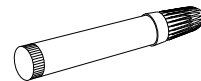

Touch-up Pen (1)

Tools required: Allen wrench and open wrench (provided).

Please call for replacement parts or assistance: 1-866-942-5362

Whalen Furniture Manufacturing

Page 3

Factory # 15197

Assembly Instructions

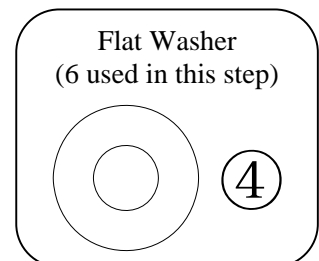
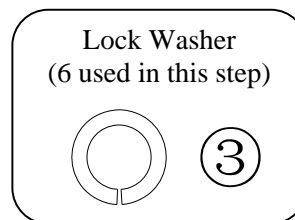
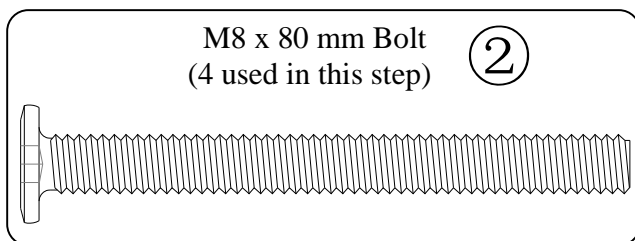
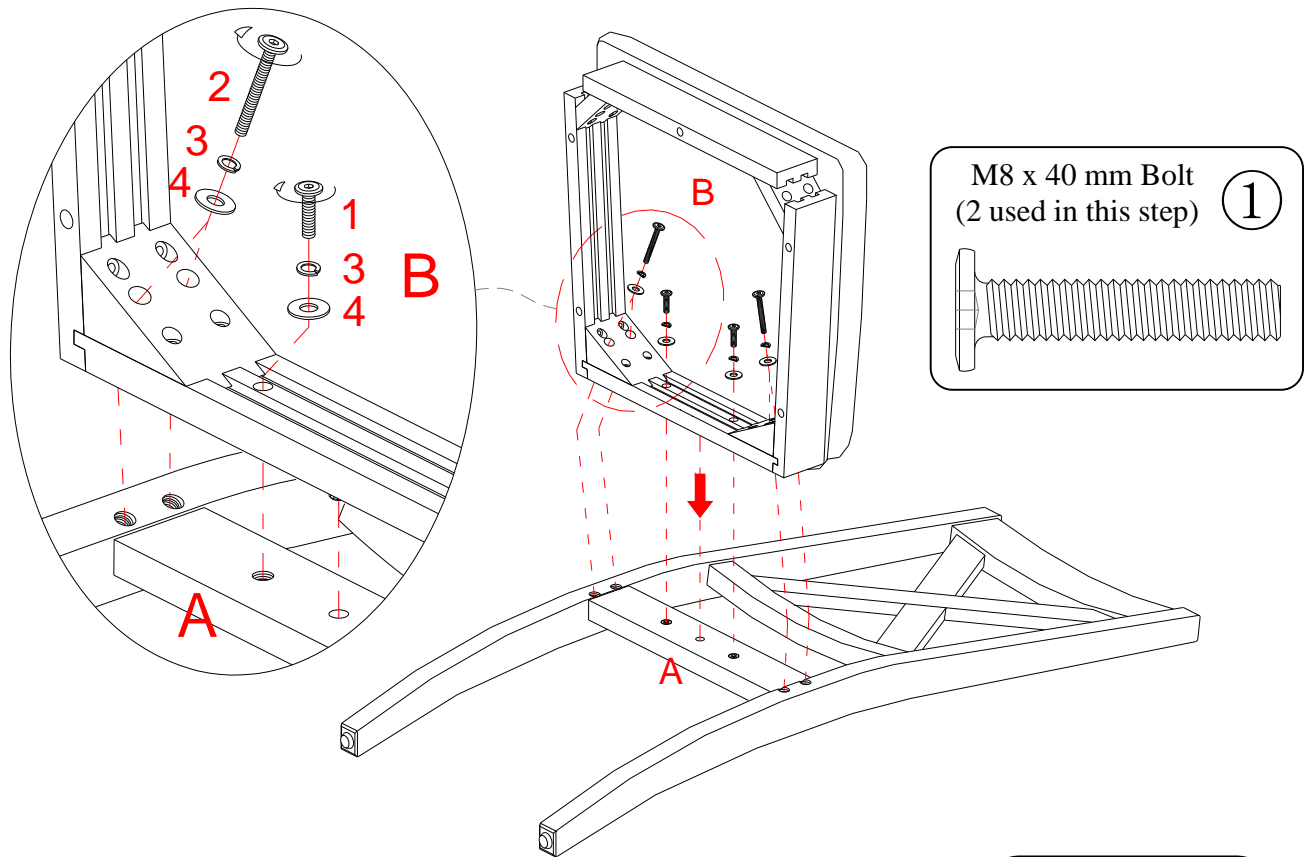

⚠ WARNING

DO NOT fully tighten the bolts or nuts initially until all the bolts or nuts are ready to assemble. To avoid causing damages to the thread, DO NOT over-tighten the nuts or bolts.

1. Unpack the unit and confirm that you have all the hardware and required parts.
2. Lay one Chair Backrest (A) on a smooth and protective surface with the threaded holes facing up.
3. Attach one Seat Frame (B) to the Chair Backrest (A) with the end dowel fully inserted. Make sure the Seat Cushion will face up when the unit is turned upright. Insert the 80 mm Bolts (2) with Lock Washers (3) and Flat Washers (4) through the drilled holes on the seat frame at rear corner blocks and loosely tighten into the threaded inserts on the Backrest (A). As shown.
4. Secure the Seat Frame (B) to the Chair Backrest (A) by inserting two 40 mm Bolts (1) with the Washers (3 and 4) through the drilled holes on the rear rail of Seat Frame. As shown.

NOTE: DO NOT fully tighten the bolts.

Please call for replacement parts or assistance: 1-866-942-5362

Whalen Furniture Manufacturing

Page 4

Factory # 15197

Assembly Instructions

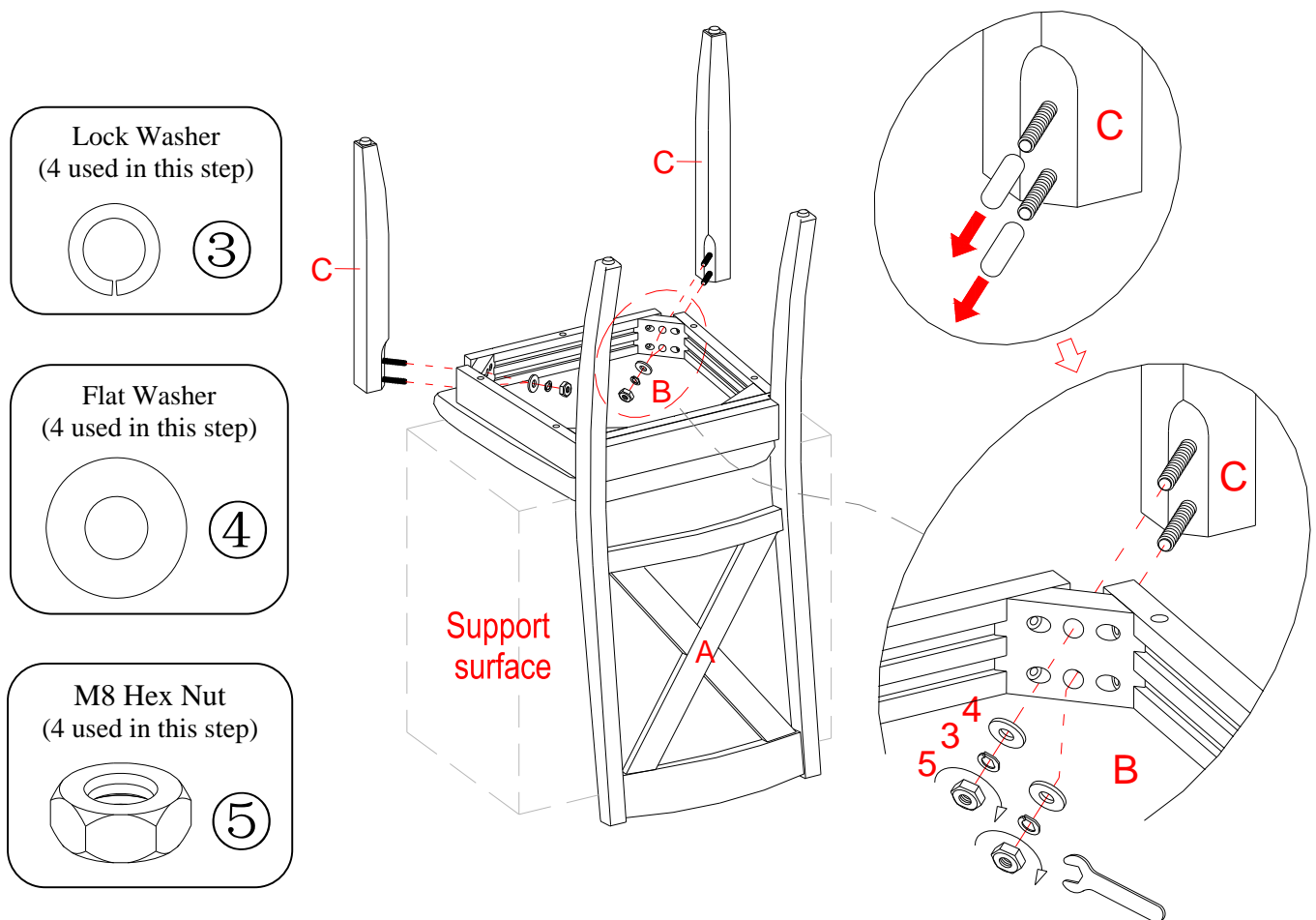

5. Flip last assembly upside down on a support surface. As shown.

NOTE: Place a protective cover (like the bubble wrap packing material) over the carton or other support surface to prevent from scratching.

6. Remove the plastic caps from the hanger bolts of Chair Front Legs (C). Attach 2 Front Legs (C) to the front corner blocks of the Seat Frame (B) by inserting the pre-attached hanger bolts through the drilled holes on corner blocks, and fit the Flat Washer (4), Lock Washer (3) and M8 Hex Nut (5) onto each hanger bolt. Tighten the Hex Nuts with the provided Open Wrench.

NOTE: DO NOT fully tighten all the nuts until the chair has been adjust and level all the legs so that they do not wobble. Once adjusted then go back and tighten while making sure that the unit remains level.

7. Stand the assembled chair upright on a flat surface. Press down the Seat (B) to even all legs. Now, tightly fasten all bolts and nuts with the provided Allen Wrench and Open Wrench.
8. Repeat the same process to assemble the other chair.

Please call for replacement parts or assistance: 1-866-942-5362

Care and Maintenance

- From time to time please ensure there are no loose nuts on the product.
- Use a soft, clean cloth that will not scratch the surface when dusting.
- Use of furniture polish is not necessary. Should you choose to use polish, test first in an inconspicuous area.
- Using solvents of any kind on your furniture may damage your furniture's finish.
- Never use water to clean your furniture as it may cause damage to the finish.
- Always use coasters under beverage glasses and flowerpots.
- Liquid spills should be removed immediately. Using a soft clean cloth, blot the spill gently. Avoid rubbing.
- Always use protective pads under hot dishes and plates. Heat can cause chemical changes that may create spotting within the furniture finish.
- Stains or marks from crayons or ink markers will be difficult to remove.
- In the event that your furniture is stained or otherwise damaged during use, we recommend that you call a professional to repair your furniture.
- Check bolts/screws periodically and tighten them if necessary.

Further advice about wood furniture care

It is best to keep your furniture in a climate-controlled environment. Extreme temperature and humidity changes can cause fading, warping, shrinking and splitting of wood. It is advised to keep furniture away from direct sunlight as sun may damage the finish.

Proper care and cleaning at home will extend the life of your purchase. Following these important and helpful tips will enhance your furniture as it ages.

A Touch-up Pen has been provided to repair any small nicks or scratches that may occur during assembly or shipping.

We hope you enjoy your purchase for many years.
Thank you for your purchase!



Please call for replacement parts or assistance: 1-866-942-5362

Whalen Furniture Manufacturing

Page 6

Factory # 15197

IF YOU NEED TO ORDER ANY REPLACEMENT PARTS, PLEASE USE THE LIST BELOW
Evans Creek 2-pk Dining Chairs (CTCDC-1)

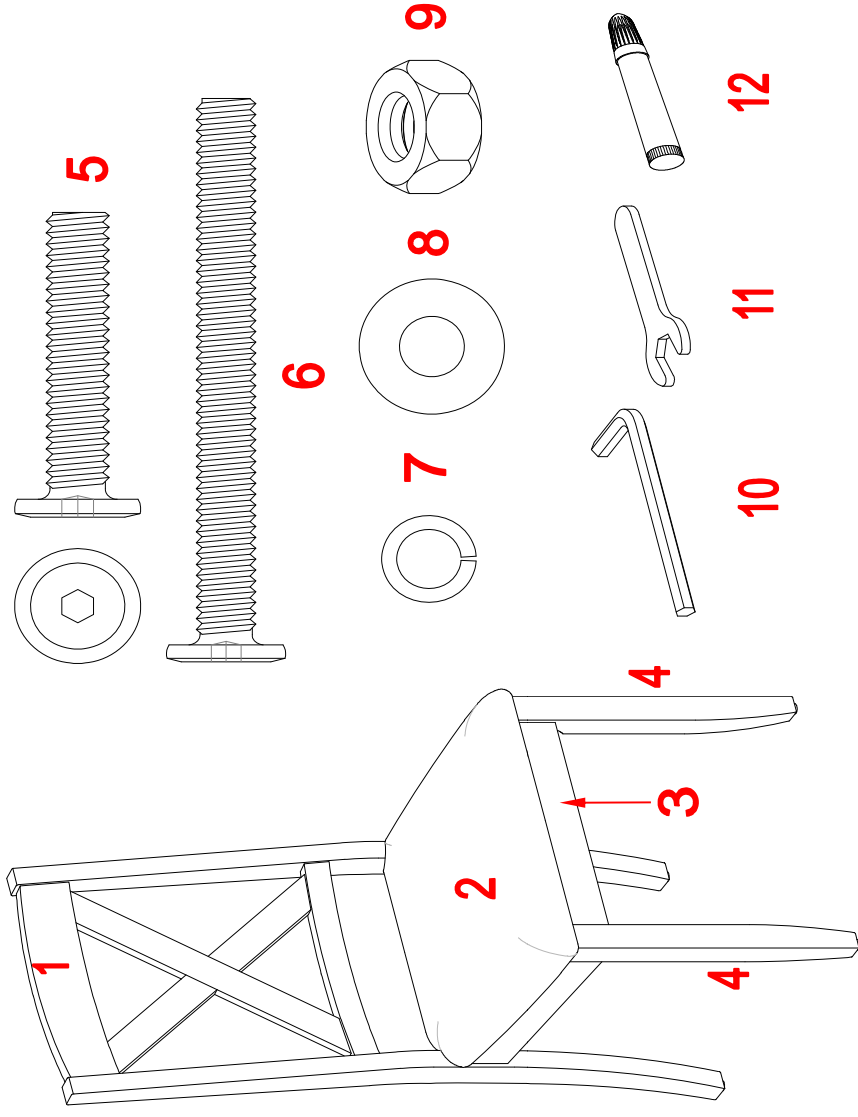

*CTCDC-1-1-CB	Chair Backrest	*CTCDC-1-8-FW	Flat Washer
*CTCDC-1-2-SC	Seat Cushion	*CTCDC-1-9-M8HN	M8 Hex Nut
*CTCDC-1-3-SF	Seat Frame	*CTCDC-1-10-AW	Allen Wrench
*CTCDC-1-4-FL	Front Leg	*CTCDC-1-11-OW	Open Wrench
*CTCDC-1-5-M8x40B	M8 x 40 mm Bolt	*CTCDC-1-12-TUP	Touch-up Pen
*CTCDC-1-6-M8x80B	M8 x 80 mm Bolt	*CTCDC-1-CH	Complete Hardware
*CTCDC-1-7-LW	Lock Washer		