



WHALEN®

LOT NUMBER: _____
DATE PURCHASED: __/__/__

Kitchen Cart

Model # BJKC

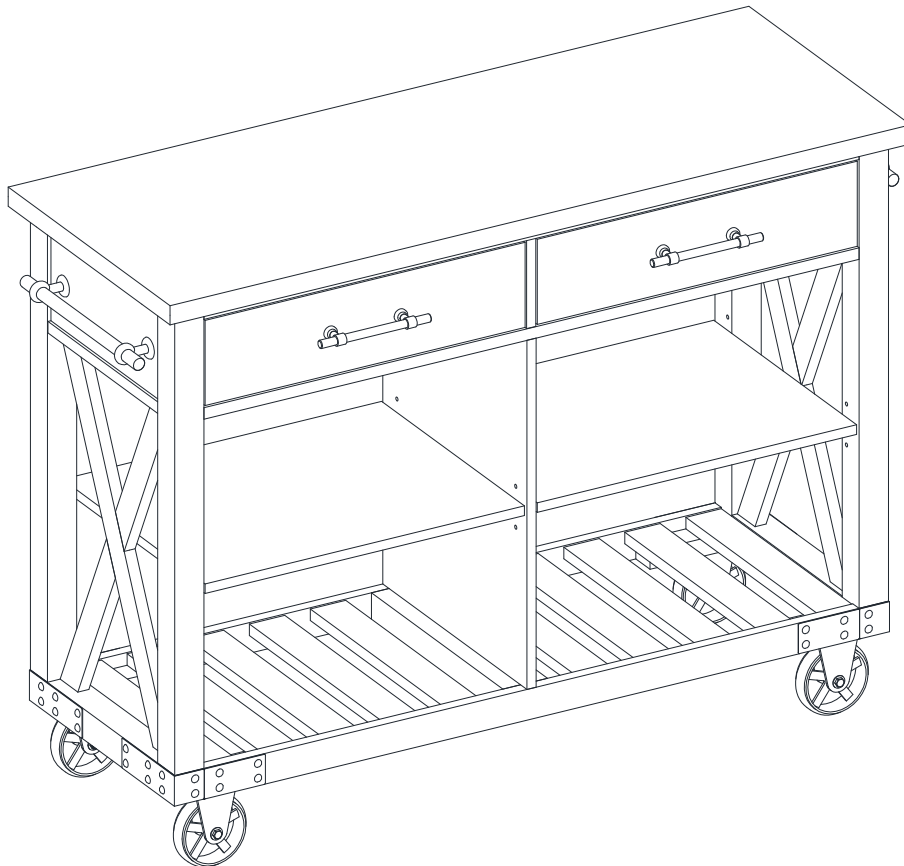

ADULT ASSEMBLY REQUIRED

If you have any questions regarding assembly or if parts are missing, DO NOT return this item to the store where it was purchased. Please call our toll-free customer service number and have your instructions and parts list ready to provide the model name, part name or factory number:

1-866-942-5362

Pacific Standard Time: 8:30 a.m. - 4:30 p.m., Monday to Friday

Or visit our website 24 hours a day, 7 days a week for product assistance at

www.whalenfurniture.com

Or e-mail your request to **parts@whalenfurniture.com**

**THIS INSTRUCTION BOOKLET CONTAINS IMPORTANT SAFETY INFORMATION.
PLEASE READ AND KEEP FOR FUTURE REFERENCE.**

Date 2020-10-09 Rev. 0001-A

MAXIMUM RECOMMENDED WEIGHT LOADS

MANUFACTURER: Whalen Furniture Manufacturing
CATALOG: Kitchen Cart
MODEL # BJKC

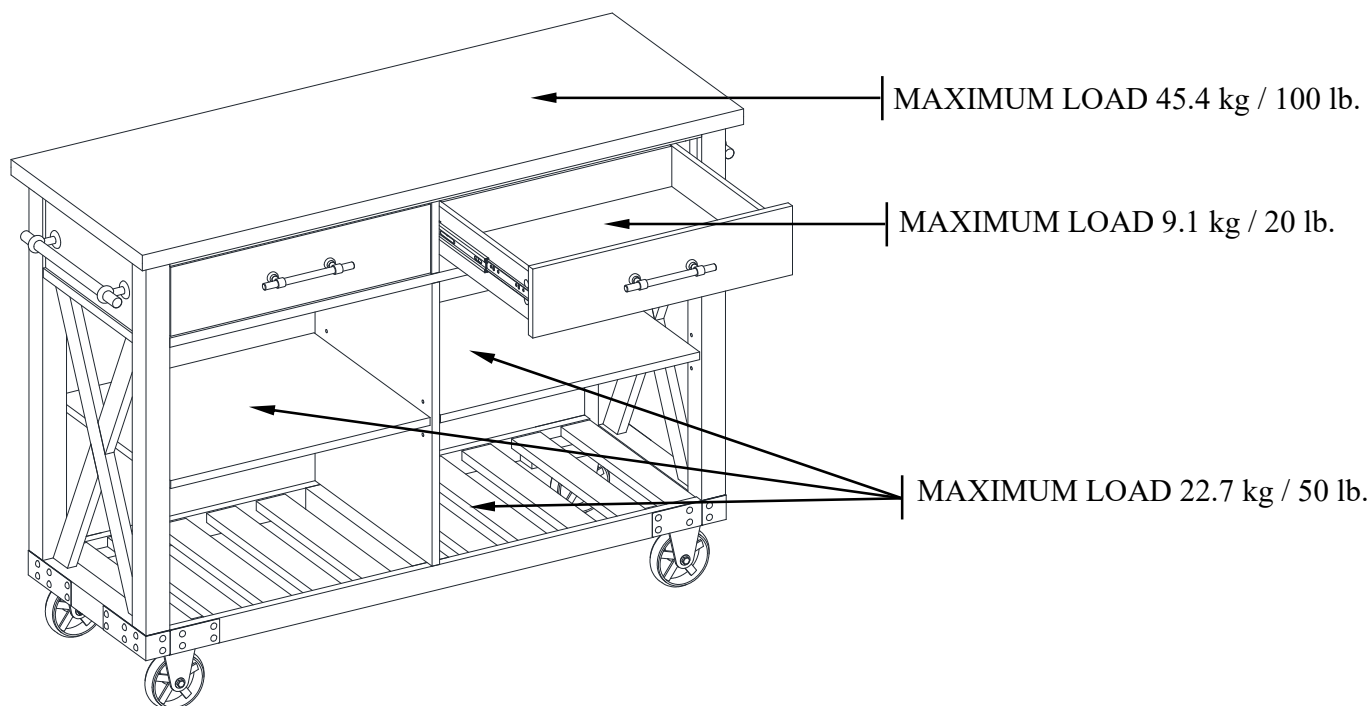

⚠ WARNING

THIS UNIT IS INTENDED ONLY FOR USE WITHIN THE MAXIMUM WEIGHTS INDICATED. USE WITH LOAD HEAVIER THAN THE MAXIMUM WEIGHTS INDICATED MAY RESULT IN INSTABILITY, CAUSING POSSIBLE INJURY.

⚠ WARNING



Children have died from furniture tipover.

To reduce the risk of furniture tipover:

- ALWAYS install tipover restraint provided.
- NEVER put a TV on this product.
- NEVER allow children to stand, climb or hang on drawers, doors, or shelves.
- NEVER open more than one drawer at a time.
- Place heaviest items in the lowest drawers.

Use of tip-over restraints may only reduce, but not eliminate, the risk of tip-over.



IMPORTANT

Before you begin: Open, identify and count all parts prior to assembly. Lay out parts on a flat and non-abrasive surface. You will need the parts identified on page 4 of this instruction manuals.

NOTE: IT IS VERY IMPORTANT TO USE GLUE WITH THE DOWELS. EXCESS GLUE CAN BE WIPED OFF WITH A DAMP CLOTH.

Insert Dowel at least half way by tapping lightly with a rubber mallet (not included), IF NECESSARY.

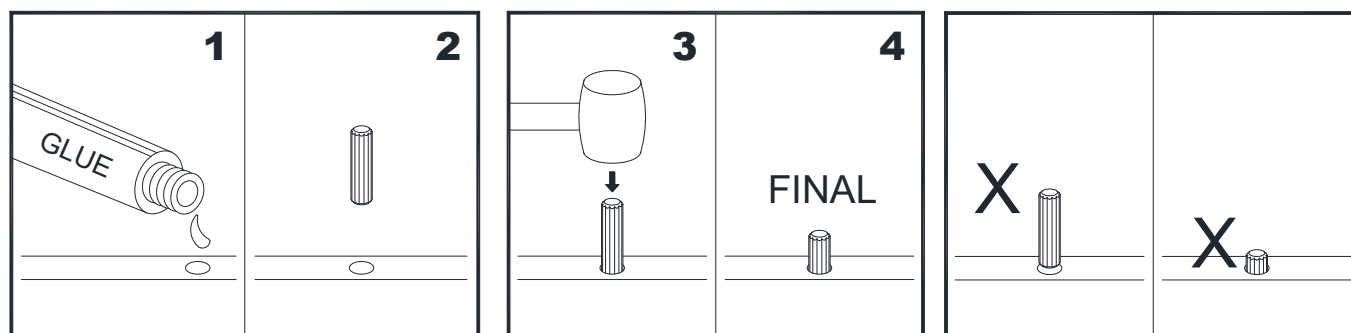

CAM LOCK SYSTEM OPERATION

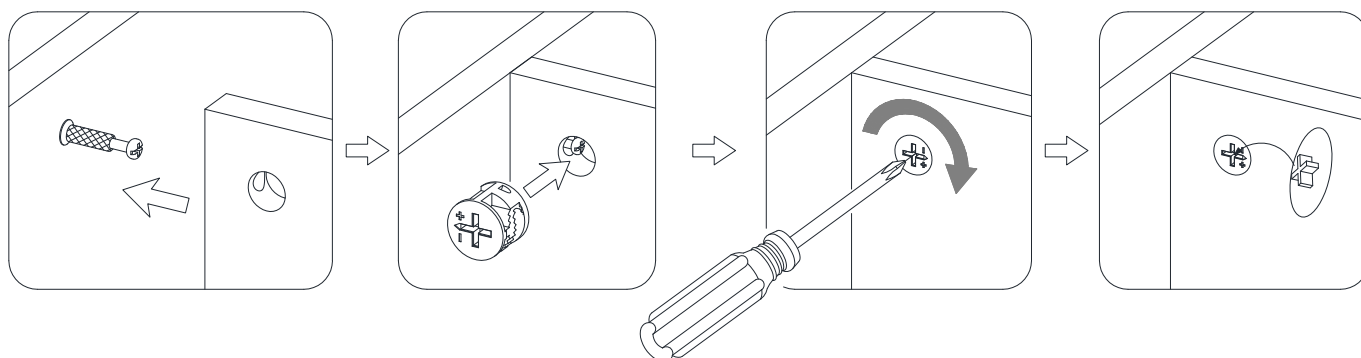

HOW THE KNOCK DOWN (KD) ASSEMBLY SYSTEM WORKS

1. Screw the Cam Bolt into the pre-drilled small holes on the panel. Connect both panels together; making sure the Cam Bolt goes into the pre-drilled hole at the end of the panel with the Cam Lock.
2. Insert the Cam Lock into the pre-drilled large hole in the panel. Make sure the arrow on the Cam Lock is pointed towards the Cam Bolt.
3. Once the Cam Bolt is connected inside the Cam Lock, take a Phillips screwdriver (not included) and tighten the Cam Lock clockwise.
4. Plug the Cam Lock Cover into the cross slot of the Cam Locks to conceal the cam.

You are now ready to assemble the KD unit.

Parts and Hardware List

Please read completely through the instructions and verify that all listed parts and hardware are present before beginning assembly.

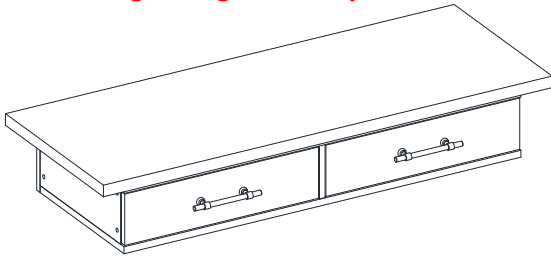

A- Top Section (Qty. 1)

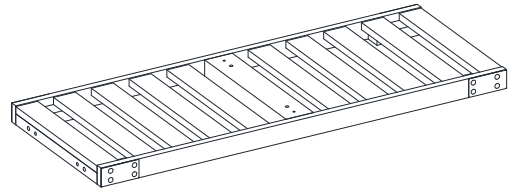

B- Bottom Shelf (Qty. 1)

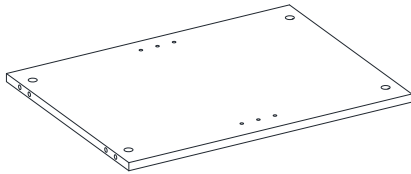

C- Partition Panel (Qty. 1)

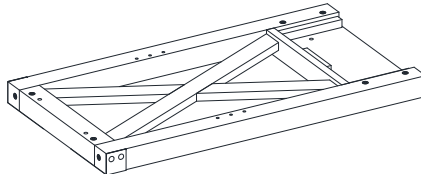

D- Side Frame (Qty. 2)

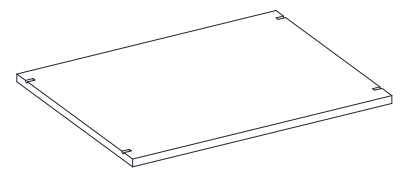

E- Adjustable Shelf (Qty. 2)

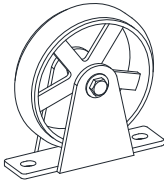

F- Caster
(Qty. 4)

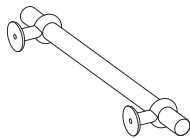

G- Side Handle
(Qty. 2)

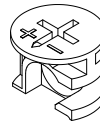

(1) Cam Lock
(Qty. 4+1 extra)

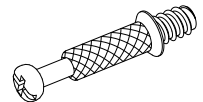

(2) Cam Bolt
(Qty. 4+1 extra)

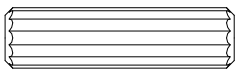

(3) M8 x 30 mm Wood Dowel
(Qty. 8+1 extra)

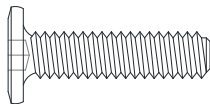

(4) 1/4" x 25 mm Bolt
(Qty. 8+1 extra)

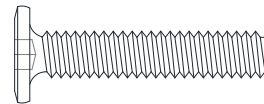

(5) 1/4" x 32 mm Bolt
(Qty. 4+1 extra)

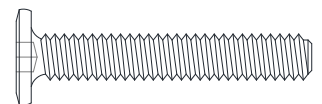

(6) 1/4" x 38 mm Bolt
(Qty. 12+1 extra)



(7) Lock Washer
(Qty. 24+1 extra)

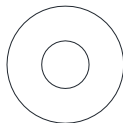

(8) Flat Washer
(Qty. 24+1 extra)

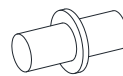

(9) Shelf Pin
(Qty. 8+1 extra)

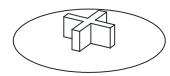

(10) Cam Lock Cover
(Qty. 4+1 extra)



Hex Wrench
(Qty. 1)

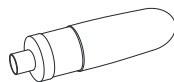

Glue
(Qty. 1)

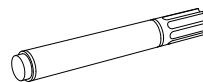

Touch-up Pen
(Qty. 1)

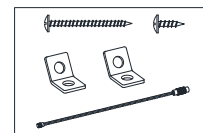

Tipping Restraint Hardware Kit (Qty. 2)
(Included in plastic bag)

Tools required (not included): Phillips screwdriver, stud finder, power drill, pencil, tape measure, and 1/8" drill bit.

Assembly Instructions

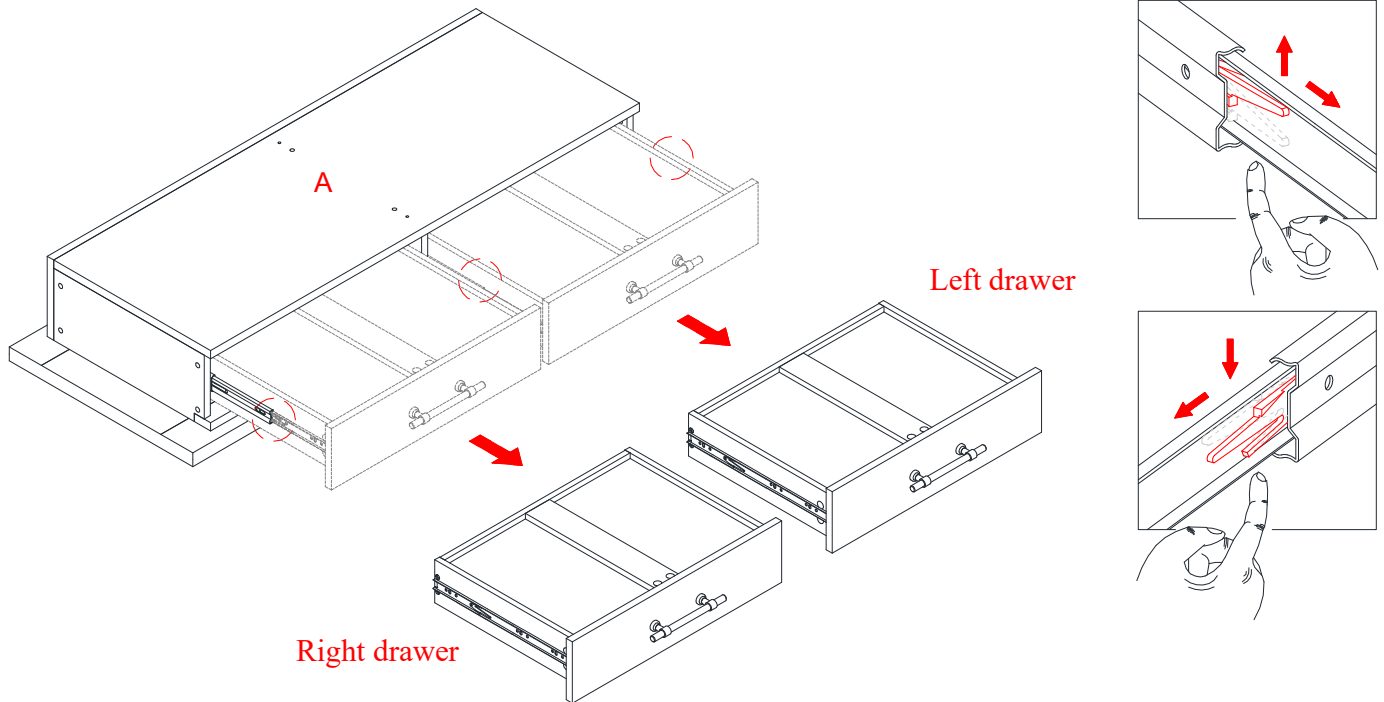

NOTE: DO NOT fully tighten all cam locks and bolts until you finish assembling all parts. Once assembled, go back and fully tighten all cam locks and bolts.

1. Unpack the unit and confirm that you have all the hardware and required parts.
2. Place the Top Section (A) upside down on a level and protective surface as shown.
3. Remove the drawers by pulling the drawer all the way out, then simultaneously pushes the plastic release lever of the ball bearing slide up on one side and down on the other side, and then pull the drawer completely out.

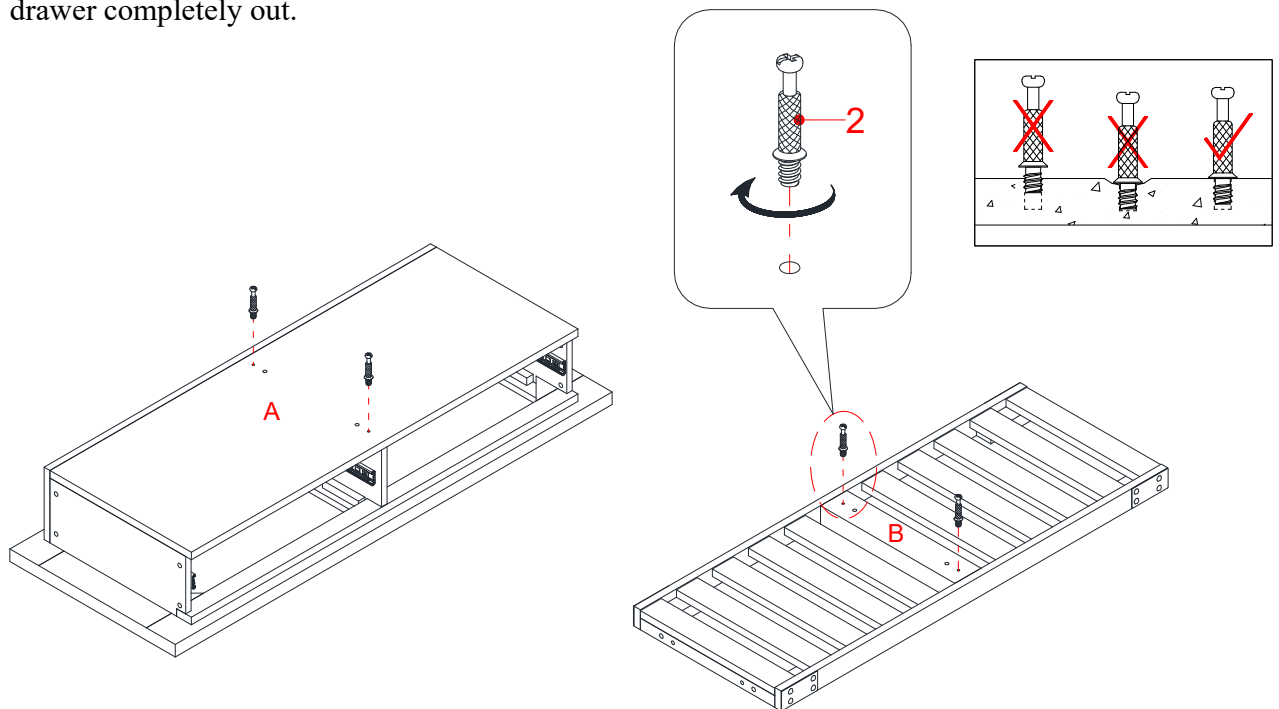

4. Securely screw the Cam Bolts (2) into the designated small holes on the Top Section (A) and Bottom Shelf (B) with a Phillips screwdriver.

NOTE: Screw-in cam bolts must be screwed down flush.

Assembly Instructions

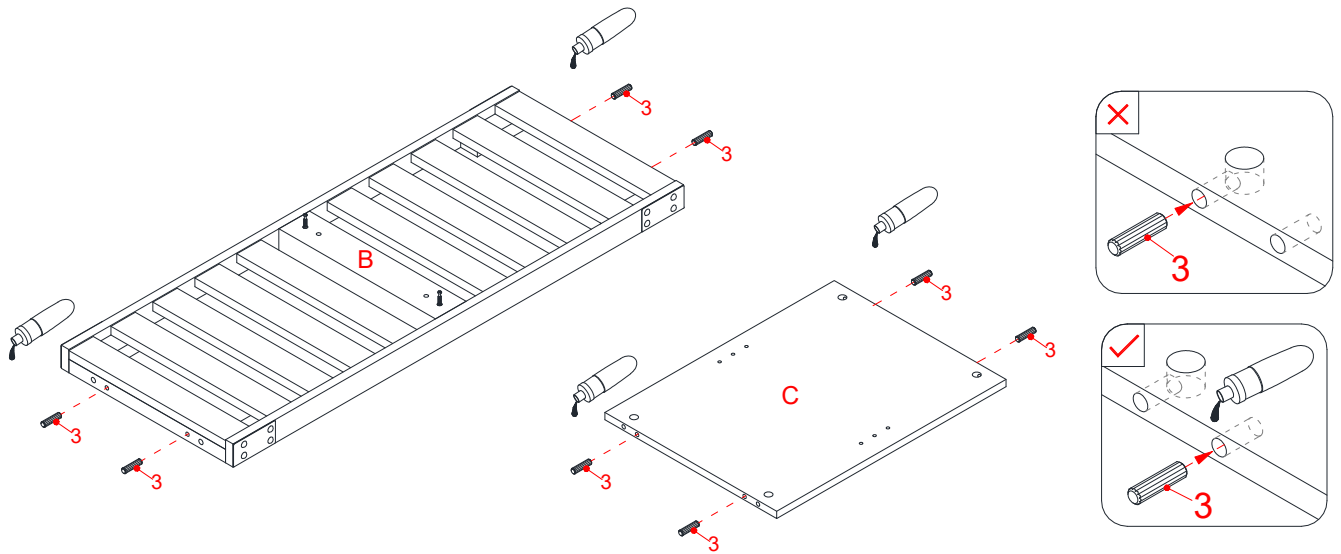

5. Glue the Wood Dowels (3) into the inner holes on the Bottom Shelf (B) and Partition Panel (C) as shown.

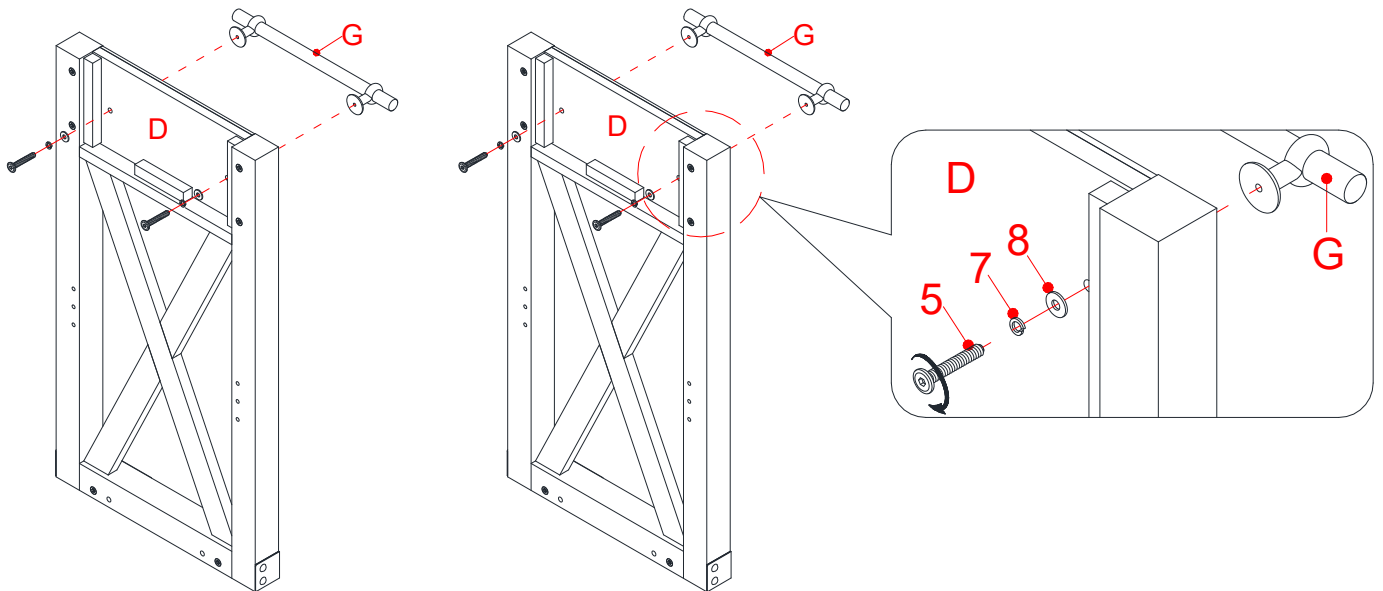

6. Attach the Side Handles (G) to the Side Frames (D) using four 32 mm Bolts (5) with the Lock Washers (7) and Flat Washers (8).

Assembly Instructions

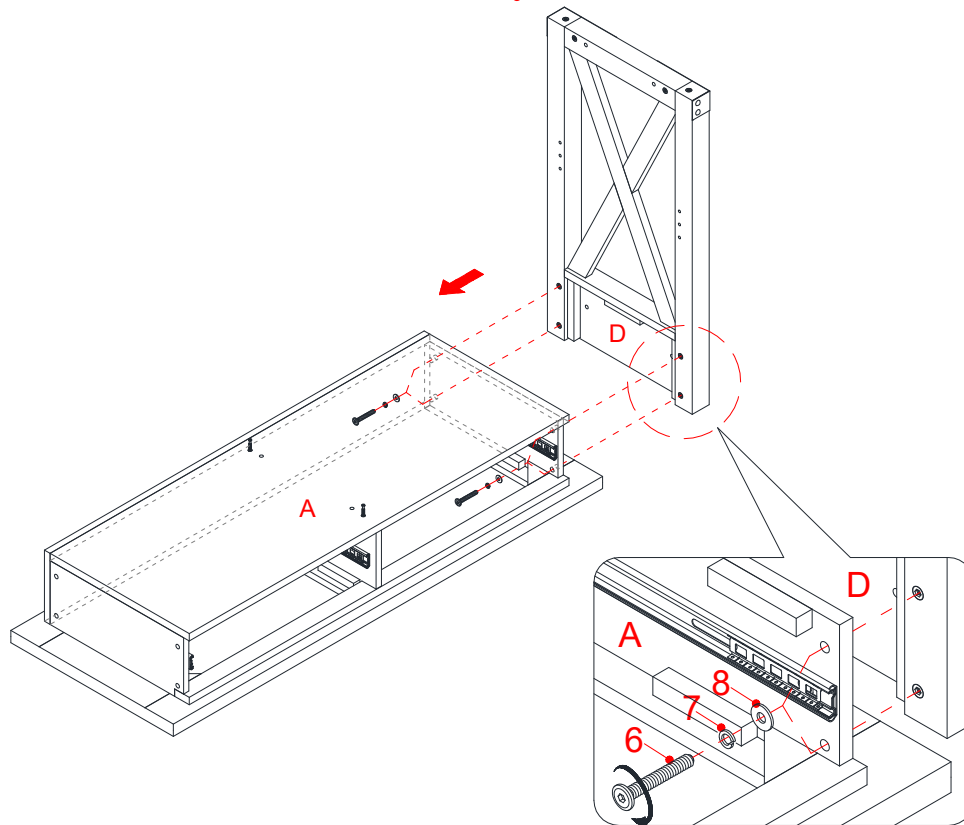

7. Attach one Side Frame (D) to the Top Section (A) with four 38 mm Bolts (6) and eight Washers (7 and 8).

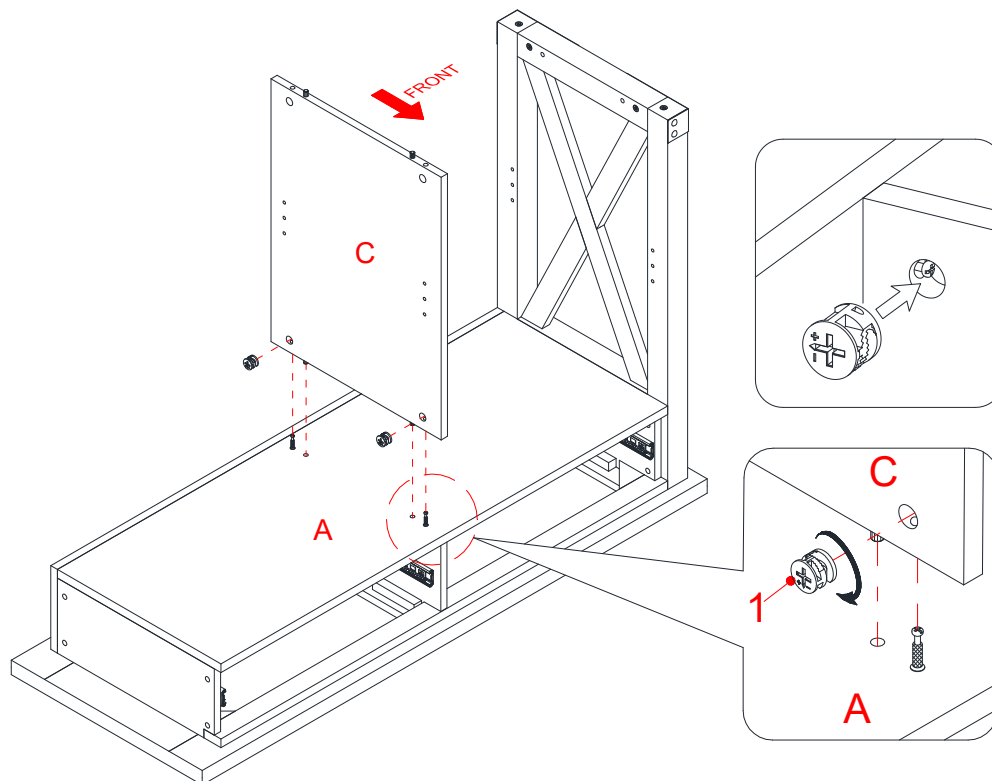

8. Attach the Partition Panel (C) to the Top Section (A) by engaging two Cam Locks (1). Make sure that the cam locks point towards the right side of the unit. (Refer to page 3 on Cam Lock system operation supplement).

Assembly Instructions

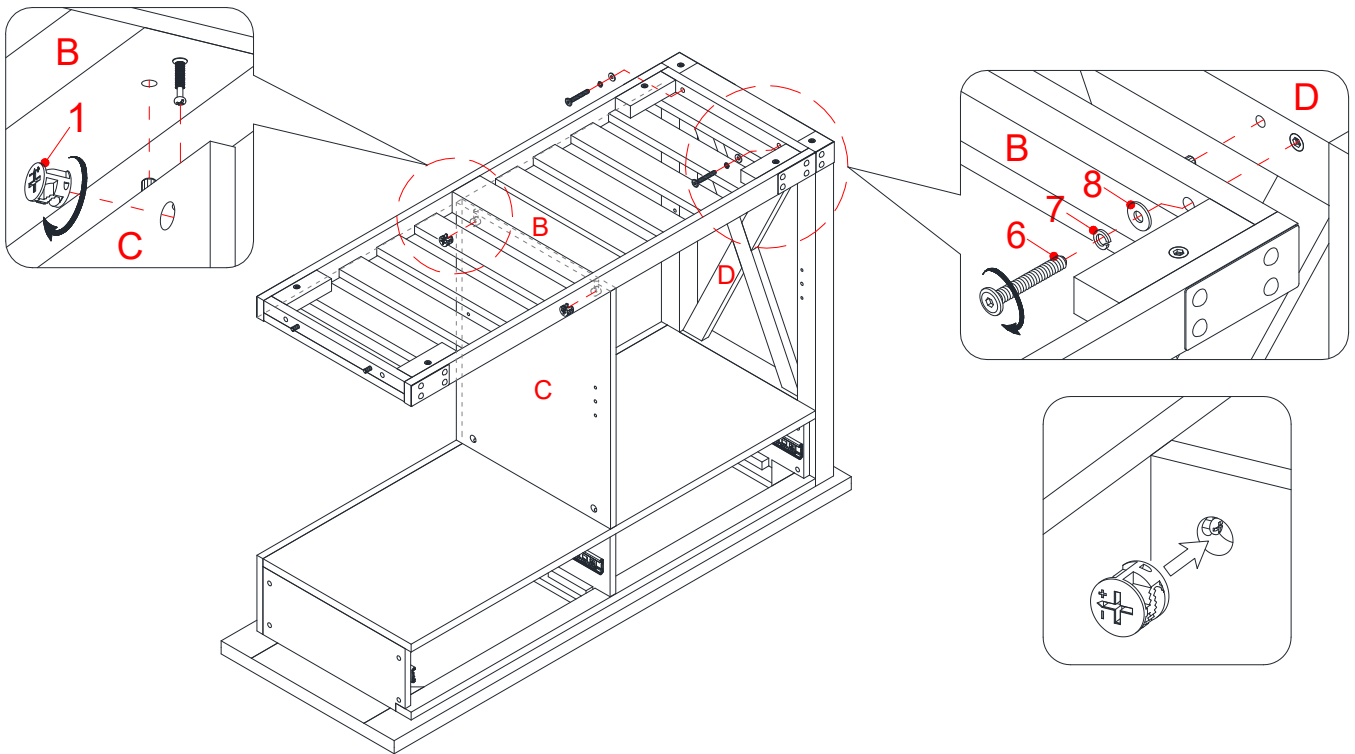

9. Align and attach the Bottom Shelf (B) to the Partition Panel (C) by engaging two Cam locks (1).
10. Continue to fasten the Bottom Shelf (B) to the Side Frame (D) using two 38 mm Bolts (6) with the Washers (7 and 8).

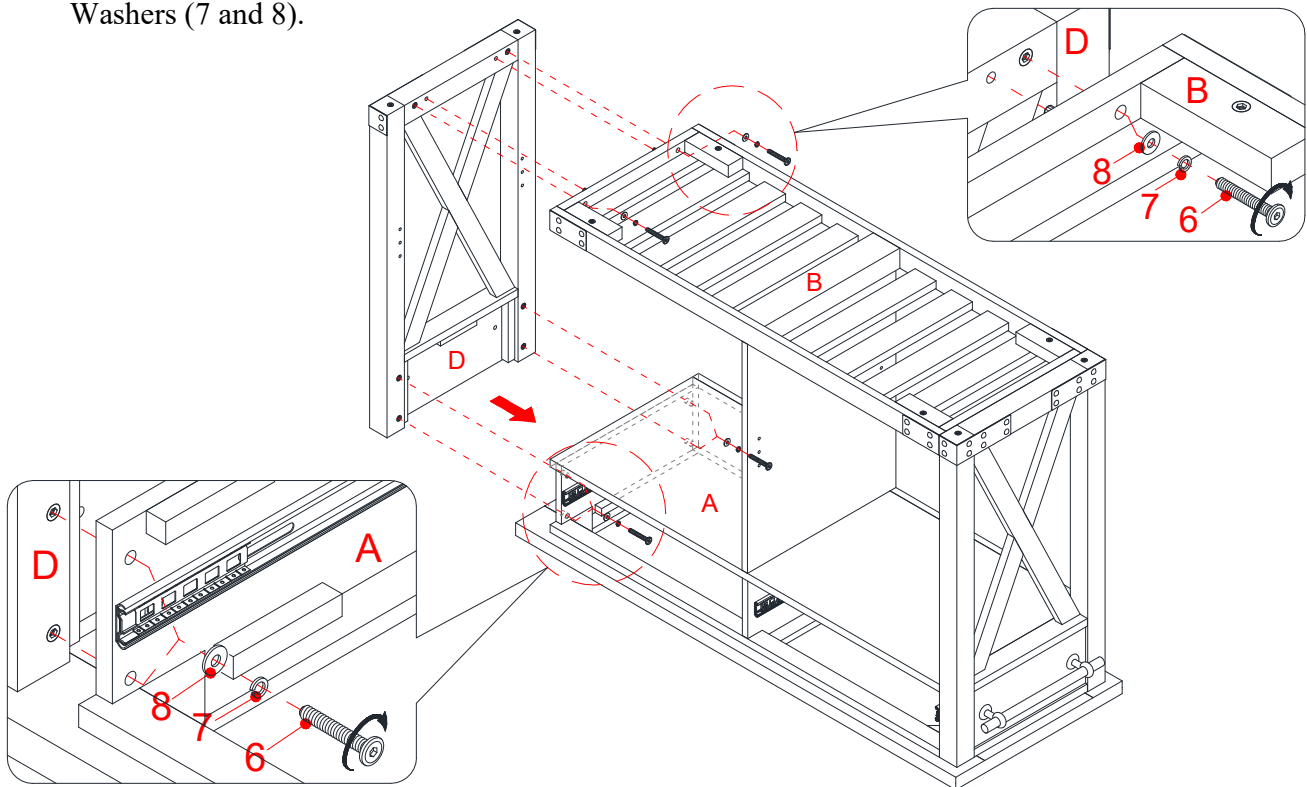

11. Attach the other Side Frame (D) to the Top Section (A) and Bottom Shelf (B) with six 38 mm Bolts (6) and Washers (7 and 8).

Assembly Instructions

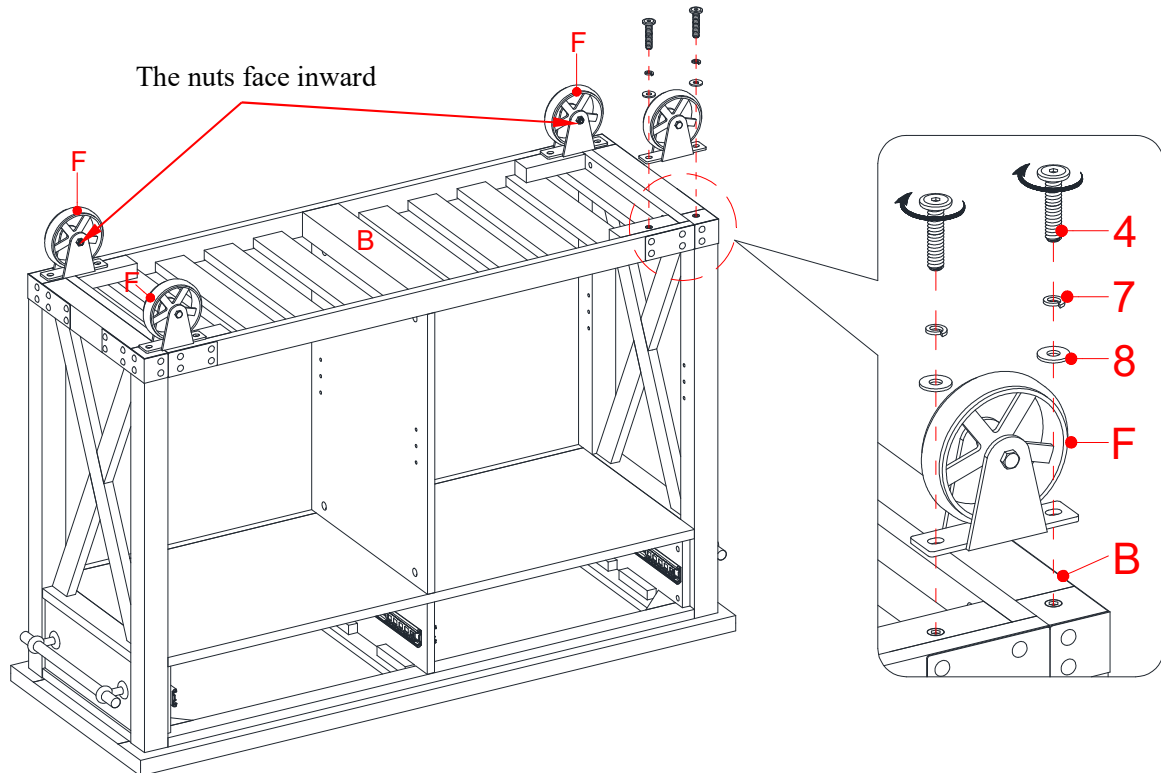

12. Fasten the Casters (F) to the joint between the Bottom Shelf (B) and Side Frames (D) with two 25 mm Bolts (4) and four Washers (7 and 8) per caster.

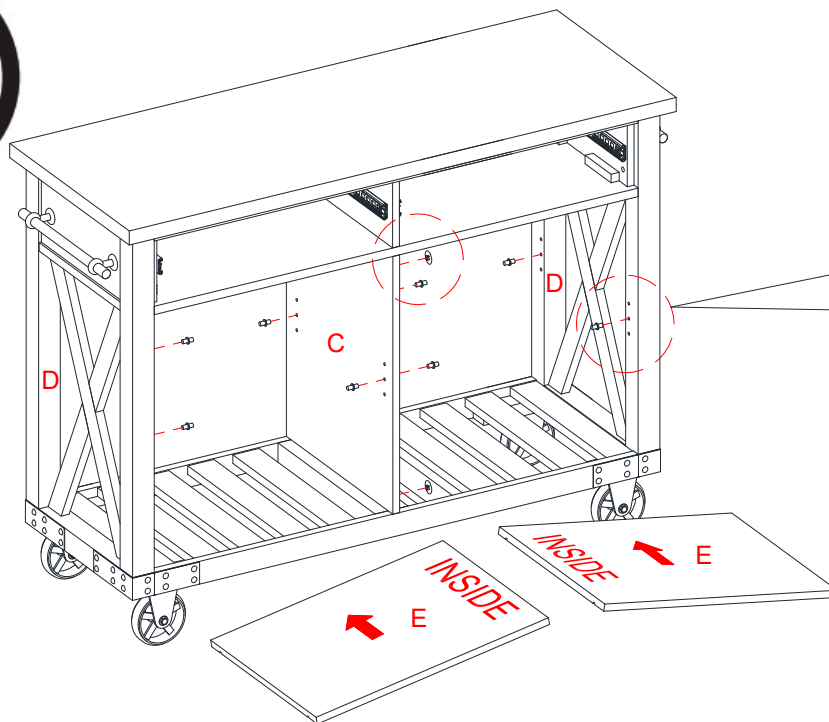

13. Ask for assistance to lift the previous assembly upright.
14. Insert the Shelf Pins (9) into the desired holes in the sides of each compartment. Make sure you place the four shelf pins in the same level so the shelf is not tilted. Tilt and rest the Adjustable Shelves (E) onto the Shelf Pins (9). Be sure to fit the notches underneath the shelves onto the shelf pins properly.
15. Plug four Cam Lock Covers (10) onto the visible Cams Locks to conceal the cams.

Assembly Instructions

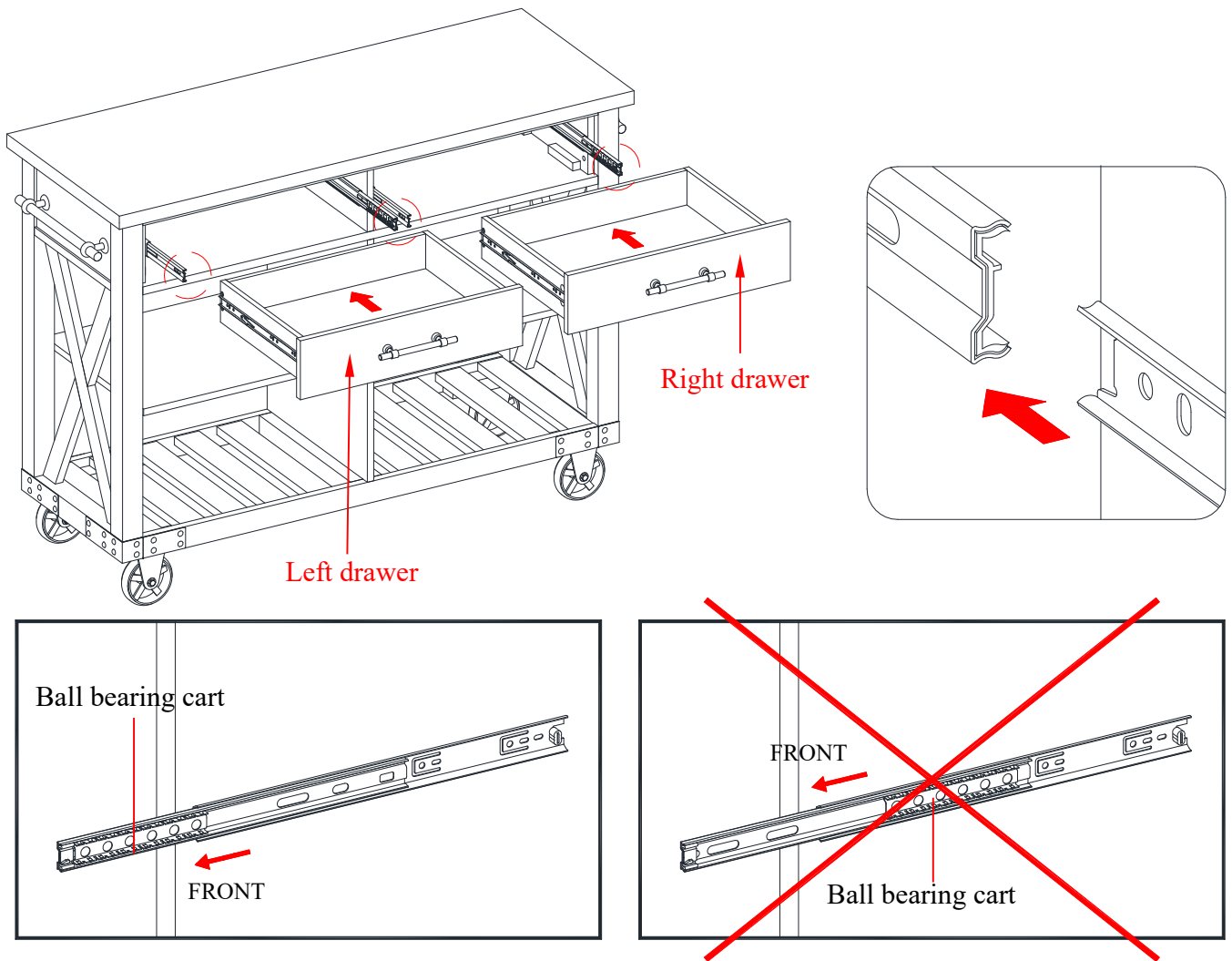

16. Now, go back and securely tighten all the cam locks and screws. Make sure that all the parts are tight and there are no gaps between the parts. This will help keep the unit square.
17. Place the drawer back by pushing the ball bearing cart all the way to the end of the slides (in both sides) and align the slide runners on the drawer with the slide tracks on the unit and push it carefully inside until it stops. If the drawer does not go in smoothly, please take it out and repeat the step.

CAUTION: Lock the casters at all times when not rolling the unit and particularly when opening the drawers.



Assembly Instructions

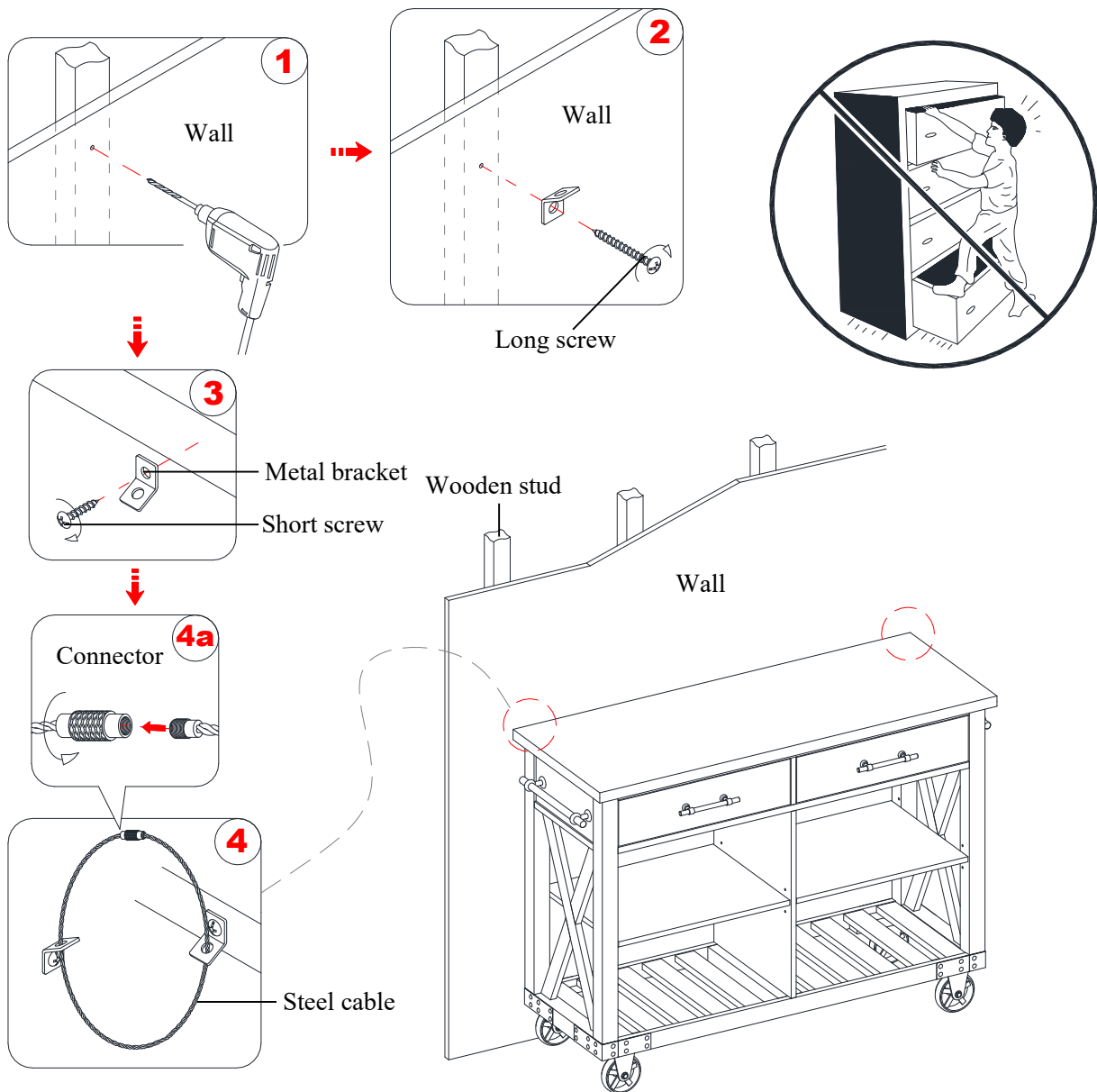

Tools required: Phillips screwdriver, stud finder, pencil, tape measure, power drill and 1/8" drill bit.

18. Ask for assistance to position the assembled unit at the desired location against a wall.
19. Follow the instructions printed on the plastic bag containing the Tipping Restraint Hardware to attach the tip-over restraints to the unit and the wall.

NOTE: The tipping restraint hardware included is for wooden stud wall construction. It must be attached to a wall stud. Depending upon your wall construction, different anchor hardware maybe required. Please contact your local hardware store for assistance. Young children can be seriously injured by tipping furniture. You must install the Tipping Restraint Hardware with the unit to prevent the unit from tipping, causing any accidents or damage. The tipping restraints are intended only as a deterrent, they are not a substitute for proper adult supervision. The tipping restraints are not earthquake restraints. If you wish to add the extra security of earthquake restraints, they must be purchased and installed separately.

20. The unit is now ready for use.

Care and Maintenance

- Use a soft, clean cloth that will not scratch the surface when dusting.
- Use of furniture polish is not necessary. Should you choose to use polish, test first in an inconspicuous area.
- Using solvents of any kind on your furniture may damage the finish.
- Never use water to clean your furniture as it may cause damage to the finish.
- Always use coasters under beverage glasses and flowerpots.
- Liquid spills should be removed immediately. Using a soft, clean cloth, blot the spill gently. Avoid rubbing.
- Always use protective pads under hot dishes and plates. Heat can cause chemical changes that may create spotting within the furniture finish.
- In the event that your furniture is stained or otherwise damaged during use, we recommend that you call a professional to repair your furniture.
- Check bolts/screws periodically and tighten them if necessary.

Further Advice about Wood Furniture Care

It is best to keep your furniture in a climate-controlled environment. Extreme temperature and humidity changes can cause fading, warping, shrinking and splitting of wood. It is advised to keep furniture away from direct sunlight as sun may damage the finish.

Proper care and cleaning at home will extend the life of your purchase. Following these important and helpful tips will enhance your furniture as it ages.

A touch-up pen has been provided to minimize the small nicks or scratches that may occur during assembly or shipping.

We hope you enjoy your purchase for many years.
Thank you for your purchase!

QUALITY GUARANTEE

We are confident that you will be delighted with your Whalen Furniture purchase.

Should this product be defective in workmanship or materials or fail under normal use, we will repair or replace it for up to one (1) year from date of purchase. Every Whalen Furniture product is designed to meet your highest expectations. We guarantee that you will immediately see the value of our fine furniture.

This warranty gives you specific legal rights and you may also have other rights which vary from state to state or province to province.

Whalen Furniture Manufacturing,
1578 Air Wing Road
San Diego, CA 92154, USA
Customer Service: 1-866-942-5362
8:30 a.m. - 4:30 p.m., PST, Monday to Friday
www.whalenfurniture.com