



THRESHOLD™

Derry Stone Top Mixed Material Kitchen Island

Style # J711028-3 DPC-item # 249-04-4790

Style # J711028-3-D DPC-item # 249-94-0086



>> Assembly instructions



Congratulations on your latest Target purchase.

Now what? Don't start sweating over this box of parts. This will be easy. We did the hard work for you. All you need to do is follow our simple instructions and you'll be on your way to transforming your room in no time. Good luck – though we're confident you won't need it.

before you begin

1. Check for damaged or missing parts. Call 1-855-MYTGTHOME (855-698-4846) to order missing supplies.
2. Use the carton as a work surface to prevent product damage during assembly.
3. Gather all tools prior to assembly.



tools needed (only hex wrench and open wrench included)

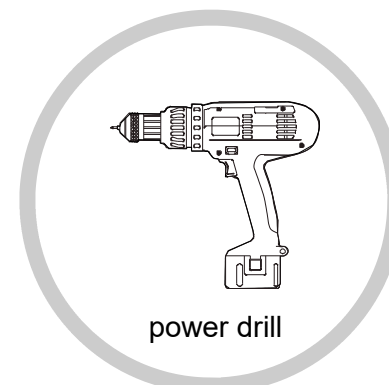
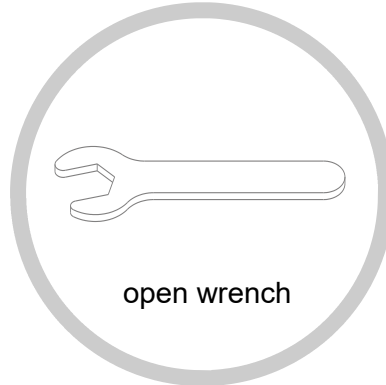
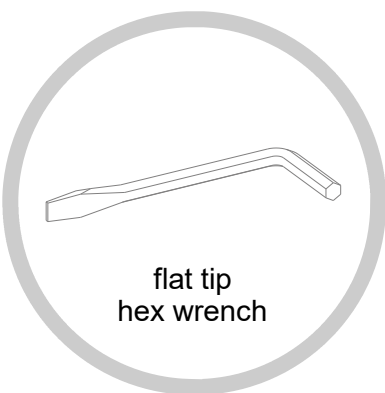

For tipping restraint hardware kit only

 WARNING	
	<p>Children have died from furniture tipover. To reduce the risk of furniture tipover:</p> <ul style="list-style-type: none">• ALWAYS install tipover restraint provided.• NEVER put a TV on this product.• NEVER allow children to stand, climb or hang on drawers, doors, or shelves.• NEVER open more than one drawer at a time.• Place heaviest items in the lowest drawers.
	<p>Use of tip-over restraints may only reduce, but not eliminate, the risk of tip-over.</p>

hardware

(H1) x 15
large cam lock



(H2) x 12
small cam lock

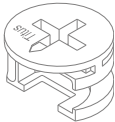

(H3) x 27
cam bolt

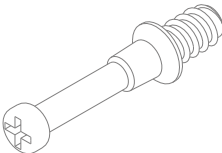

(H4) x 14
large wood dowel



(H5) x 4
15 mm bolt

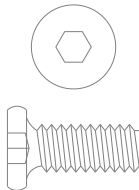

(H6) x 4
30 mm bolt

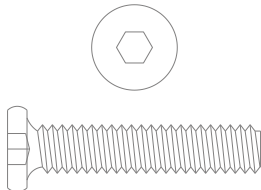

(H7) x 12
lock washer



(H8) x 12
flat washer

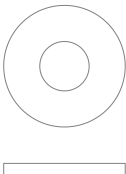

(H9) x 22
38 mm screw

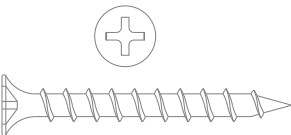

(H10) x 4
19 mm handle bolt

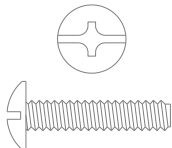

(H11) x 4
45 mm bolt

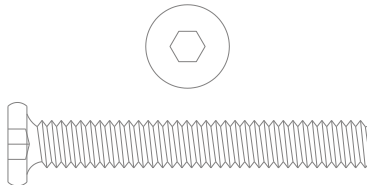

(H12) x 16
12 mm screw

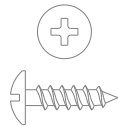

(H13) x 4
small wood dowel



(H14) x 1
hex wrench



(H15) x 1
open wrench



(H16) x 2
tipping restraint hardware kit
(inside plastic bag)

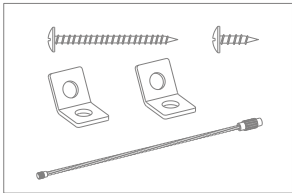

Spare hardware

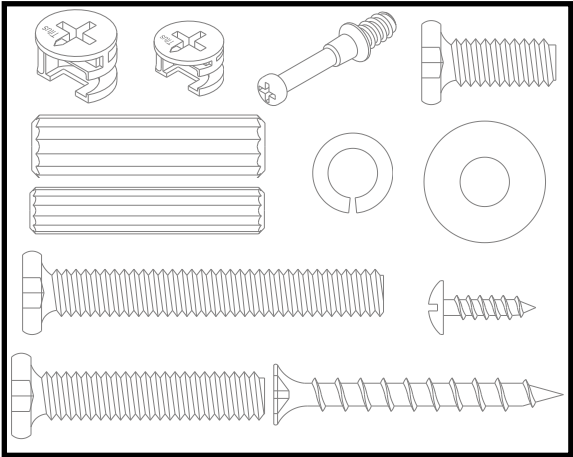

exploded diagram

ITEM	DESCRIPTION	QTY
A	top panel	1
B	left side frame	1
C	bottom shelf	1
D	side stretcher	2
E	top back rail	1
F	back panel	1
G	front stretcher	1
H	top front rail	1
I	side handle	2
J	drawer handle	2
K	upper drawer front	1
L	upper drawer left side	1
M	upper drawer right side	1
N	upper drawer back panel	1
O	drawer bottom panel	2
P	drawer bottom support	4
Q	lower drawer front	1
R	lower drawer left side	1
S	lower drawer right side	1
T	lower drawer back panel	1
U	fixed shelf	1
V	Caster	4
W	bottom rail	2
X	right side frame	1

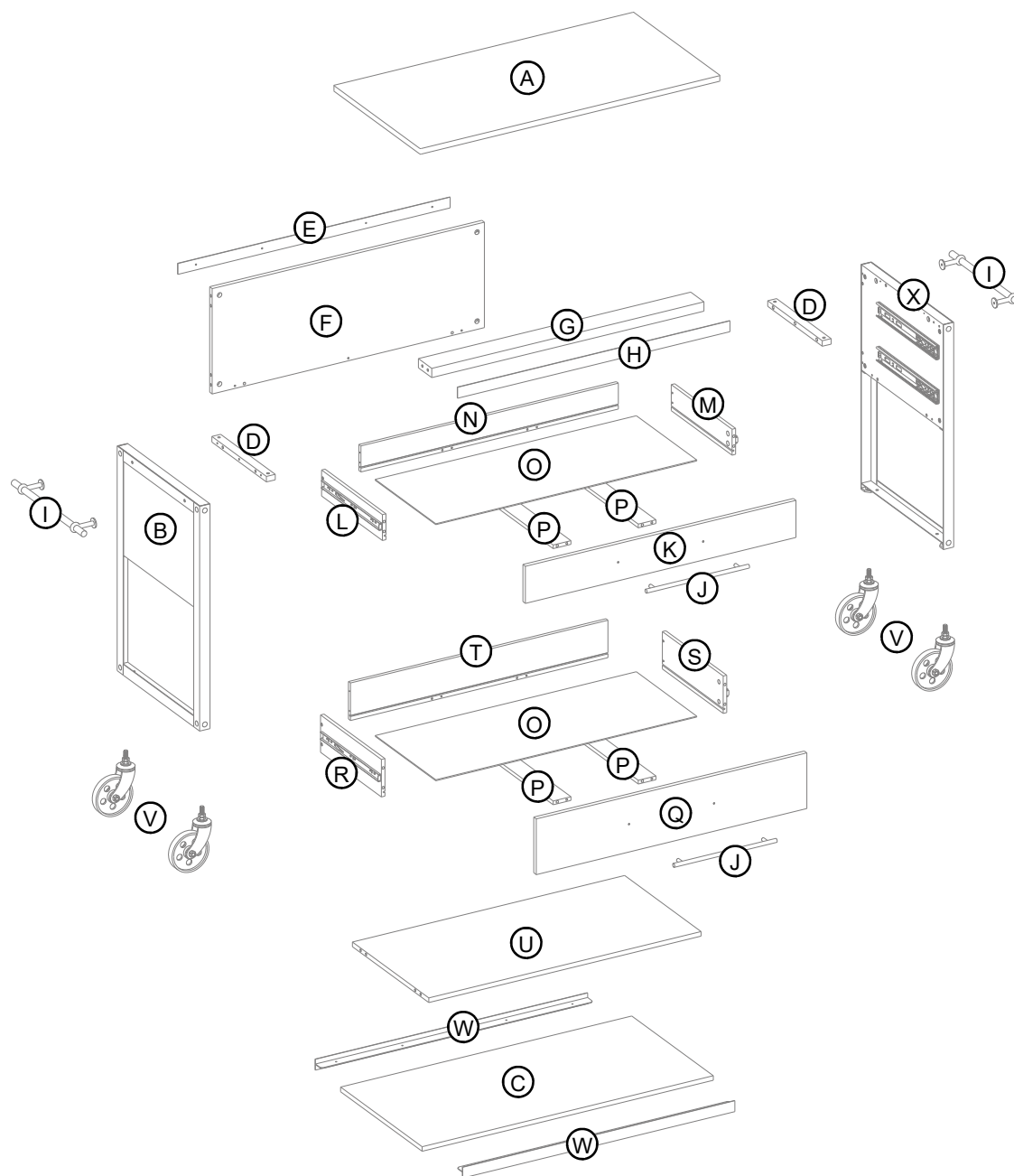

how to use the cam lock system

1.

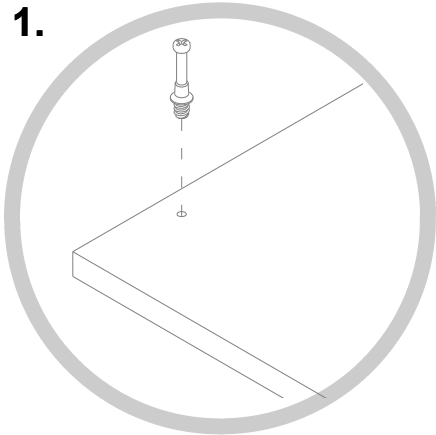

Screw cam bolt into panel

2.

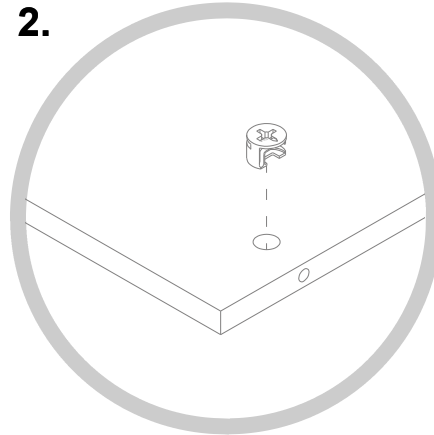

Push cam into panel - arrow feature on cam top points to panel edge

3.

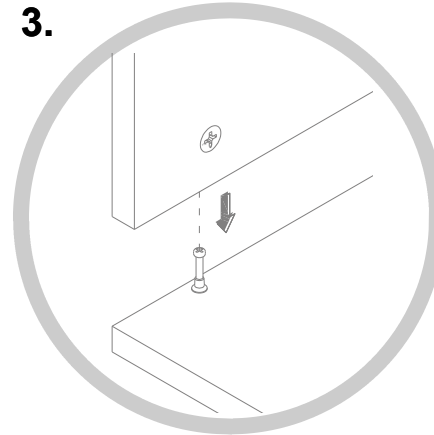

Align cam bolt(s) with cam(s) and insert all the way into cross-bored hole(s)

4.

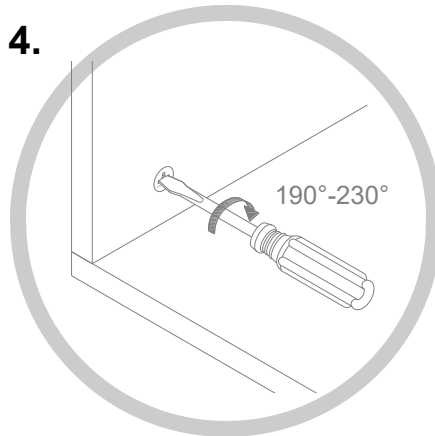

Rotate cam(s) clockwise 190°-230° to lock panels together

5.

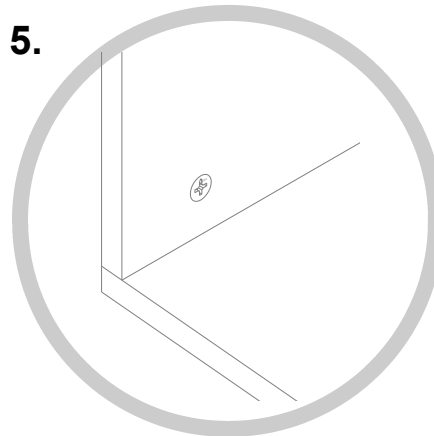

Panels should be tight against each other and connection should be rigid

step 1: attach cam bolts to drawer fronts

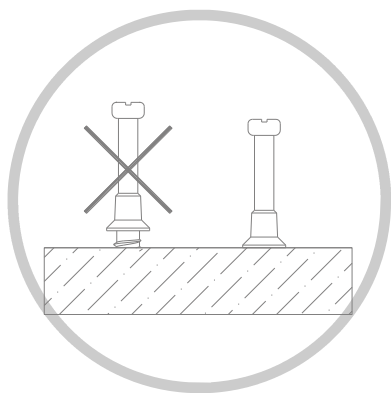

(H3) x 12
cam bolt

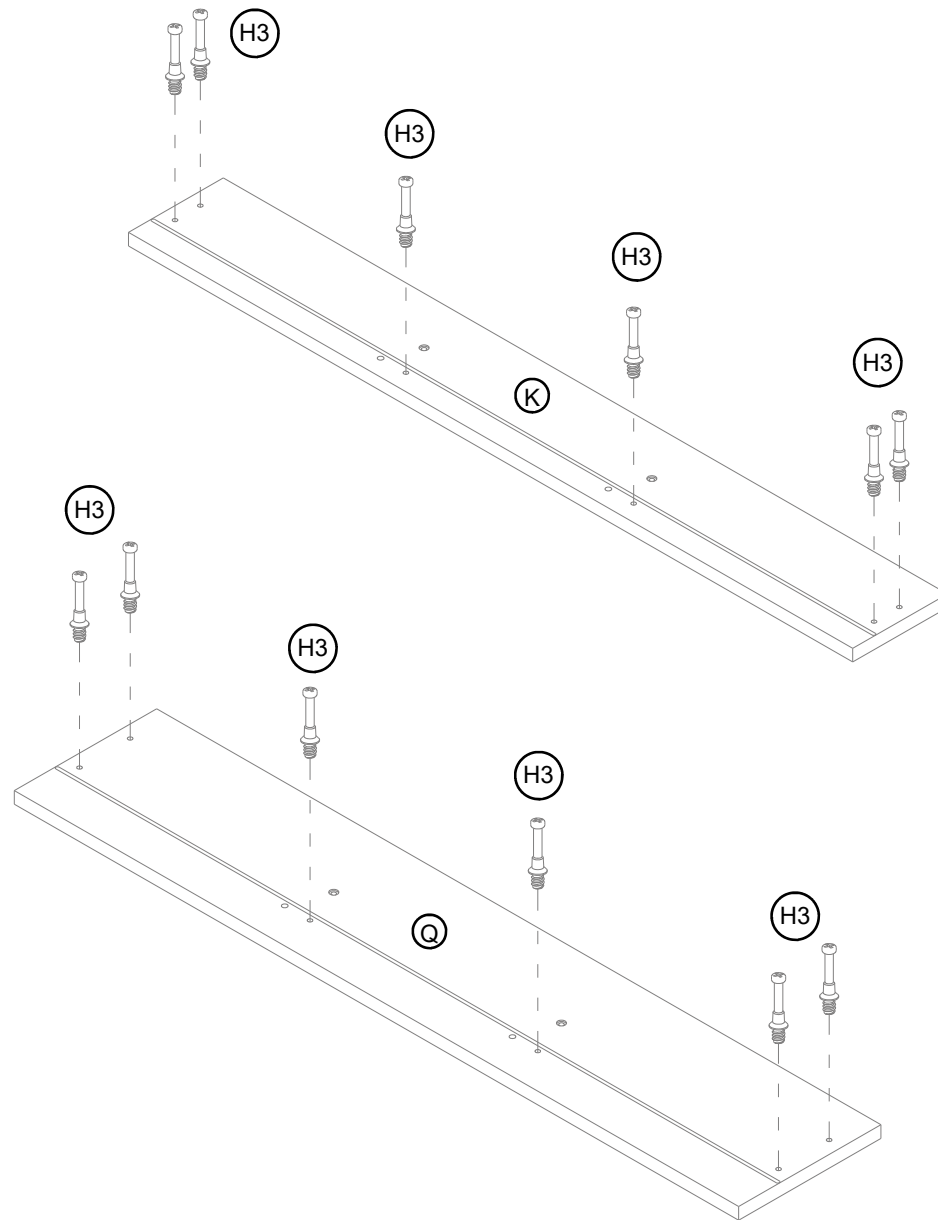
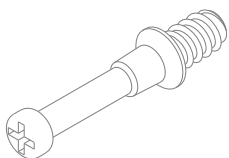

1.1. Screw-in cam bolts must be screwed down flush with the panels.

step 2. attach upper drawer side panels to upper drawer front

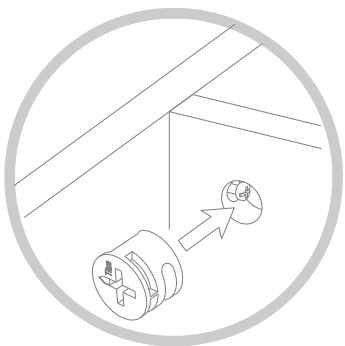

(H2) x 4
small cam lock

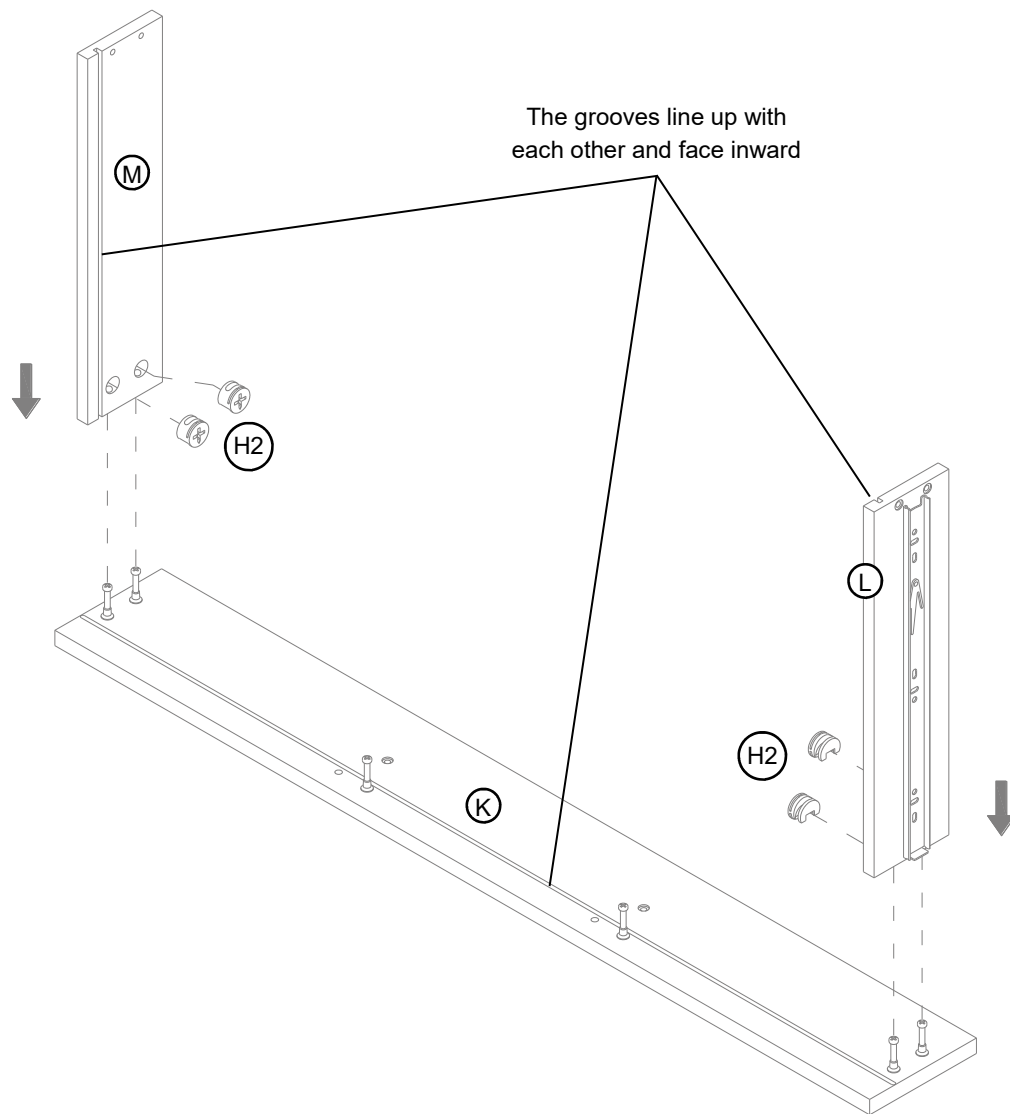

2.1. Attach upper drawer side panels (L and M) to upper drawer front (K).

step 3. attach drawer bottom supports to upper drawer front

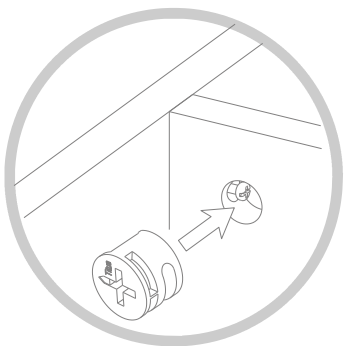

(H2) x 2
small cam lock

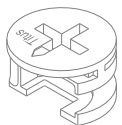

(H13) x 2
small wood dowel

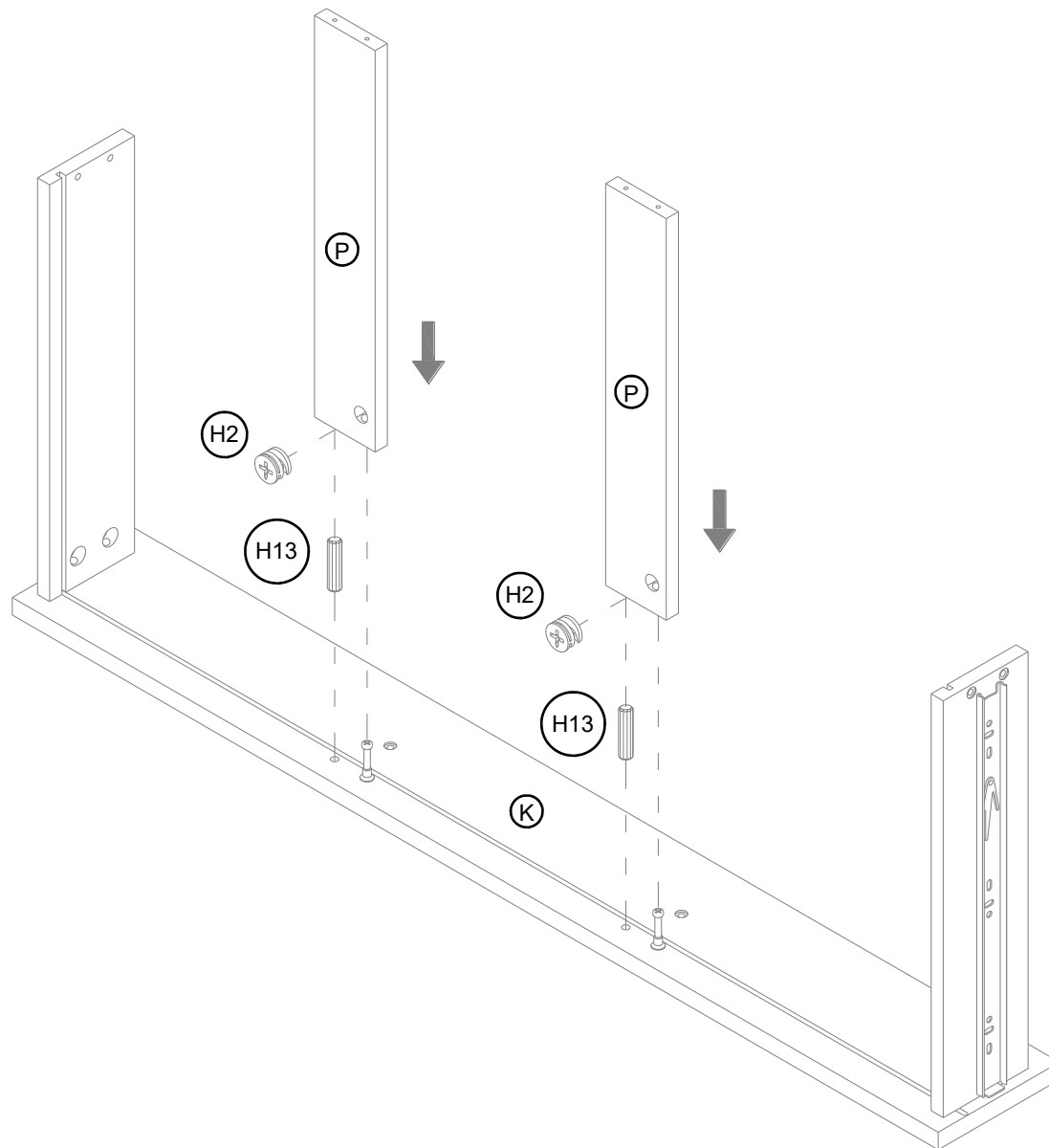

3.1. Attach two drawer bottom supports (P) to the upper drawer front (K).

step 4. attach drawer bottom panel to the unit

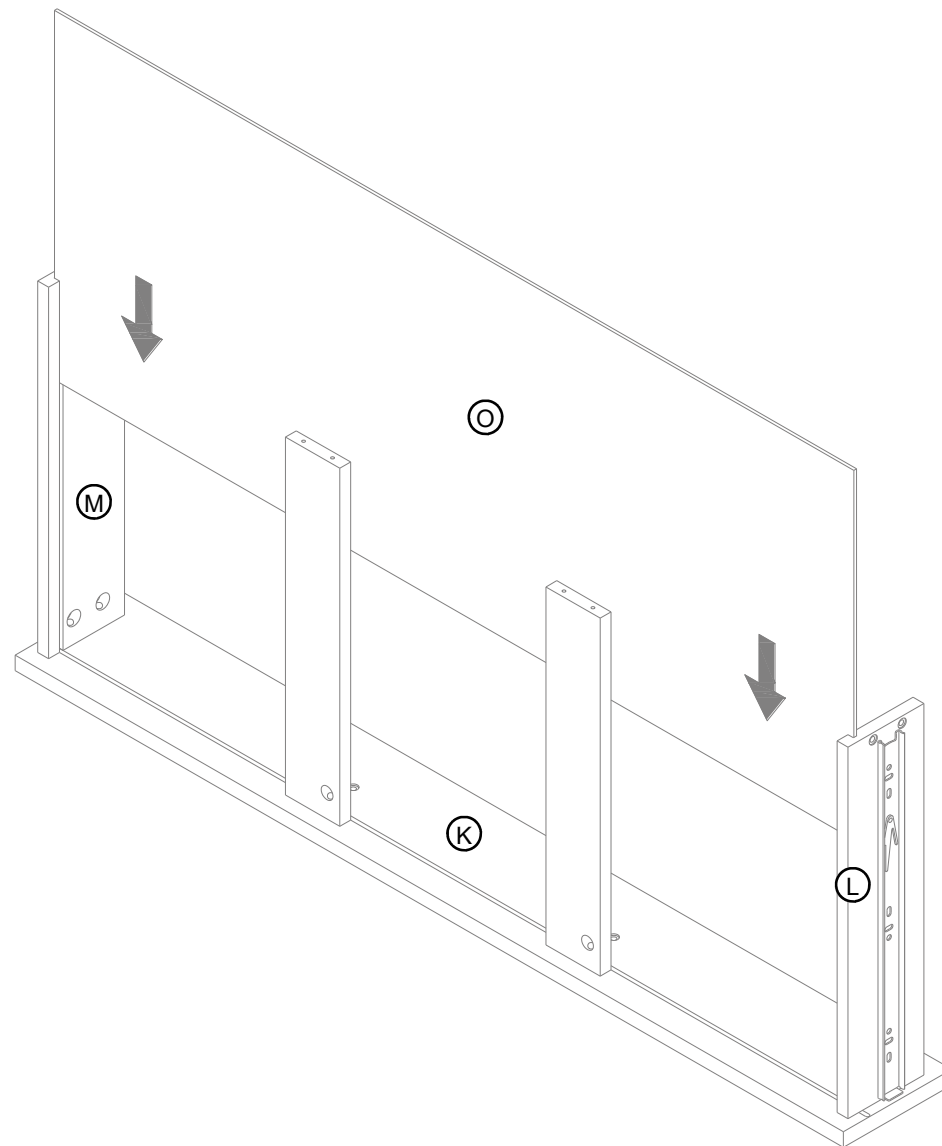

4.1. Slide one drawer bottom panel (O) into the grooves between the drawer side panels (L and M) until fully inserted into the groove of the drawer front (K).

step 5. attach upper drawer back panel to the unit

NOTE: Make sure that the drawer bottom panel (O) fits securely into the groove of the drawer back panel (N).

(H9) x 8
38 mm screw

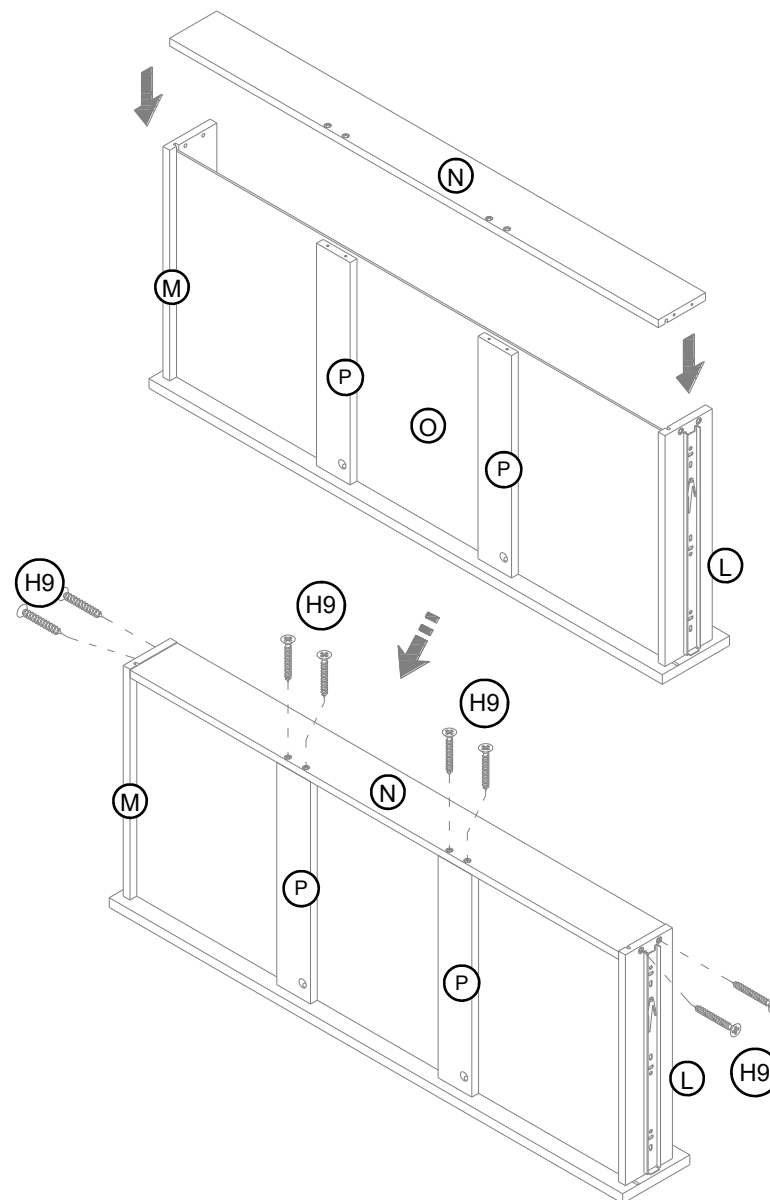
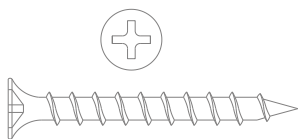

5.1. Attach upper drawer back panel (N) to the drawer side panels (L and M) and drawer bottom supports (P).

step 6. attach handle to upper drawer front

(H10) x 2
19 mm handle bolt

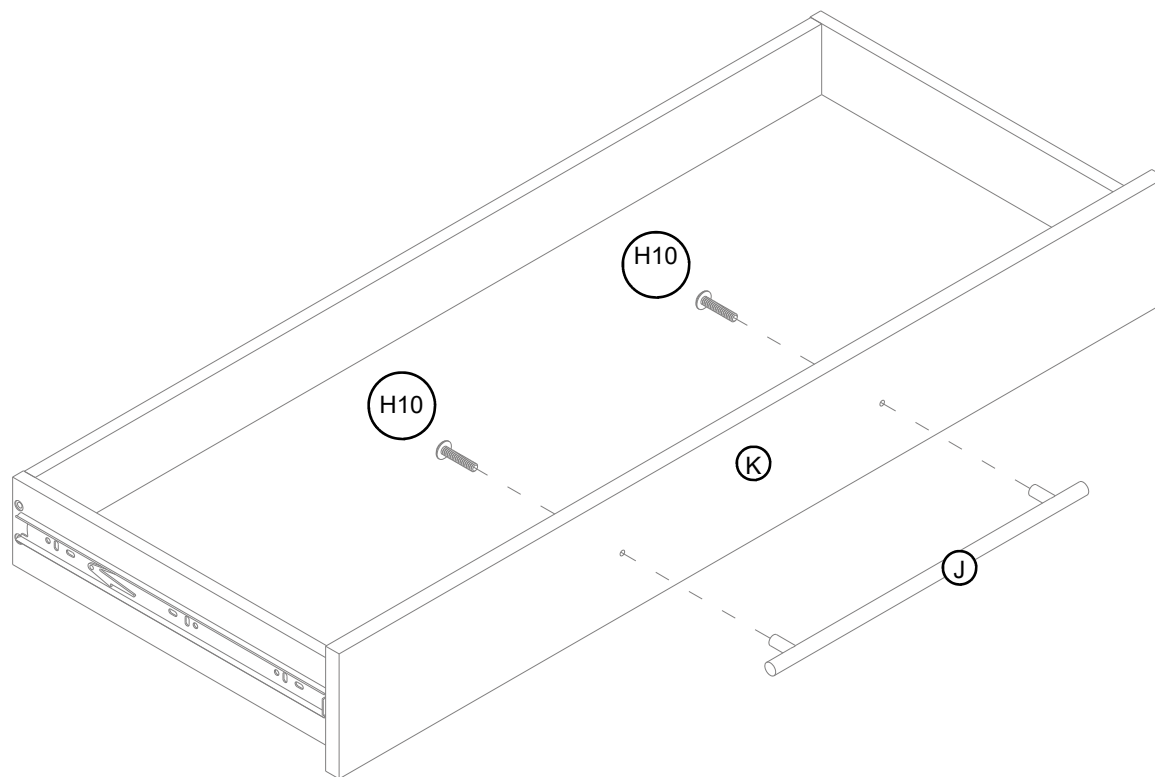
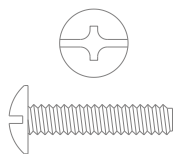

6.1. Fasten one drawer handle (J) to the outside of the upper drawer front (K).

step 7. attach lower drawer side panels to lower drawer front

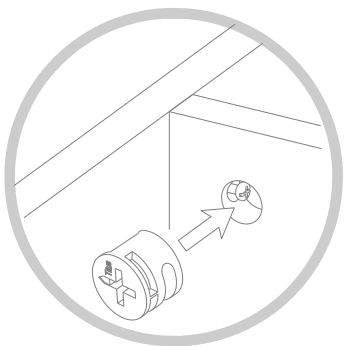

(H2) x 4
small cam lock

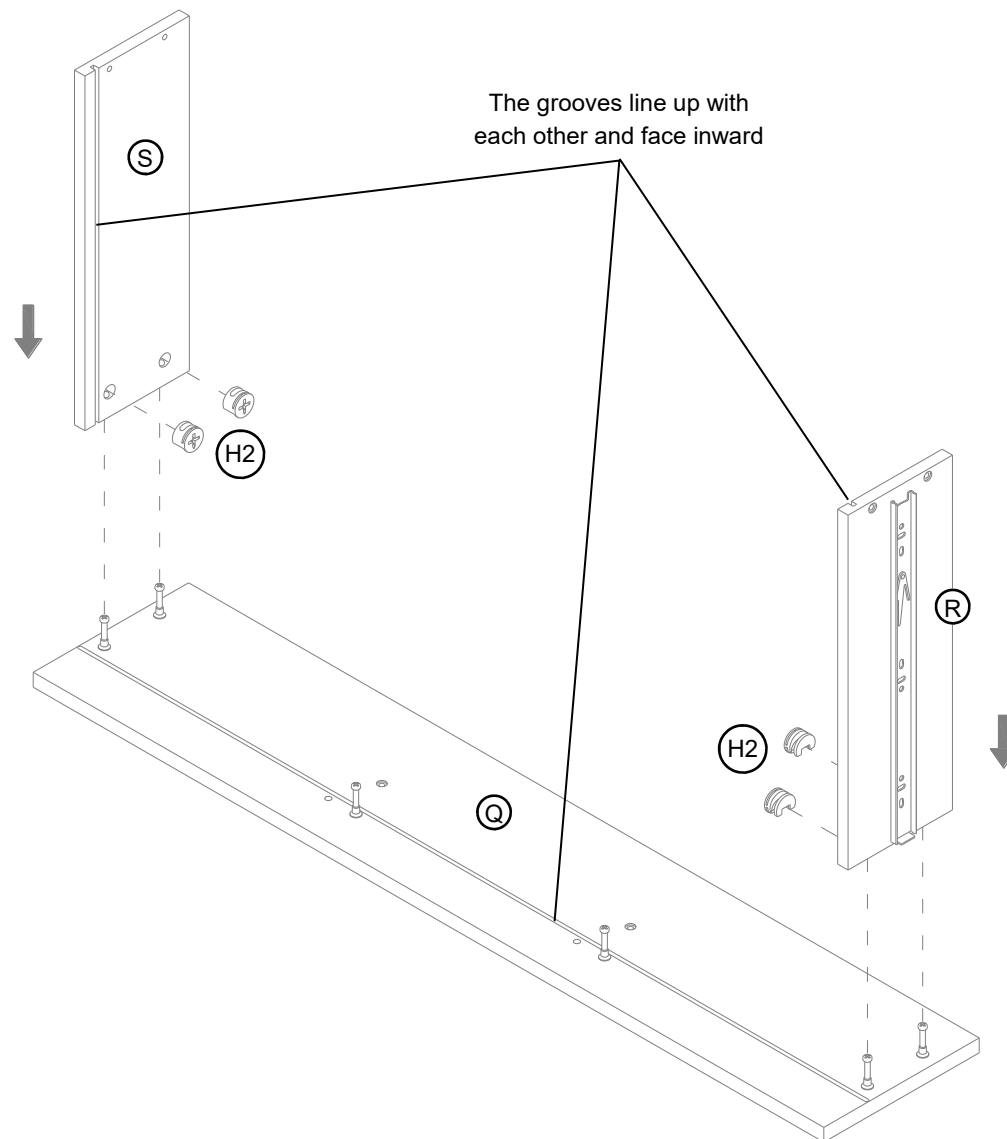

7.1. Attach lower drawer side panels (R and S) to lower drawer front (Q).

step 8. attach drawer bottom supports to lower drawer front

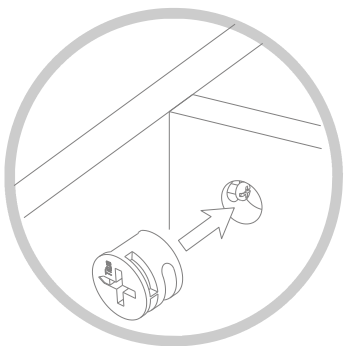

(H2) x 2
small cam lock

(H13) x 2
small wood dowel

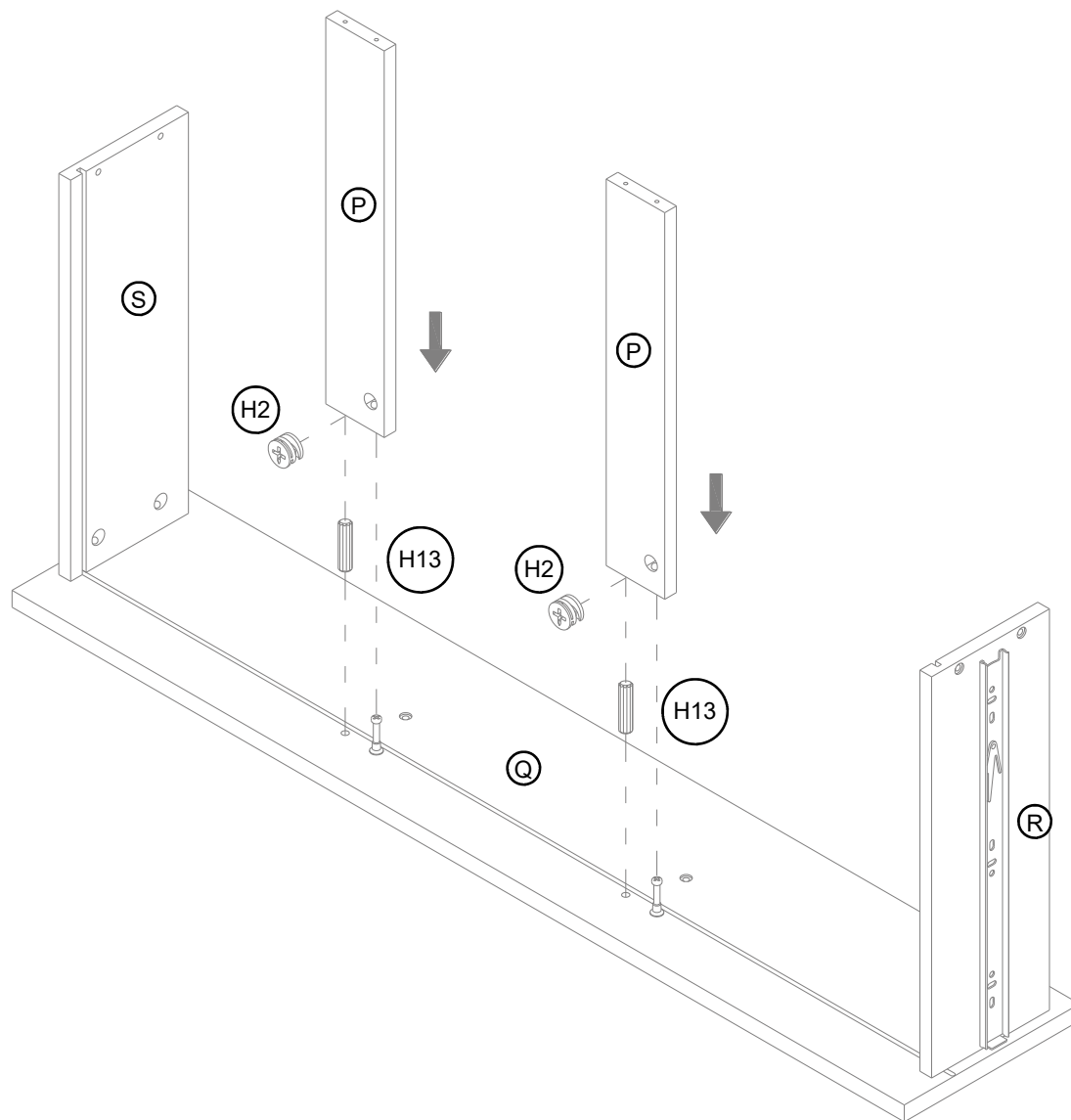
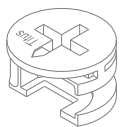

8.1. Attach the remaining drawer bottom supports (P) to lower drawer front (Q).

step 9. attach drawer bottom panel to the unit

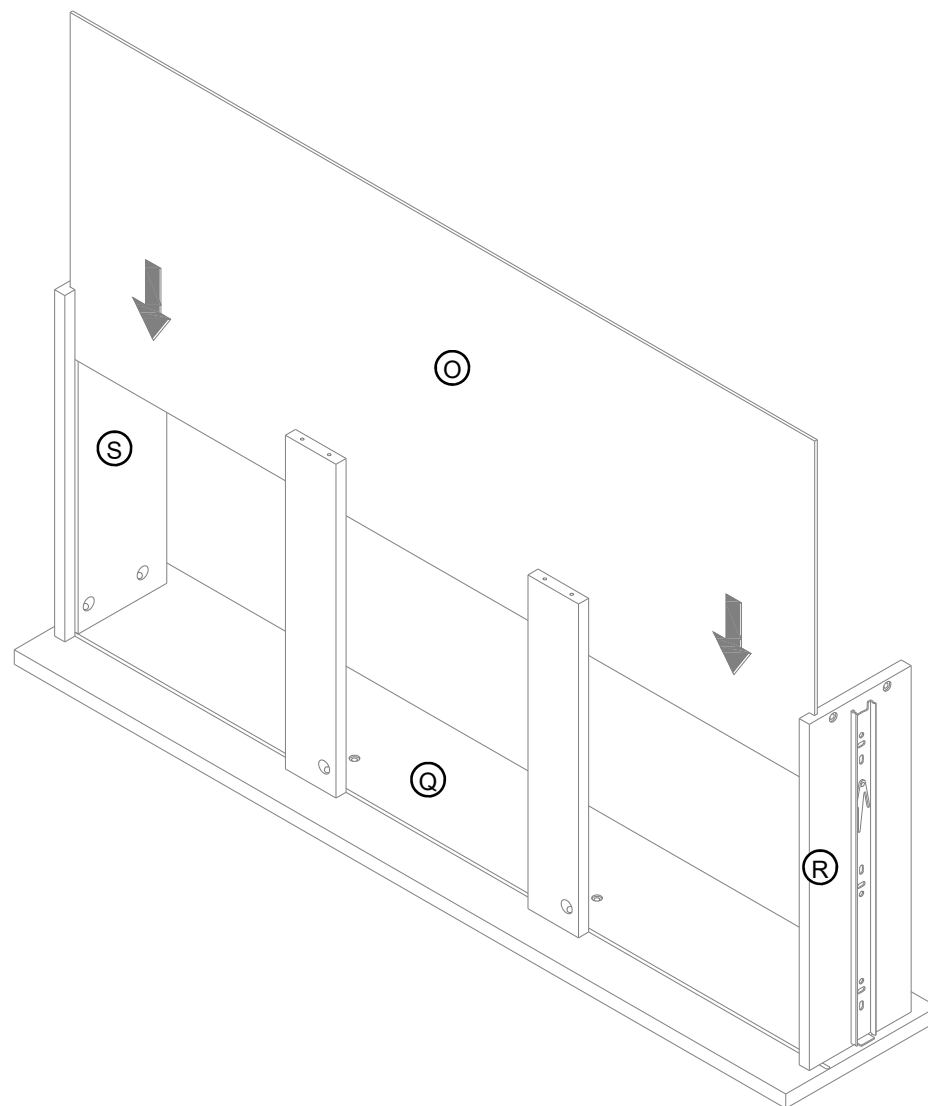

9.1. Slide drawer bottom panel (O) into the grooves between the drawer side panels (R and S) until fully inserted into the groove of the drawer front (Q).

step 10. attach lower drawer back panel to the unit

NOTE: Make sure that the drawer bottom panel (O) fits securely into the groove of the drawer back panel (T).

(H9) x 8
38 mm screw

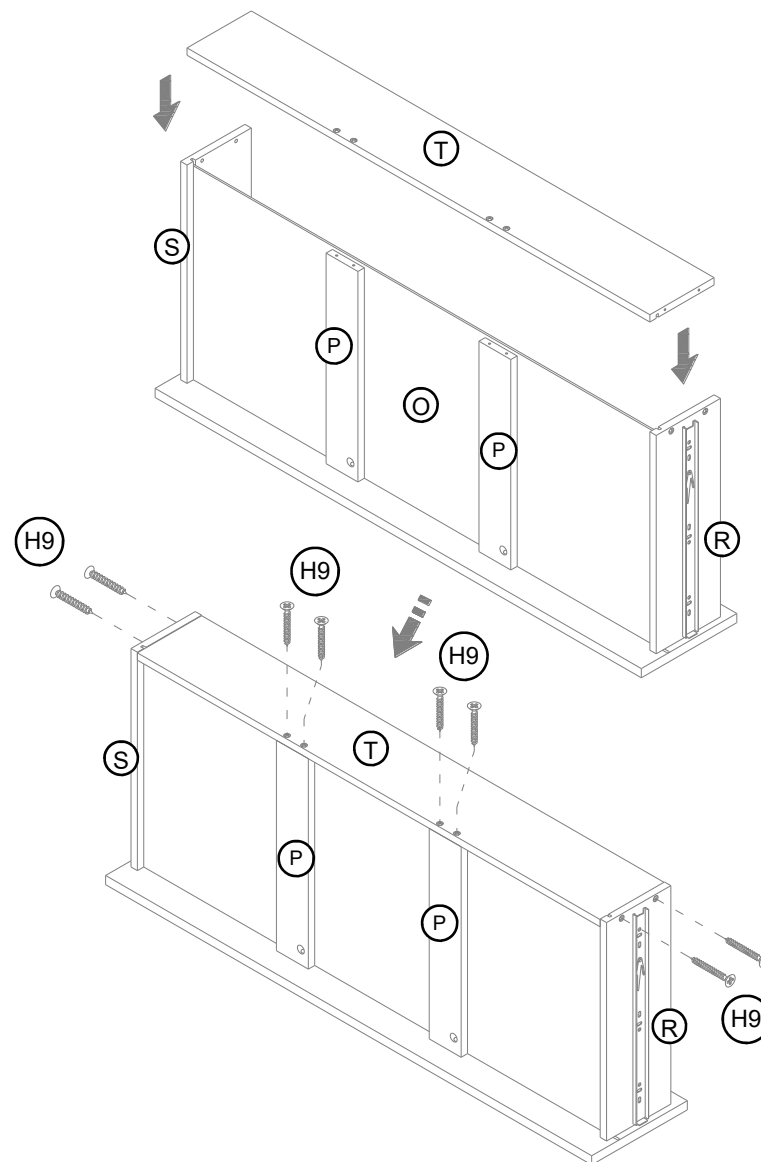
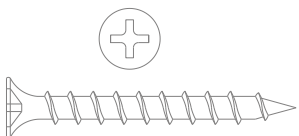

10.1 Attach lower drawer back panel (T) to the drawer side panels (R and S) and drawer bottom supports (P).

step 11. attach handle to lower drawer front

(H10) x 2
19 mm handle bolt

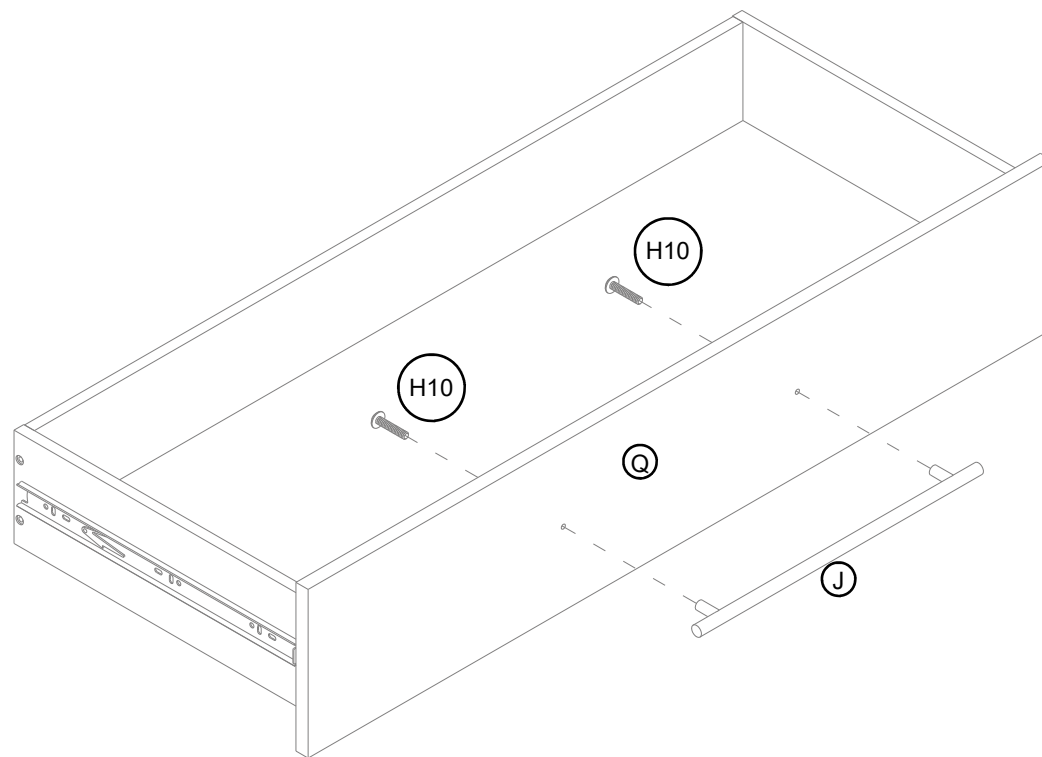
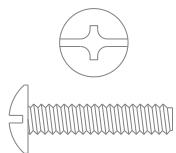

11.1. Fasten the other drawer handle (J) to the outside of the drawer front (Q).

step 12. attach cam bolts to side frames

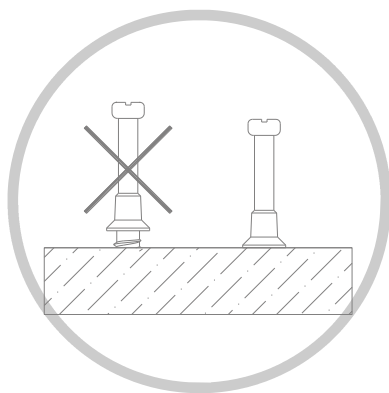

(H3) x 12
cam bolt

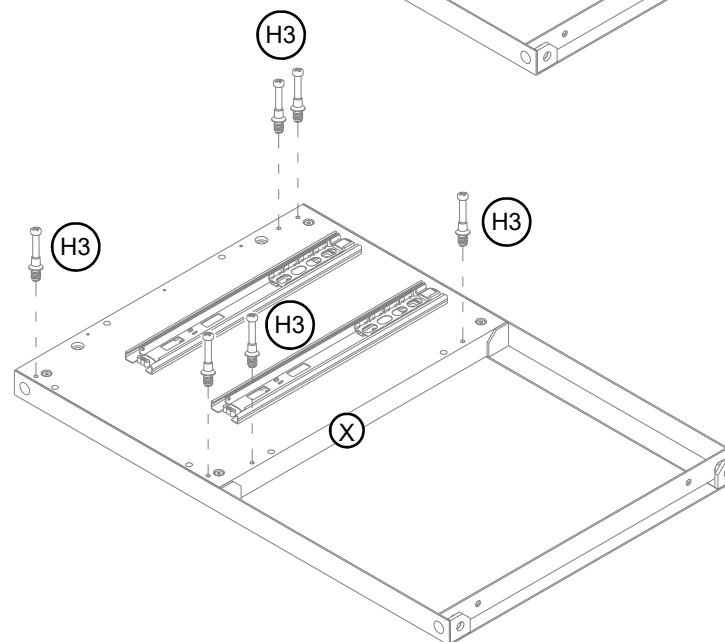
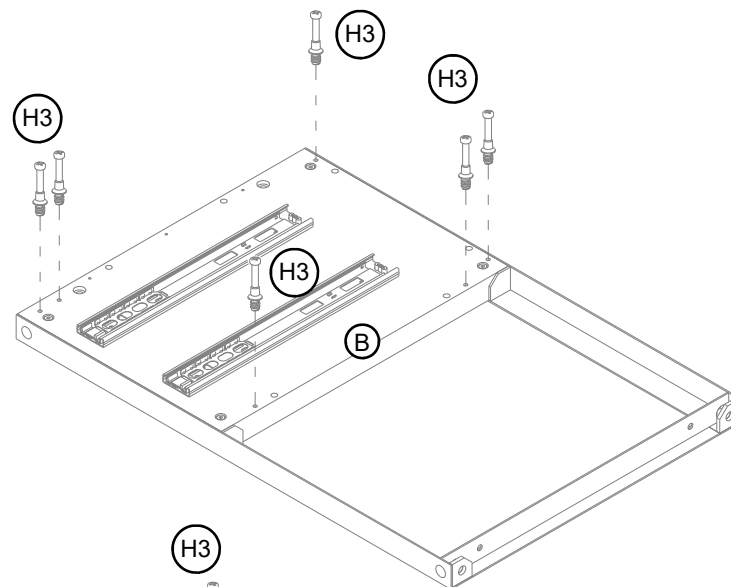
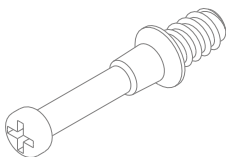

12.1. Screw-in cam bolts must be screwed down flush with the panels.

step 13. attach side handle to left side frame

NOTE: DO NOT fully tighten all bolts until you finish assembling all parts. Once assembled, go back and fully tighten all bolts. This will make the assembly easier.

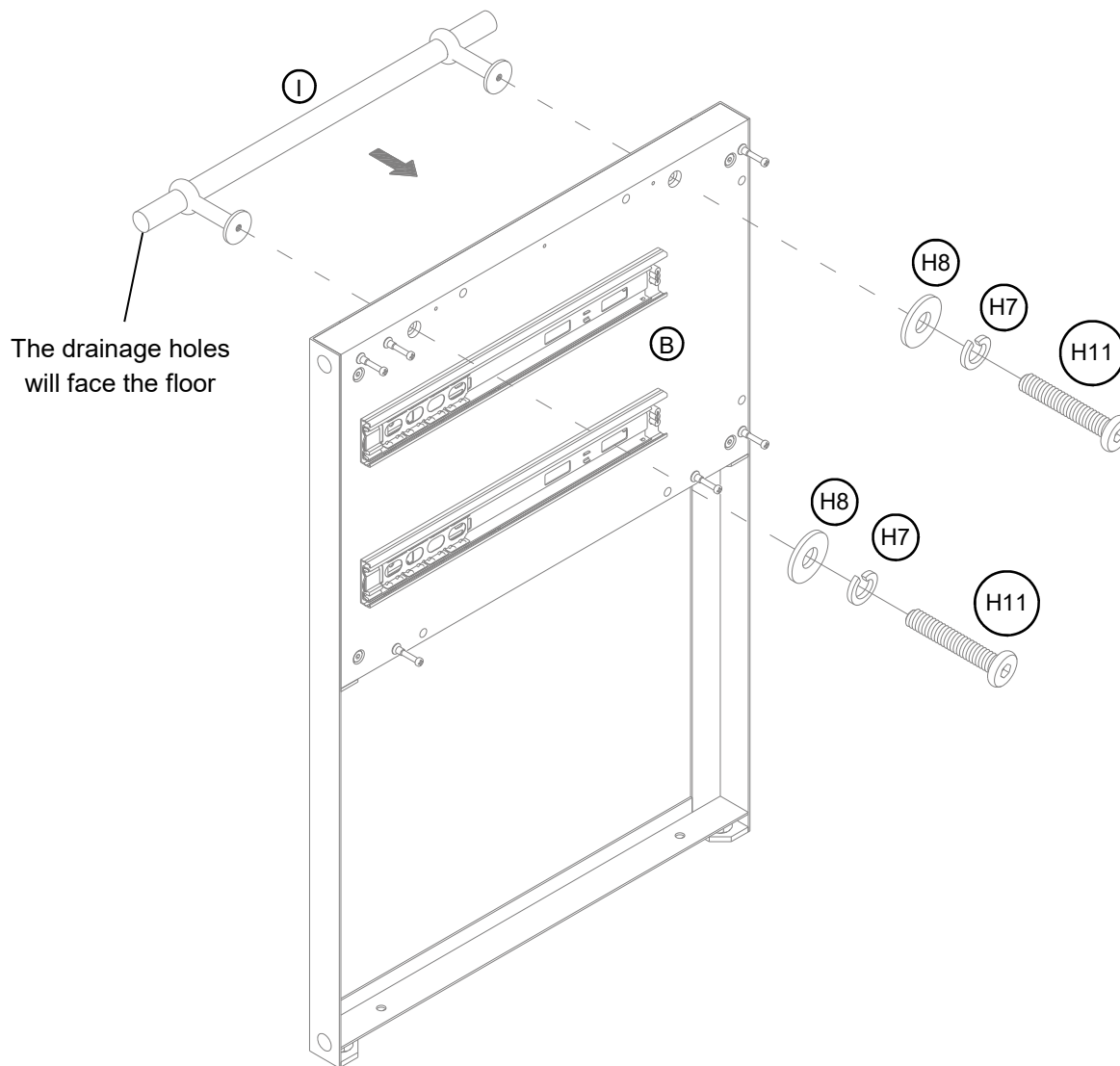

(H11) x 2
45 mm bolt

(H7) x 2
Lock washer

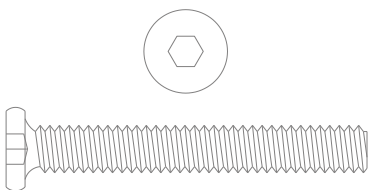

(H8) x 2
Fat washer

(H14) x 1
hex wrench

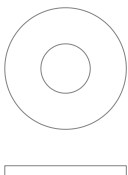

- 13.1. Insert 45 mm bolts with lock washers and flat washers through the countersunk holes of left side frame (B) and screw into the side handle (I).
13.2. Make sure that the drainage hole on the side handle faces the floor.

step 14. attach side stretcher to left side frame

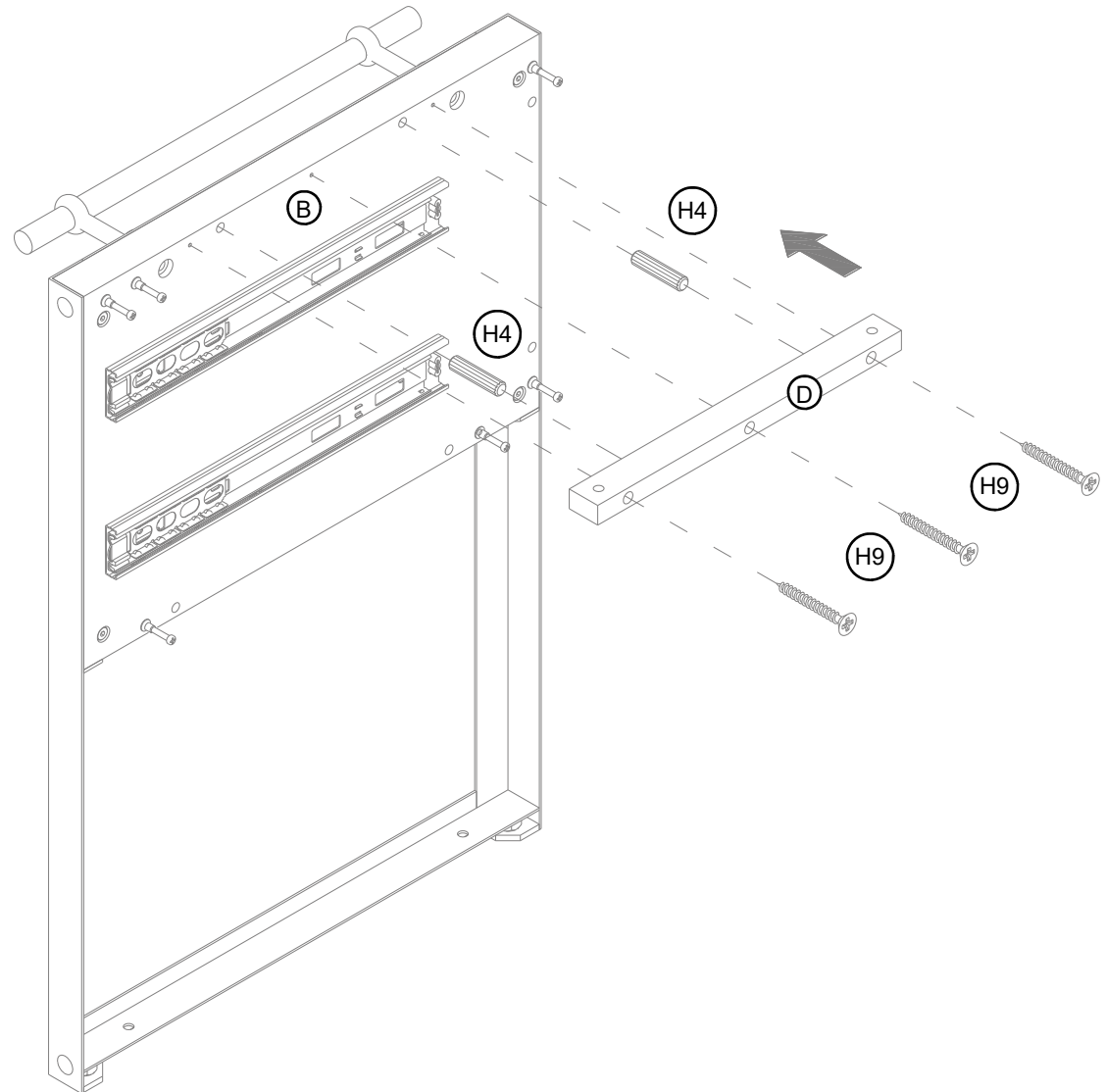

(H4) x 2
large wood dowel

(H9) x 3
38 mm screw

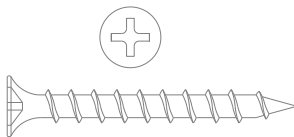

14.1. Attach two large wood dowels as a guide.

14.2. Insert 38 mm screws through the countersunk holes on one side stretcher (D) and securely screw into the left side frame (B).

step 15. attach side handle to right side frame

NOTE: DO NOT fully tighten all bolts until you finish assembling all parts. Once assembled, go back and fully tighten all bolts. This will make the assembly easier.

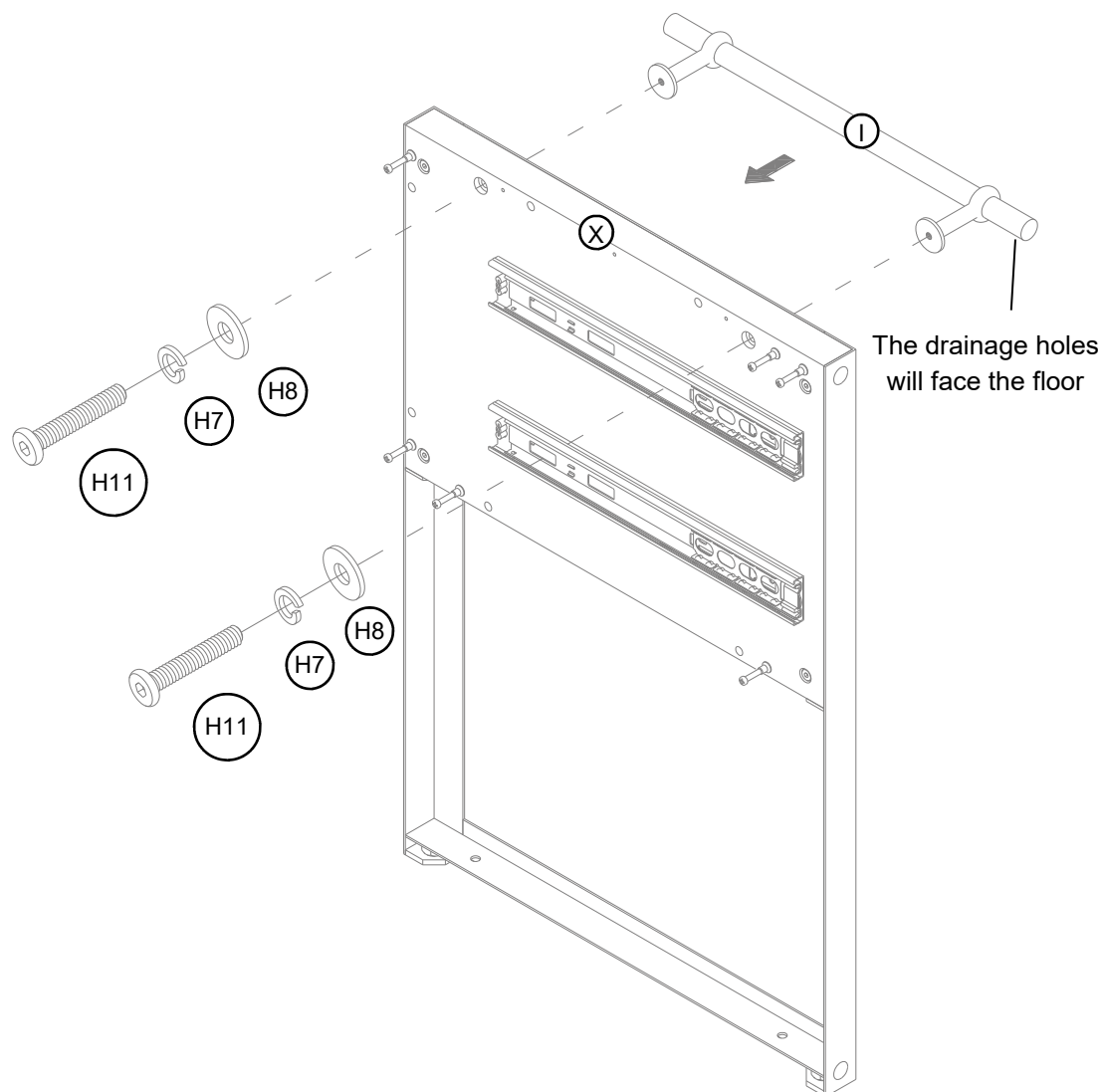

(H11) x 2
45 mm bolt

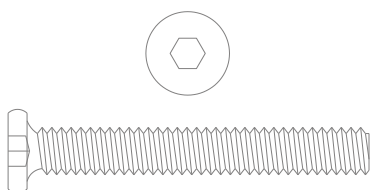

(H7) x 2
Lock washer



(H8) x 2
Flat washer

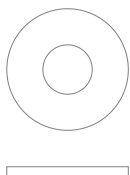

(H14) x 1
hex wrench



- 15.1. Insert 45 mm bolts with lock washers and flat washers through the countersunk holes of right side frame (X) and screw into the side handle (I).
15.2. Make sure that the drainage hole on the side handle faces the floor.

step 16. attach side stretcher to right side frame

(H4) x 2
large wood dowel

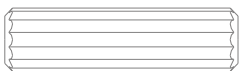

(H9) x 3
38 mm screw

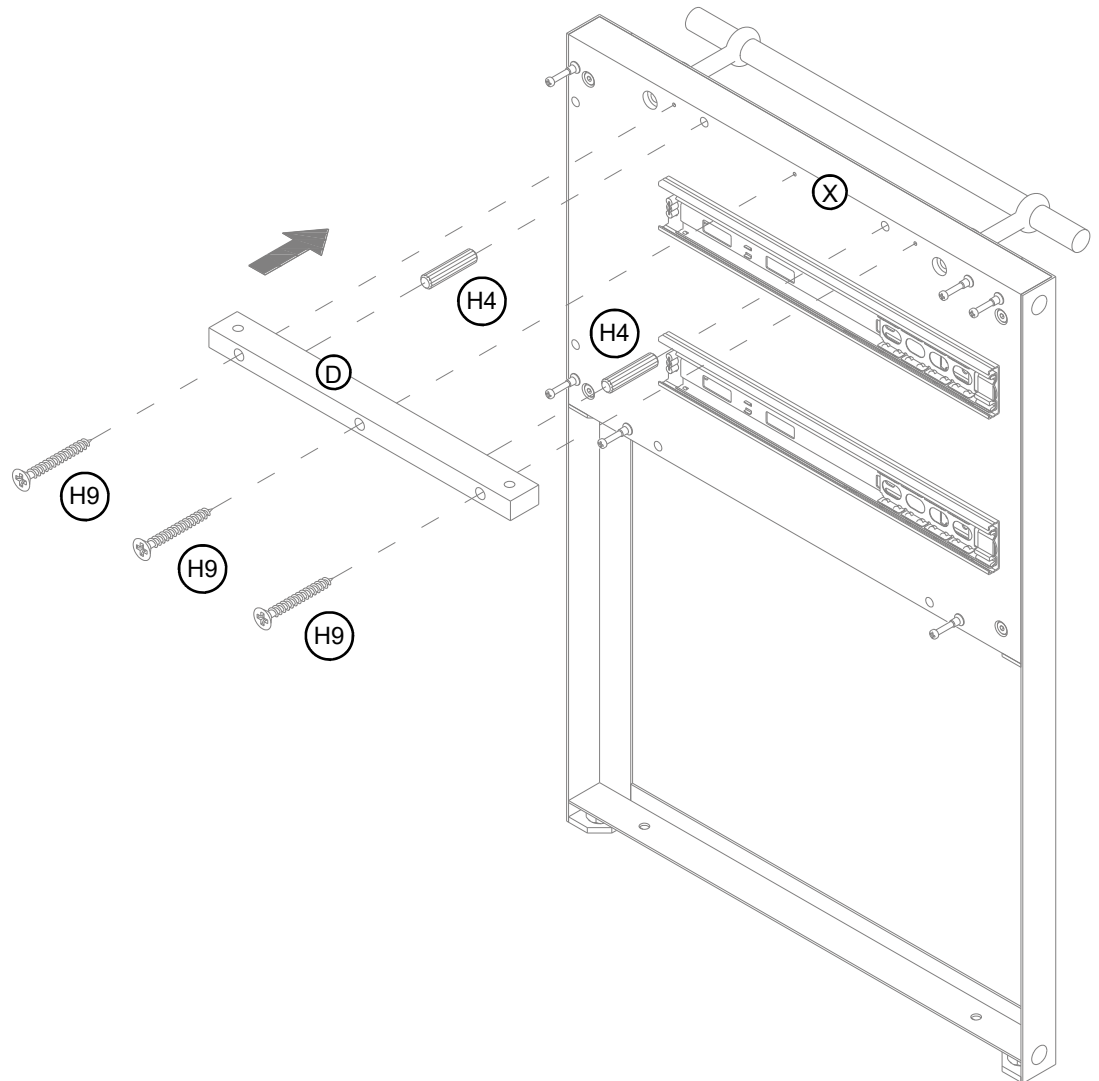
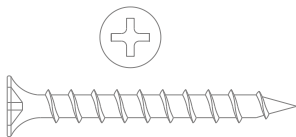

16.1. Attach two large wood dowels as a guide.

16.2. Insert 38 mm screws through the countersunk holes on the other side stretcher (D) and securely screw into the right side frame (X).

step 17. attach top front rail to front stretcher

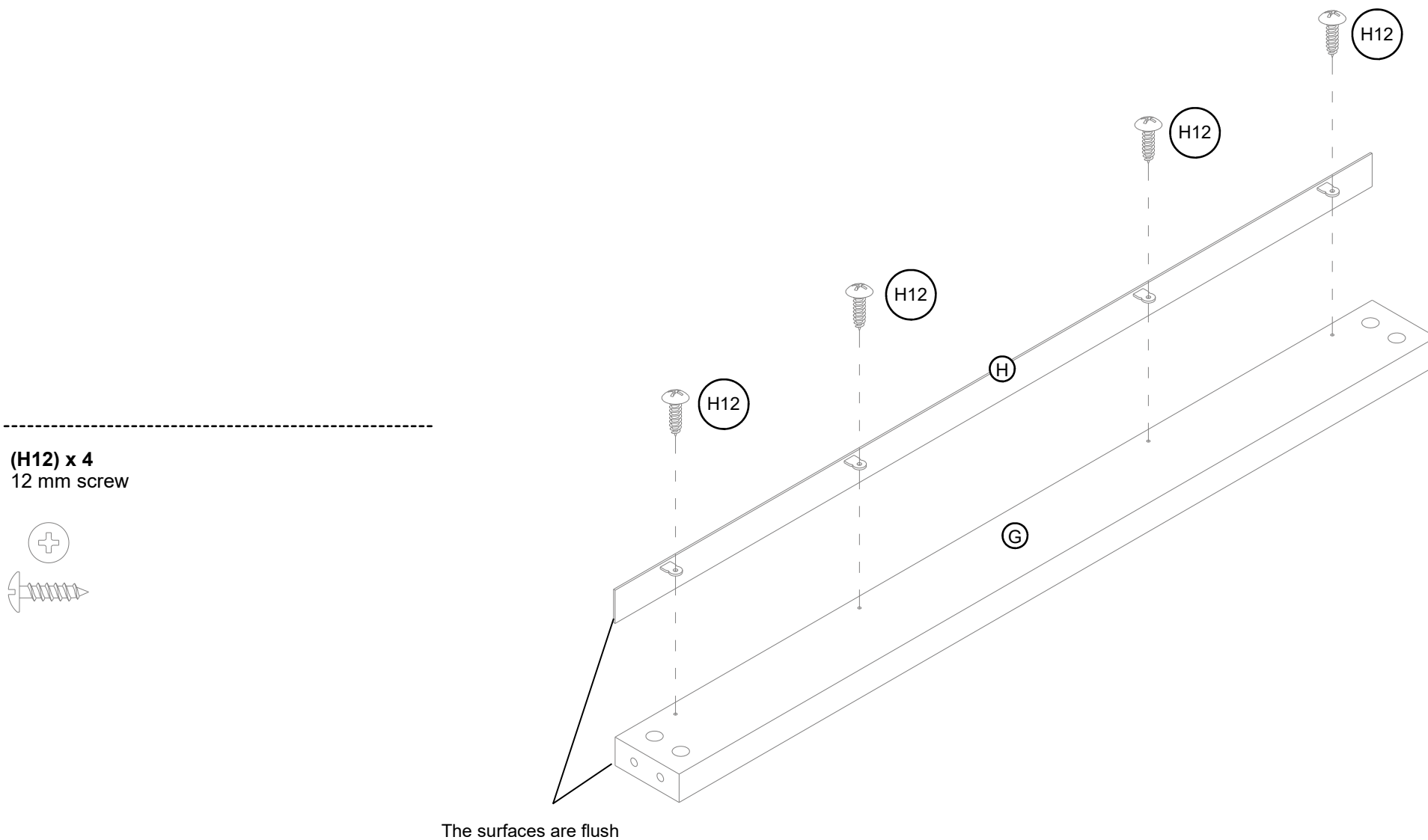

17.1. Using the pilot holes as a guide, attach using 12 mm screws in the metal tabs of top front rail (H).

step 18. attach bottom rails to bottom shelf

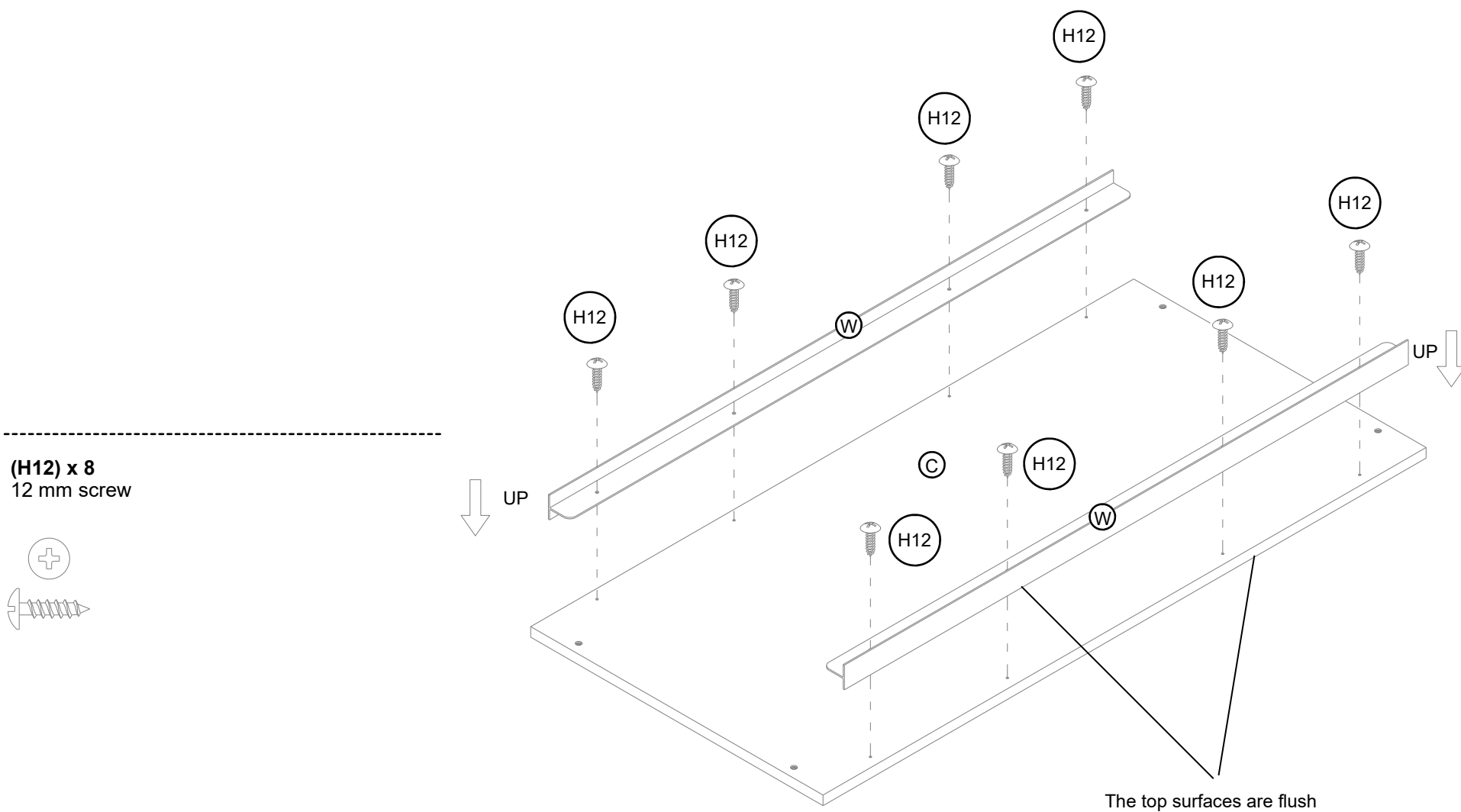

- 18.1. Align the bottom rails (W) so that the mounting holes overlap the pilot holes on the bottom shelf (C). Make sure the top surfaces are flush with each other.
- 18.2. Attach using 12 mm screws into the mounting holes on the bottom rails.

step 19. attach top back rail to back panel and screw-in cam bolts

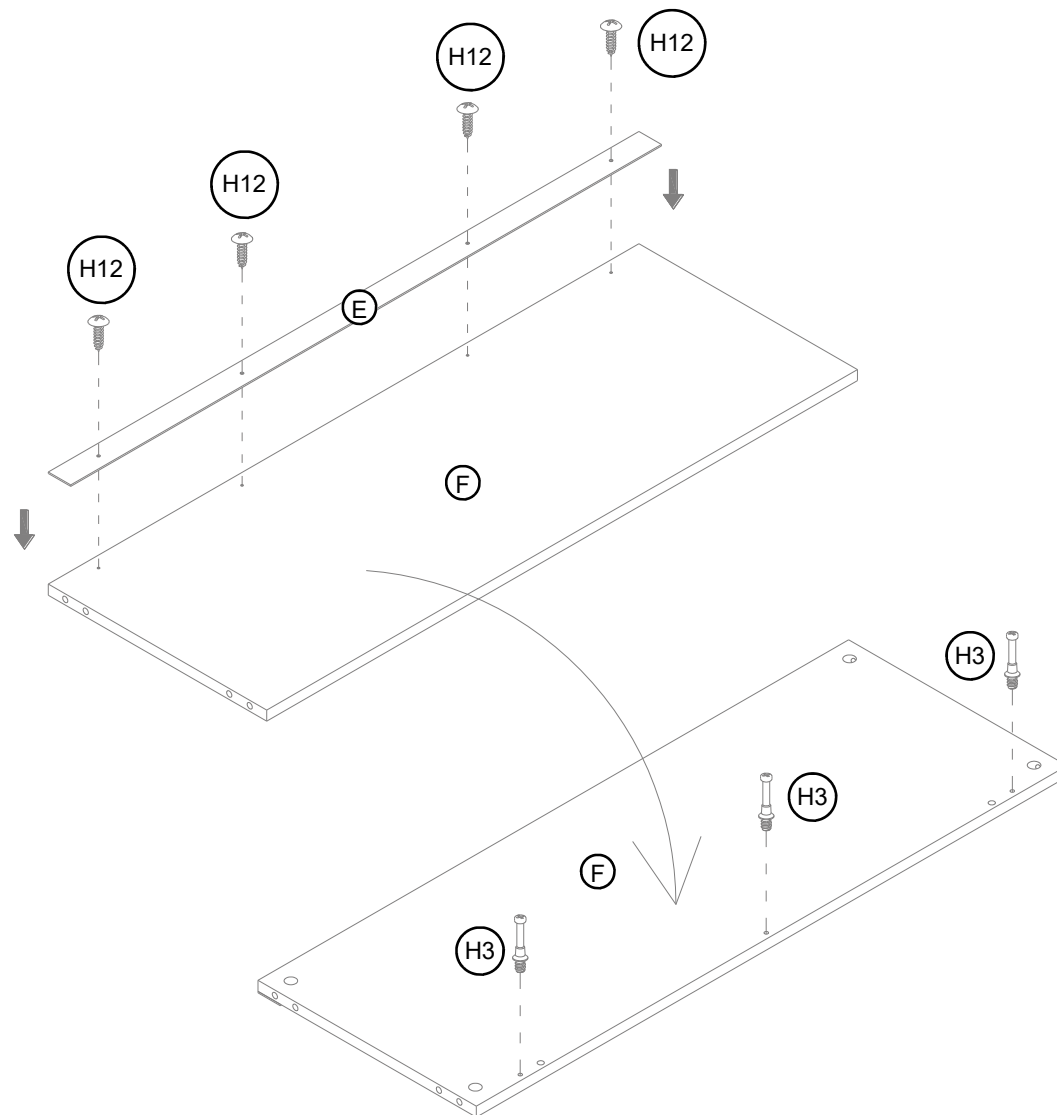
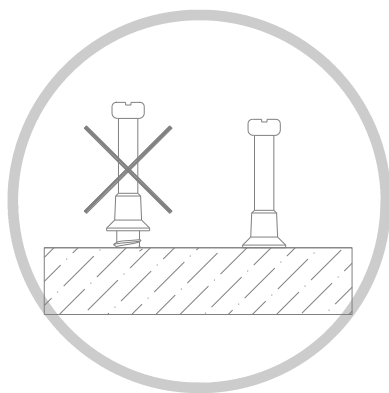

(H12) x 4
12 mm screw

(H3) x 3
cam bolt

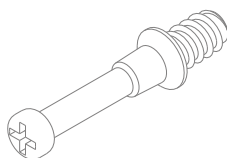
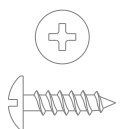

19.1. Using the pilot holes as a guide, attach the back rail (E) to the back panel (F) using 12 mm screws.

19.2. Flip around the back panel (F) and screw-in the cam bolts into the designated holes.

step 20. attach fixed shelf to back panel

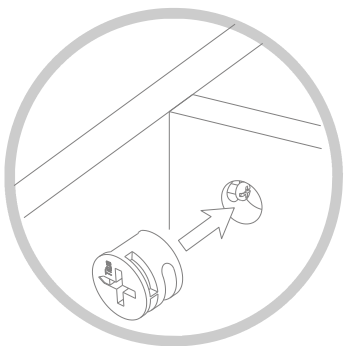

(H1) x 3
large cam lock



(H4) x 2
large wood dowel

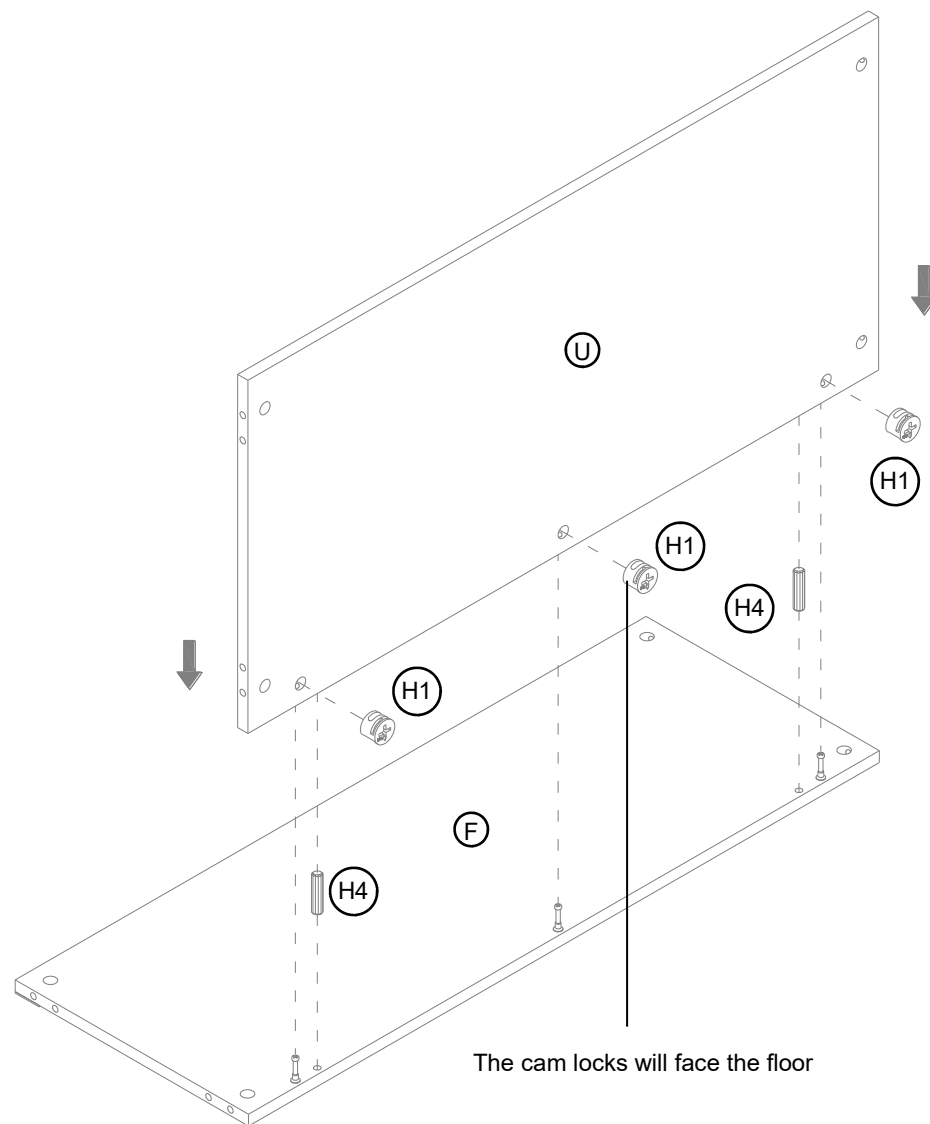

20.1. Align fixed shelf (U) to back panel (F) using two large wood dowels as a guide.

20.2. Combine the fixed shelf (U) and the back panel (F) into place by engaging three large cam locks.

step 21. attach the previous assembly between side frames

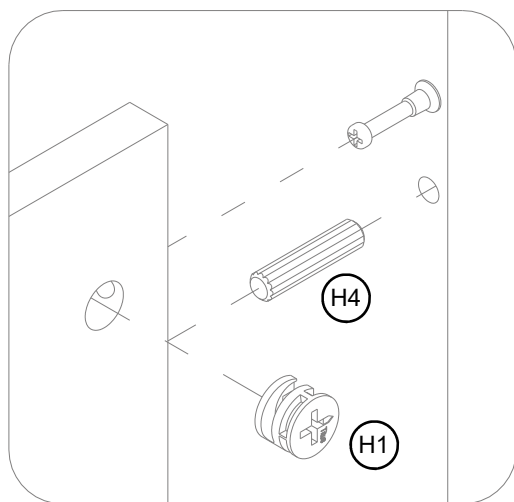

(H1) x 12
large cam lock

(H4) x 8
large wood dowel

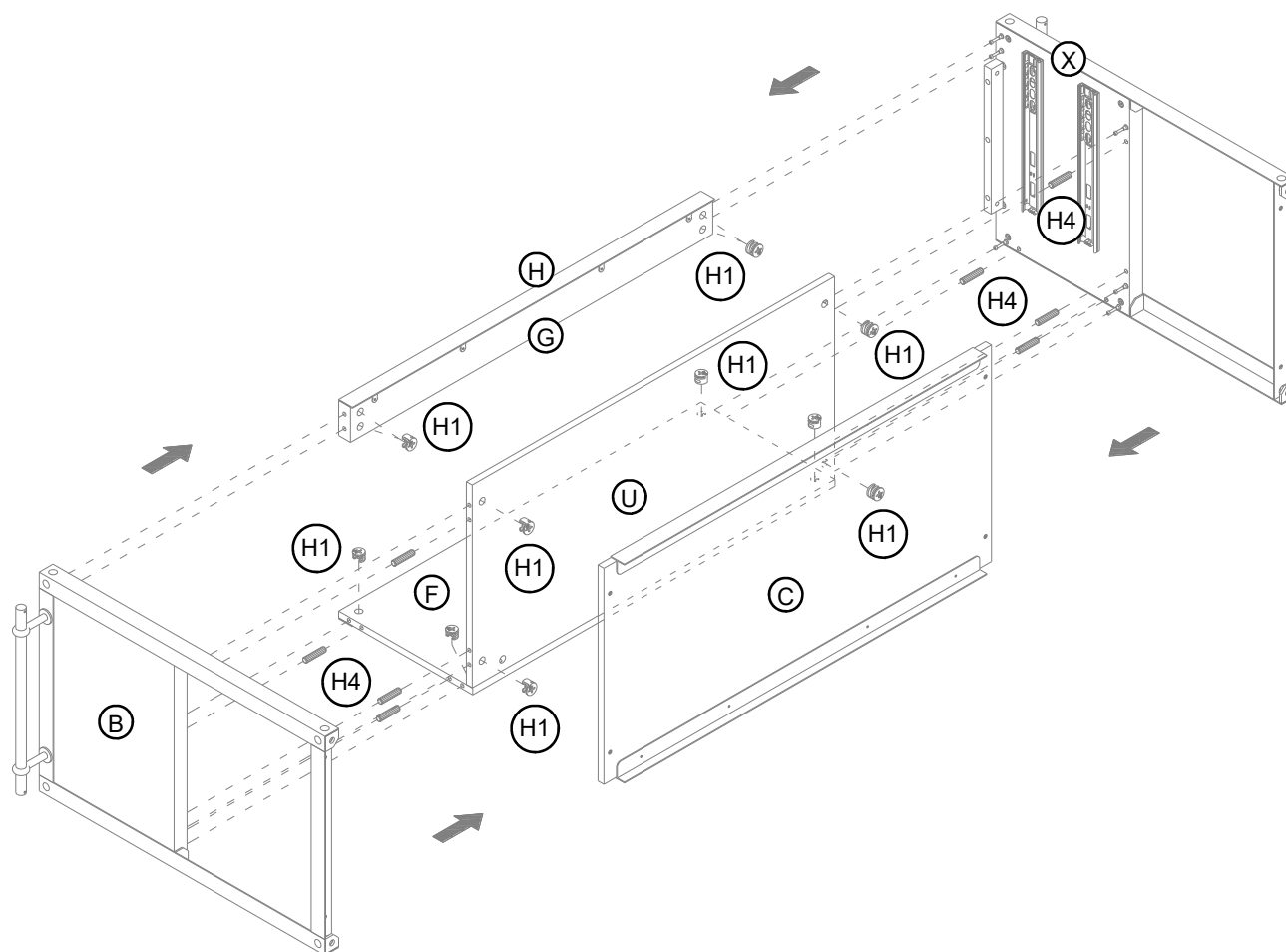
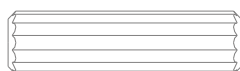
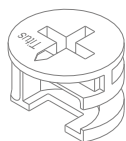

- 21.1. Align and attach fixed shelf and back panel assembly to left side frame (B) with four large wood dowels and four large cam locks.
- 21.2. Attach the front stretcher (G) to left side frame (B) by engaging two large cam locks. Be sure the front rail (H) faces the front of unit.
- 21.3. Fix the assembled bottom shelf (C) onto the bottom rail of left side frame (B) properly.
- 21.4. Repeat the same procedure to attach right side frame (X) at the opposite end.

step 22. attach bottom shelf to side frames

NOTE: DO NOT fully tighten all bolts until you finish assembling all parts. Once assembled, go back and fully tighten all bolts. This will make the assembly easier.

(H5) x 4
15 mm bolt

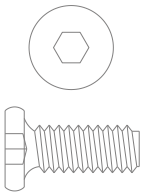

(H7) x 4
Lock washer



(H8) x 4
Fat washer

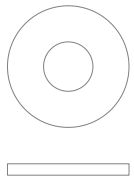

(H14) x 1
hex wrench

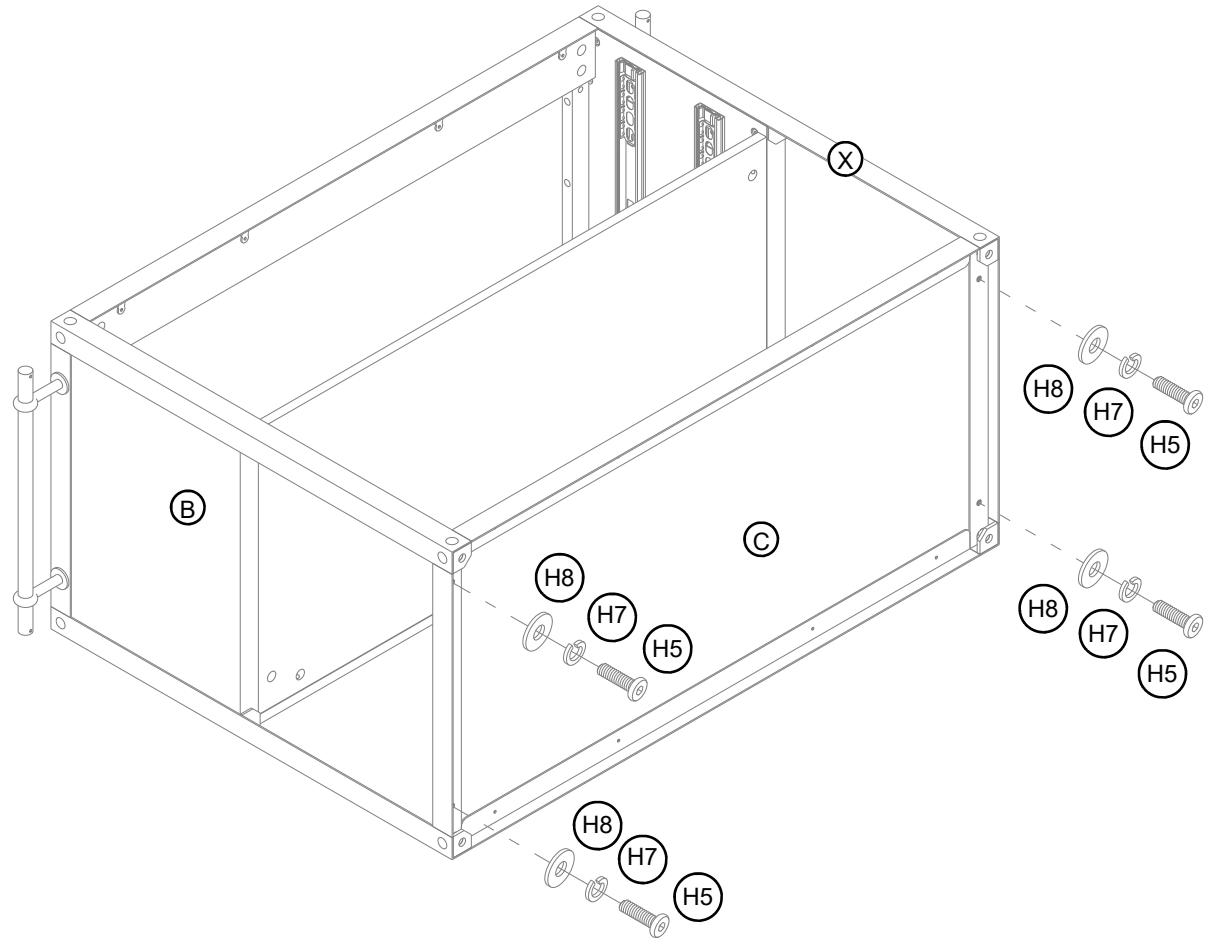

22.1. Insert 15 mm bolts with washers through the mounting holes on the bottom rails of side frames (B and X) and screw into the bottom shelf (C).

22.2. Do not over tighten the bolts.

step 23. attach top panel to the unit



NOTE: DO NOT fully tighten all bolts until you finish assembling all parts. Once assembled, go back and fully tighten all bolts. This will make the assembly easier.

(H6) x 4
30 mm bolt

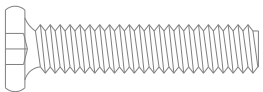

(H8) x 4
Fat washer

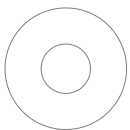

(H7) x 4
Lock washer



(H14) x 1
hex wrench

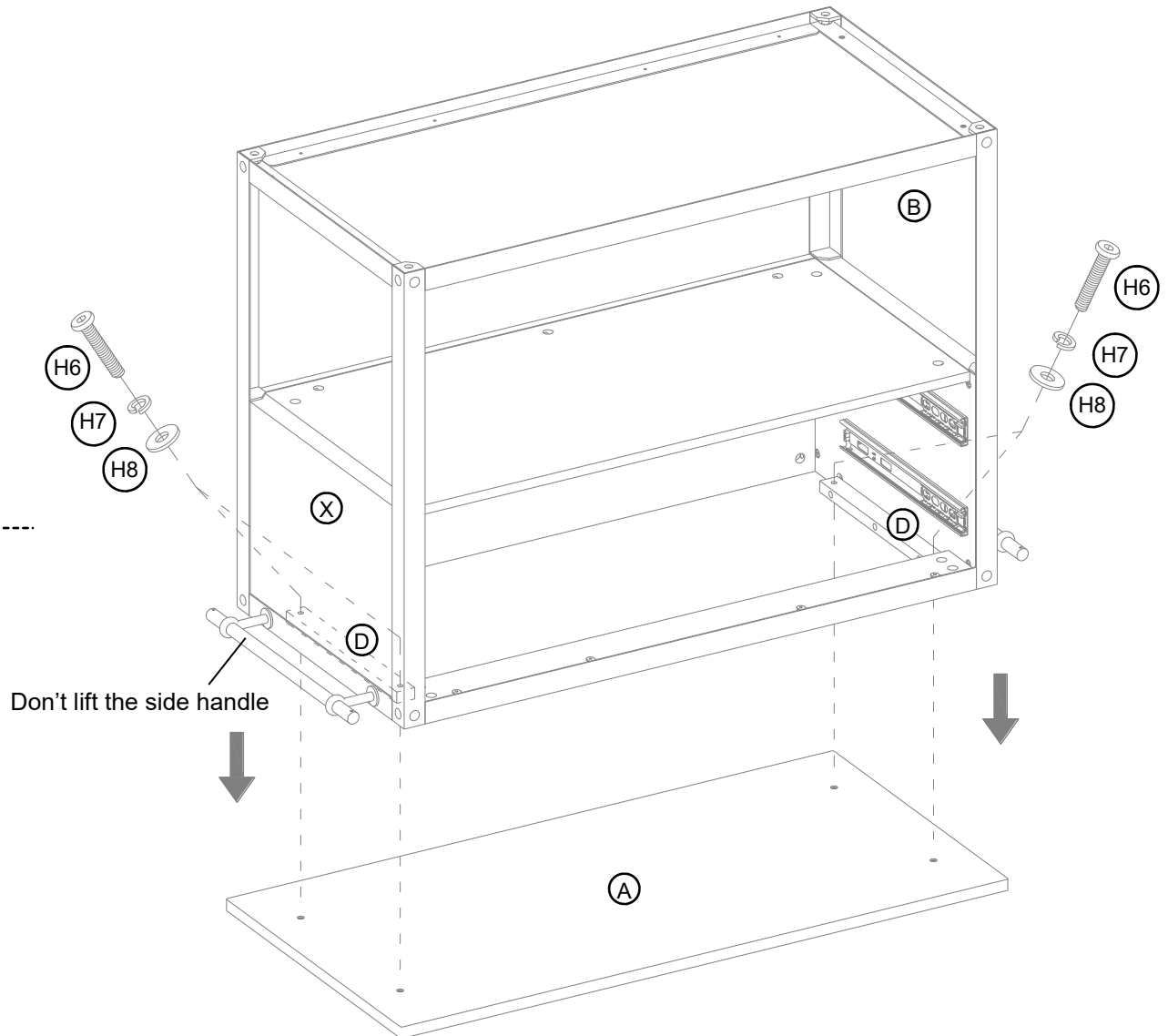

23.1. Place the top panel (A) upside down on a carpeted floor or the empty carton to avoid any scratch.

23.2. Flip over the previous assembly and align to the top panel (A) properly.

23.3. Insert 30 mm bolts with washers through the mounting holes on both side stretchers (D) and screw into the threaded insert on the top panel (A).

step 24. attach casters to side frames

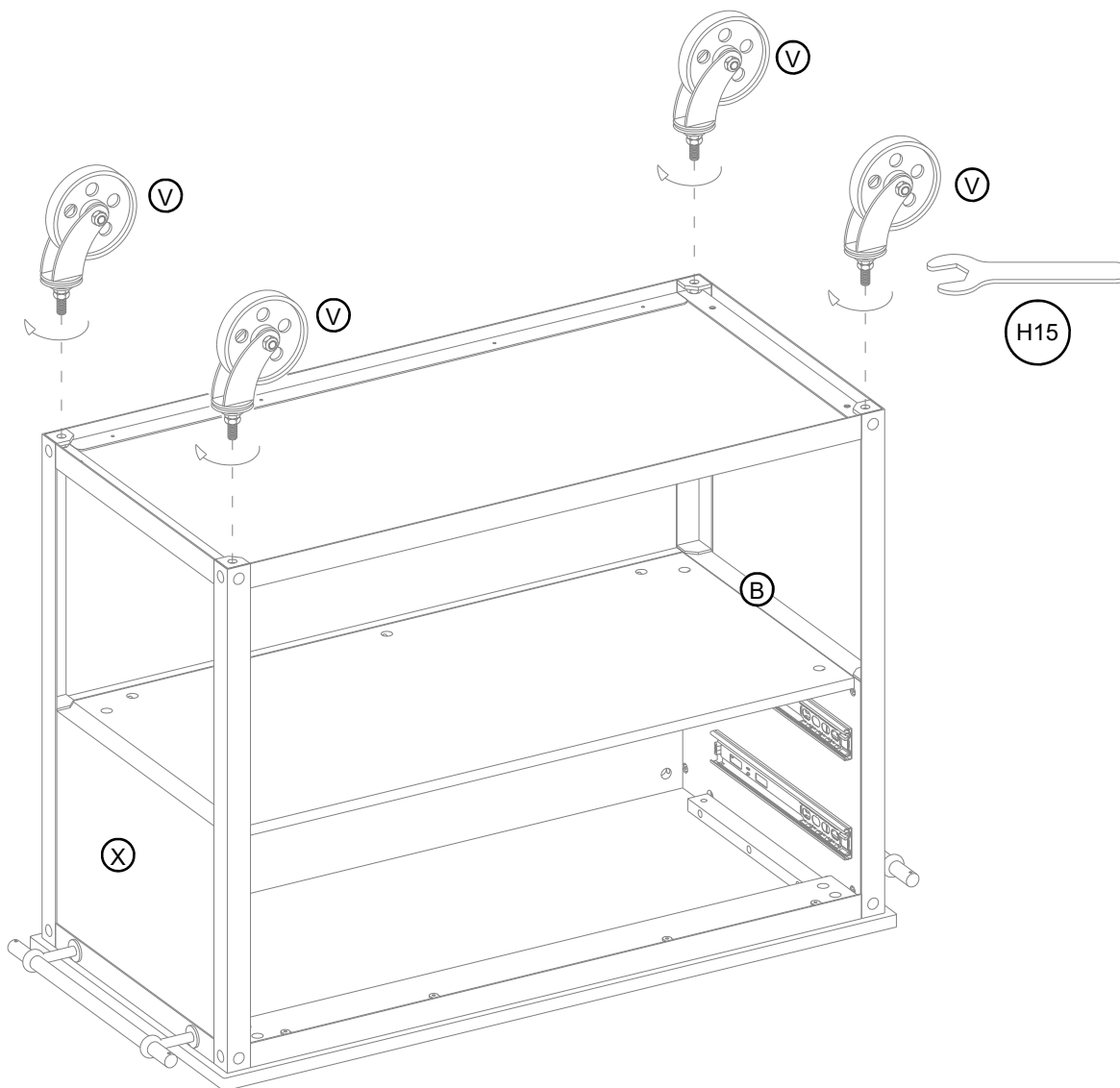

(H15) x 1
open wrench



24.1. Securely fasten the casters (V) to the bottom of side frames (B and X) using the provided open wrench.

step 25. install drawer kits to the unit

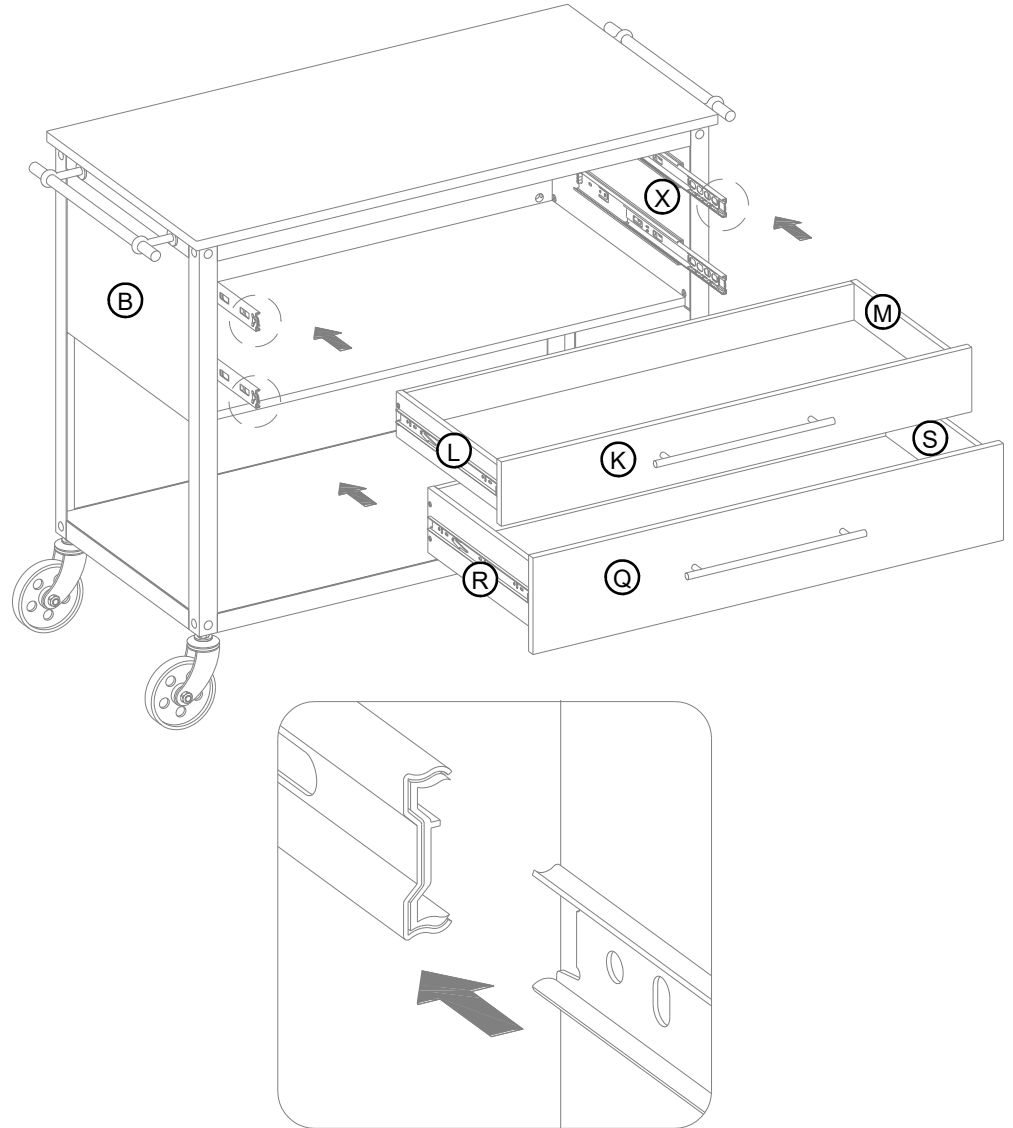
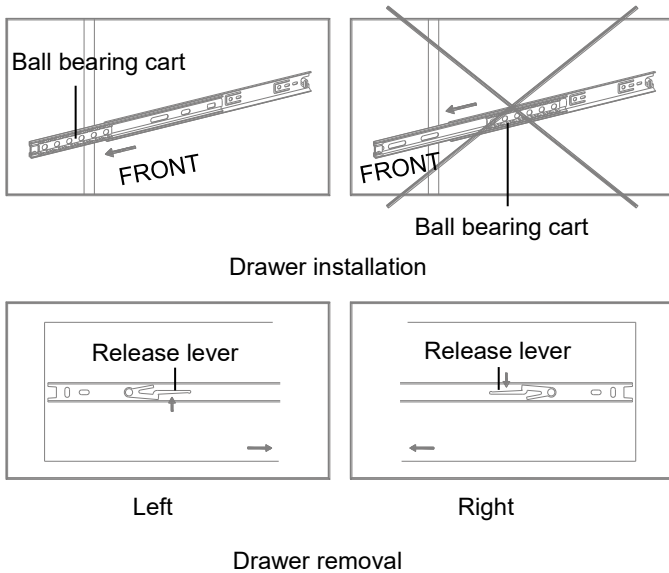

25.1. Ask for help to lift the unit upright.

25.2. To insert the assembled drawers into the frame, simply push the ball bearing cart all the way to the end of the slides (on both sides), and align the slide runners on the drawers with the slides track on the unit. Push it carefully inside until it stops.

NOTE: If the drawer does not go smoothly, please take it out and repeat the step

step 26. install the tip-over restraint hardware kits



(H16) x 2
tipping restraint hardware kit

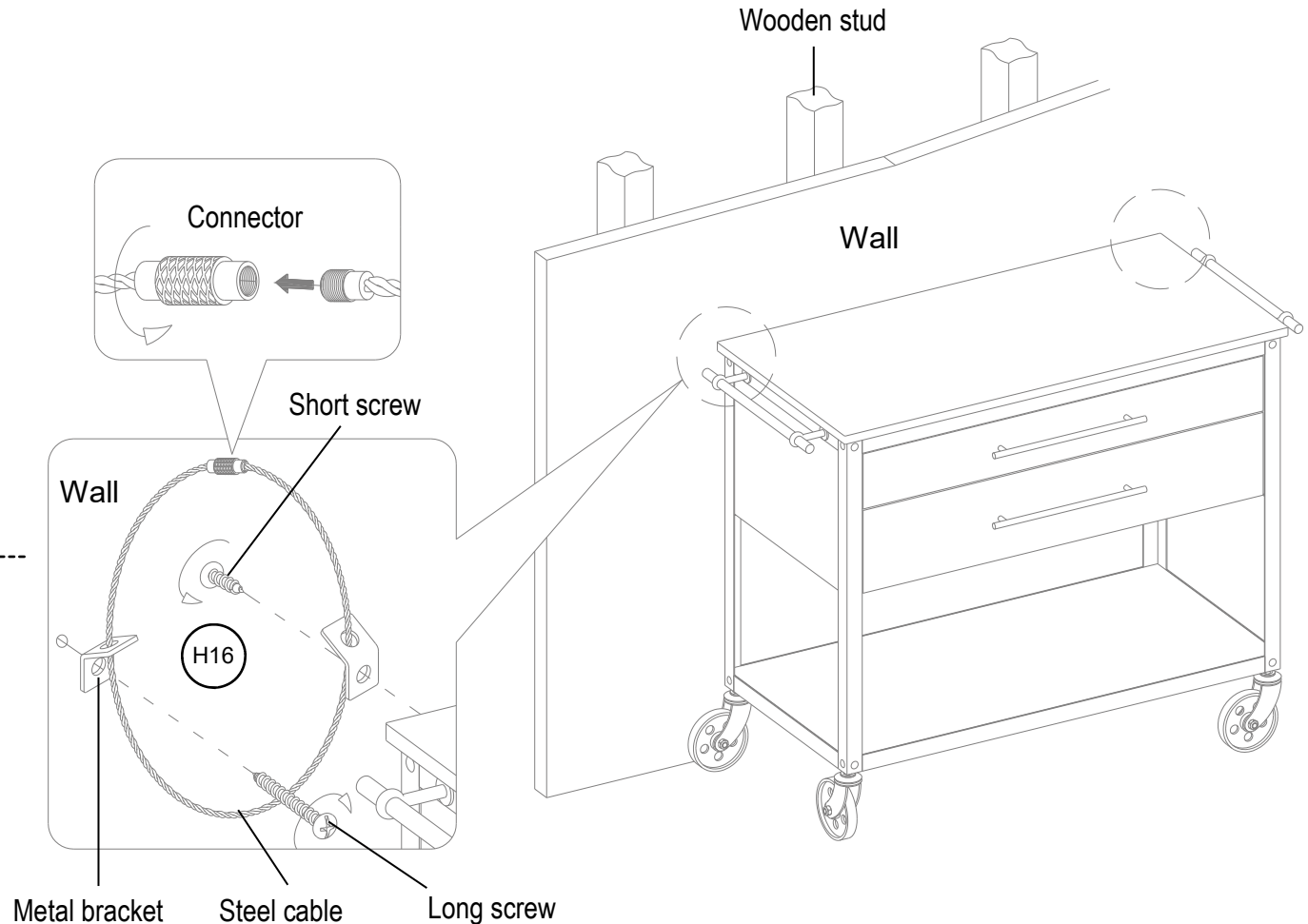
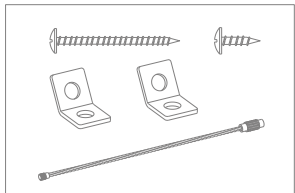

Tools required: Phillips screwdriver, stud finder, tape measure, pencil, power drill and 1/8" drill bit (not provided).

- 26.1. Position the assembled unit at the desired location against a wall and adjust the casters in different direction to prevent sliding.
- 26.2. Follow the instructions printed on plastic bag containing tipping restraint hardware to attach tip-over restraint between the unit and wall.

NOTE: You must use this tipping restraint to attach this unit to the wall, to prevent accidents and/or injuries.

Care and Maintenance

- Use a soft, clean cloth that will not scratch the surface when dusting.
- Use of furniture polish is not necessary. Should you choose to use polish, test first in an inconspicuous area.
- Using solvents of any kind on your furniture may damage the finish.
- Never use water to clean your furniture as it may cause damage to the finish.
- Always use coasters under beverage glasses and flowerpots.
- Liquid spills should be removed immediately. Using a soft, clean cloth, blot the spill gently. Avoid rubbing.
- Always use protective pads under hot dishes and plates. Heat can cause chemical changes that may create spotting within the furniture finish.
- Stains or marks from crayons or ink markers will be difficult to remove.
- In the event that your furniture is stained or otherwise damaged during use, we recommend that you call a professional to repair your furniture.
- Check bolts/screws and nuts periodically and tighten them if necessary.

Further Advice about Wood Furniture Care

It is best to keep your furniture in a climate-controlled environment. Extreme temperature and humidity changes can cause fading, warping, shrinking and splitting of wood. It is advised to keep furniture away from direct sunlight as sun may damage the finish.

Proper care and cleaning at home will extend the life of your purchase. Following these important and helpful tips will enhance your furniture as it ages.

We hope you enjoy your purchase for many years.
Thank you for your purchase!

QUALITY GUARANTEE

We are confident that you will be delighted with your Whalen Furniture purchase.

Should this product be defective in workmanship or materials or fail under normal use, we will repair or replace it for up to one (1) year from date of purchase. Every Whalen Furniture product is designed to meet your highest expectations. We guarantee that you will immediately see the value of our fine furniture.

This warranty gives you specific legal rights and you may also have other rights which vary from state to state or province to province.

Customer Service: 1-855-MYTGTHOME (855-698-4846)
8:30 a.m. - 4:30 p.m., PST, Monday to Friday
www.whalenfurniture.com

The maximum recommended weight allowance is 90.7 kg / 200 lb for top surface.

The maximum recommended weight allowance is 13.6 kg / 30 lb for drawer.

The maximum recommended weight allowance is 22.7 kg / 50 lb for shelf.

WARNING

Please use your furniture correctly and safely. Improper use can cause safety hazards, or damage to your furniture or household items. Carefully read the following safety information.

Death or serious injury may occur when children climb on audio and/or video equipment furniture. A remote control or toys placed on the furnishing may encourage a child to climb on the furnishing and as a result may tip over onto the child.

NEVER allow children to climb or play with the TV or furnishing supporting the TV.

NEVER place toys, food, remote, etc. on top of the TV or TV furnishing.

ALWAYS use either the safety hardware as instructed or other wall anchoring device.

Relocating audio and/or video equipment to furniture not specifically designed to support audio and/or video equipment may result in death or serious injury due to furniture collapse or over turning onto a child.

NEVER place a TV on furniture that is not intended to support a TV.

NEVER exceed the maximum size and weight of the TV shown in the instructions.

Be sure to refer to the TV warning label as shown in the instructions.

Overloading drawers and shelves may result in furniture that can break or sag, or tip-over which may result in injury.

NEVER exceed the weight limits shown in the instructions.

Place the heavier items on lower shelves as far back from the front as possible.

Load the bottom surfaces first to avoid top-heavy furniture.

Moving furniture that is not designed to be moved or equipped with casters may result in injury or damage to furnishings or personal property.

ALWAYS unload shelves and drawers, starting with the top surfaces, before moving.

NEVER push or pull furniture on carpet. Have a friend help lift properly to move and/or reposition it.

The unit is not meant as a seat and no one should be sitting or standing on the top panel.