

THRESHOLD™

LOOKS LIKE
HOME



FEELS LIKE
YOU

2-Drawer File Cabinet

Style # TGT15FC

DPC-item #: 081-07-7161



>> [Assembly instructions](#)



Congratulations on your latest Target purchase.

Now what? Don't start sweating over this box of parts. This will be easy. We did the hard work for you. All you need to do is follow our simple instructions and you'll be on your way to transforming your room in no time. Good luck – though we're confident you won't need it.

before you begin

1. Check for damaged or missing parts. Call 1-855-MYTGTHOME (855-698-4846) to order missing supplies.
2. Use the carton as a work surface to prevent product damage during assembly.
3. Gather all tools prior to assembly.



BEFORE YOU BEGIN

Scan for easy 3D instructions

BILT
Download on the App Store | GET IT ON Google Play

tool needed (only hex wrench included)

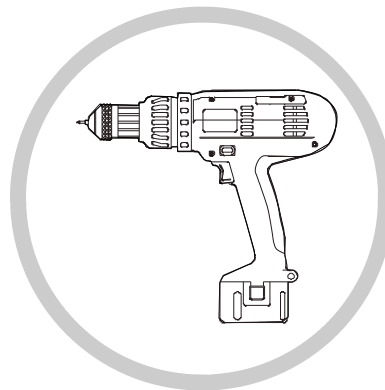
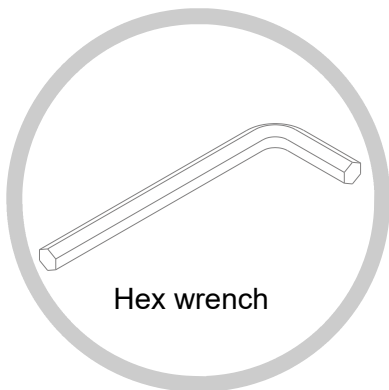

For tipping restraint hardware kit only.

hardware

(H1) x 18
large cam lock



(H2) x 8
small cam lock



(H3) x 26
cam bolt

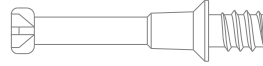

(H4) x 8
M6 x 30 mm wood dowel



(H5) x 18
M8 x 30 mm wood dowel

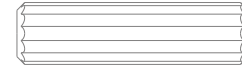

(H6) x 8
1/4" x 45 mm bolt

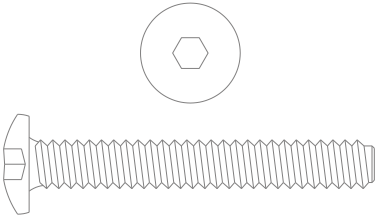

(H7) x 8
lock washer



(H8) x 8
flat washer

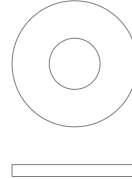

(H9) x 8
M4 x 32 mm screw

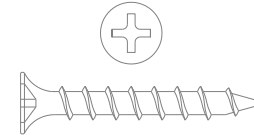

(H10) x 4
22 mm handle bolt

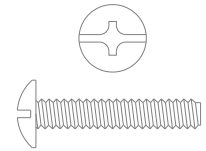

(H11) x 2
handle

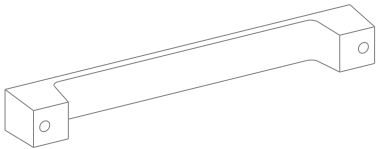

(H12) x 1
hex wrench

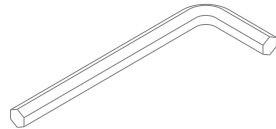

(H13) x 1
tipping restraint hardware kit
(inside plastic bag)

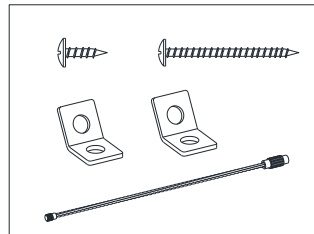

Spare hardware

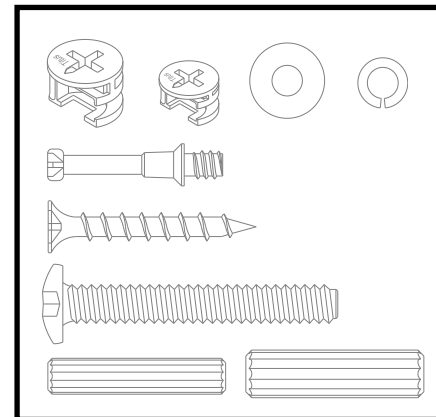

exploded diagram

| ITEM | DESCRIPTION | QTY |
|------|---------------------------------|-----|
| A | Top panel | 1 |
| B | Left side panel | 1 |
| C | Right side panel | 1 |
| D | Back panel | 1 |
| E | Bottom panel | 1 |
| F | Utility drawer front panel | 1 |
| G | Utility drawer back panel | 1 |
| H | Utility drawer left side panel | 1 |
| I | Utility drawer right side panel | 1 |
| J | Utility drawer bottom panel | 1 |
| K | Front crossbar | 1 |
| L | File drawer front panel | 1 |
| M | File drawer back panel | 1 |
| N | File drawer left side panel | 1 |
| O | File drawer right side panel | 1 |
| P | File drawer bottom panel | 1 |
| Q | Guide rail | 2 |
| R | File hanger | 2 |
| S | Foot | 4 |

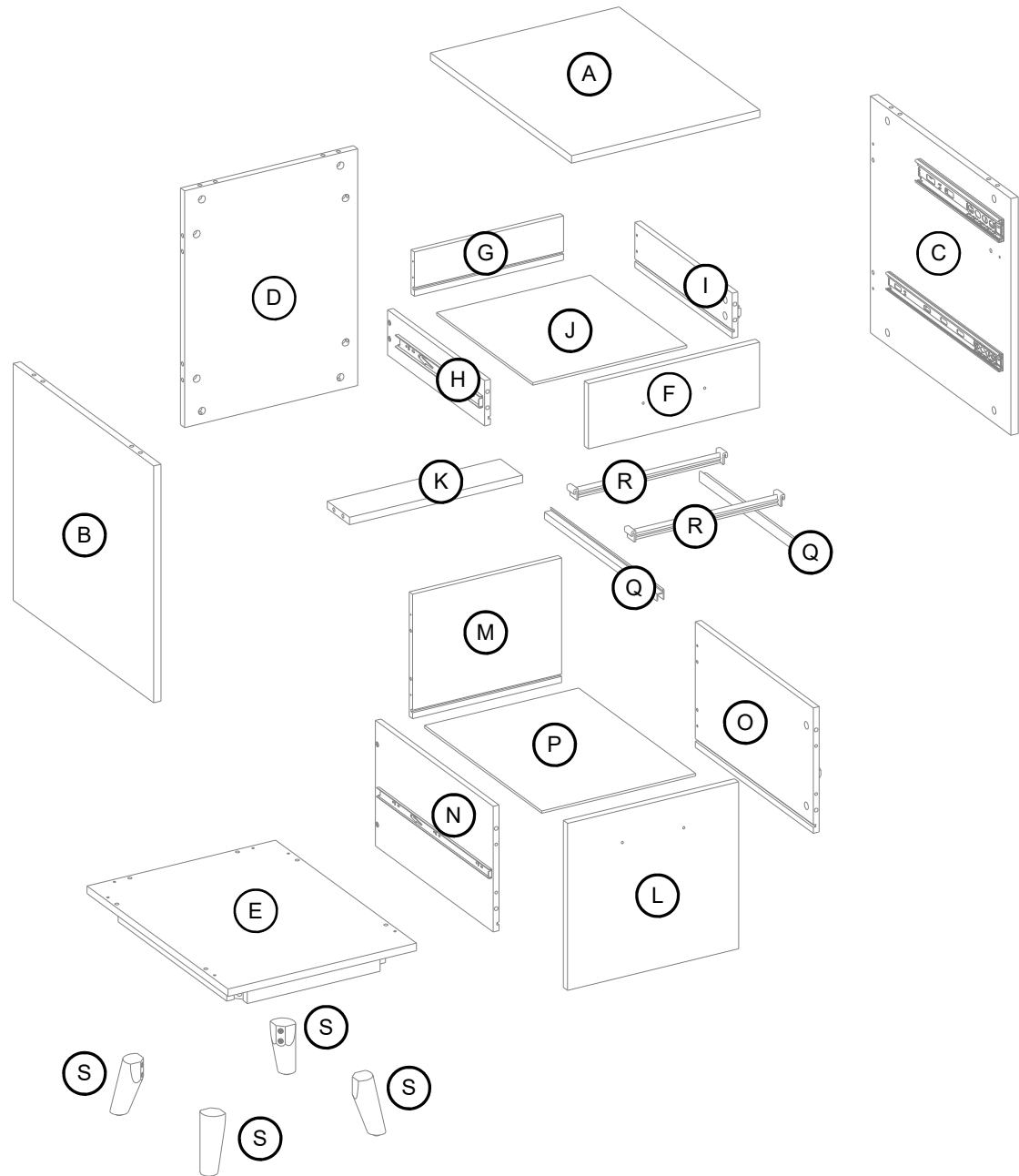

how to use the cam lock system

1.

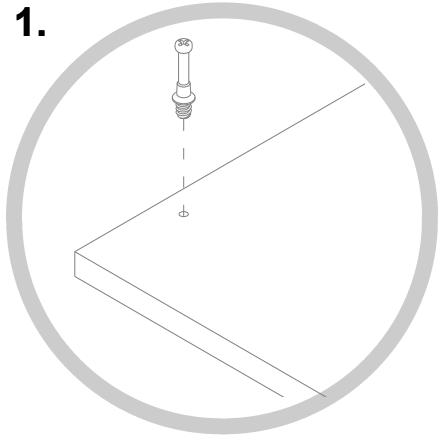

Screw cam bolt into panel

2.

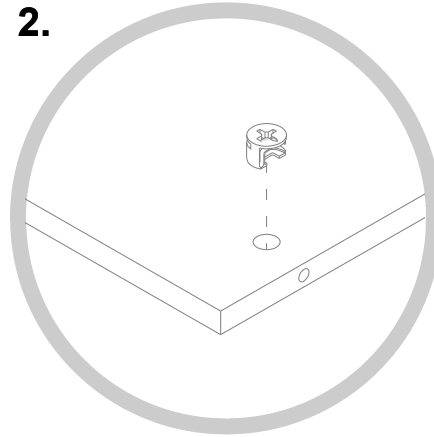

Push cam into panel - arrow feature on cam top points to panel edge

3.

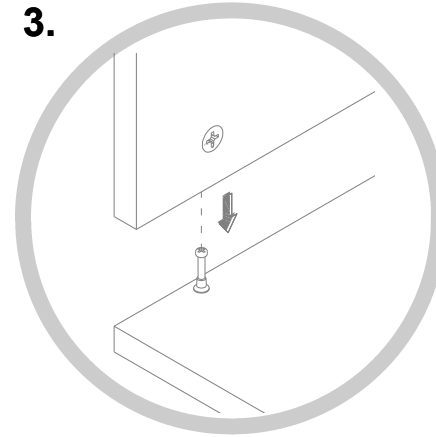

Align cam bolt(s) with cam(s) and insert all the way into cross-bored hole(s)

4.

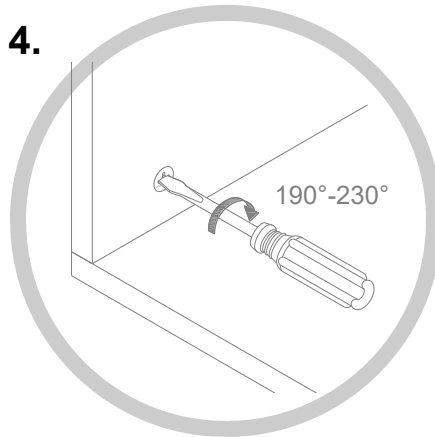

Rotate cam(s) clockwise 190°-230° to lock panels together

5.

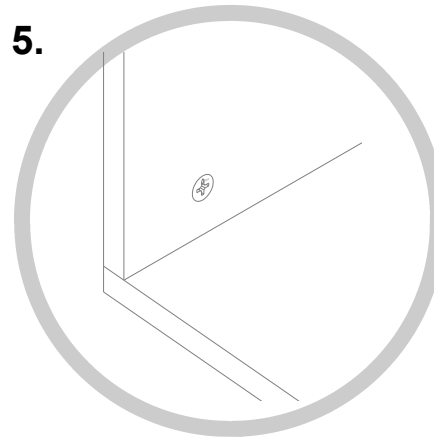

Panels should be tight against each other and connection should be rigid

step 1: prepare drawers assembly

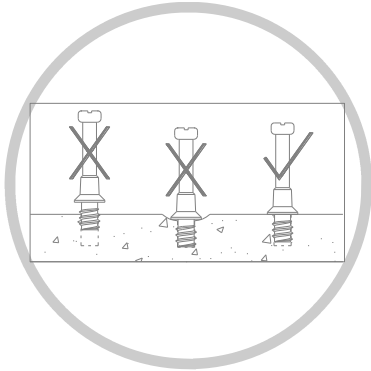

NOTE: Screw-in cam bolts must be screwed down flush.

(H3) x 8
cam bolt

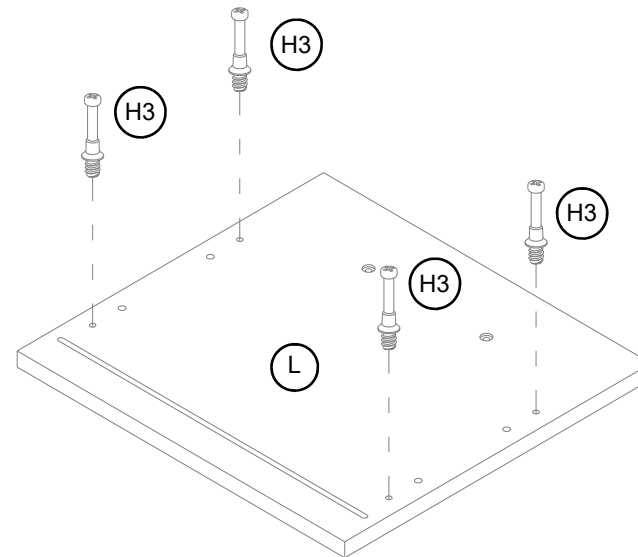
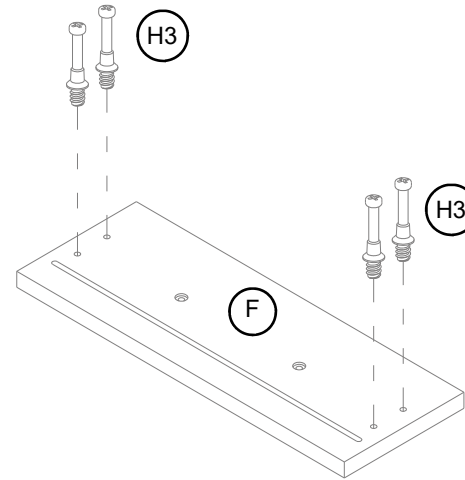
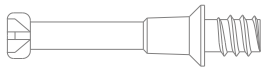

1.1. Securely screw the cam bolts (H3) into the designated small holes on the drawer front panels (F and L).

step 2: attach the utility drawer side panels

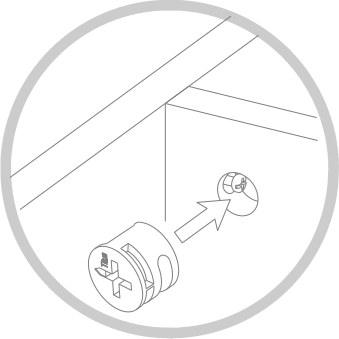

(H2) x 4
small cam lock

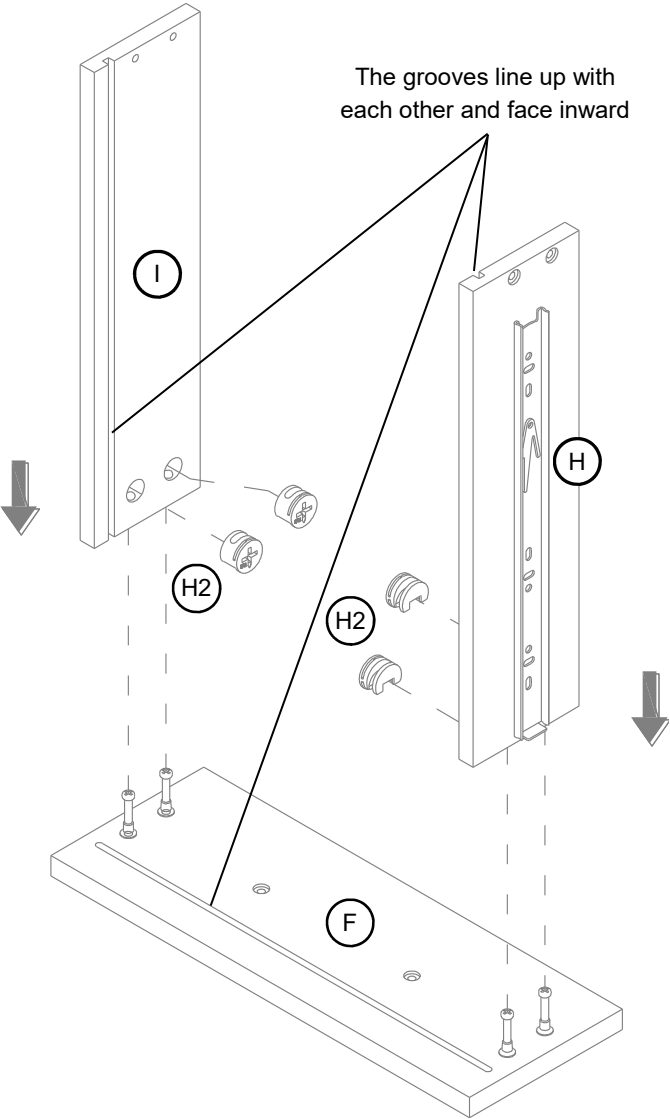

2.1. Attach the utility drawer side panels (H and I) to the utility drawer front panel (F) with four small cam locks (H2).

step 3: install the utility drawer bottom panel

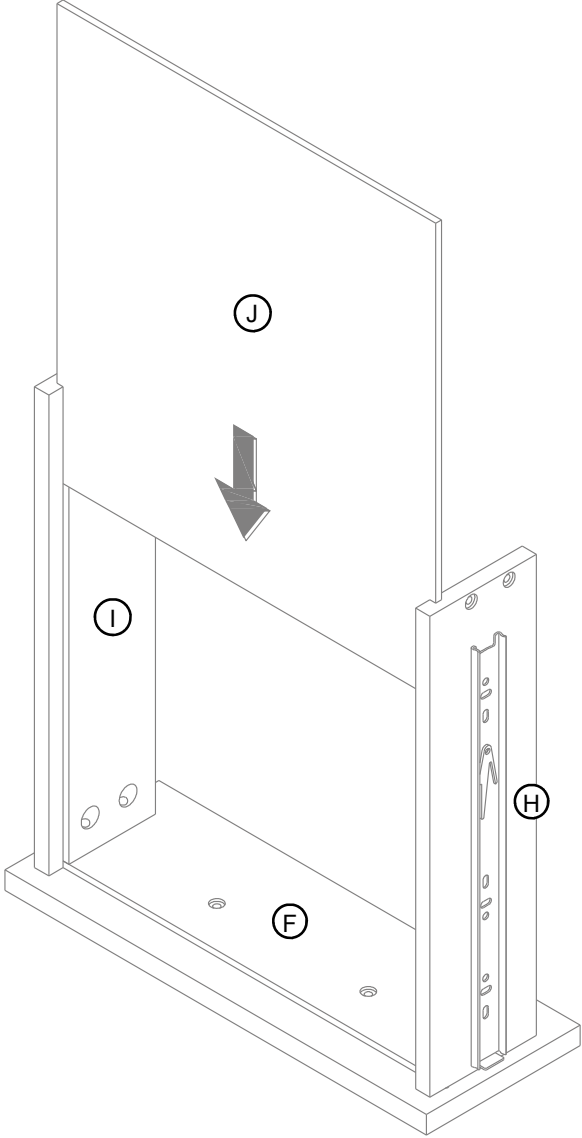

3.1. Slide the utility drawer bottom panel (J) into the grooves between the drawer side panels (H and I) until fully inserted into the groove of the drawer front panel (F).

step 4: fasten the utility drawer back panel

NOTE: Make sure that the drawer bottom panel (J) fits securely into the groove of the drawer back panel (G). DO NOT use power tools.

(H9) x 4
M4 x 32 mm screw

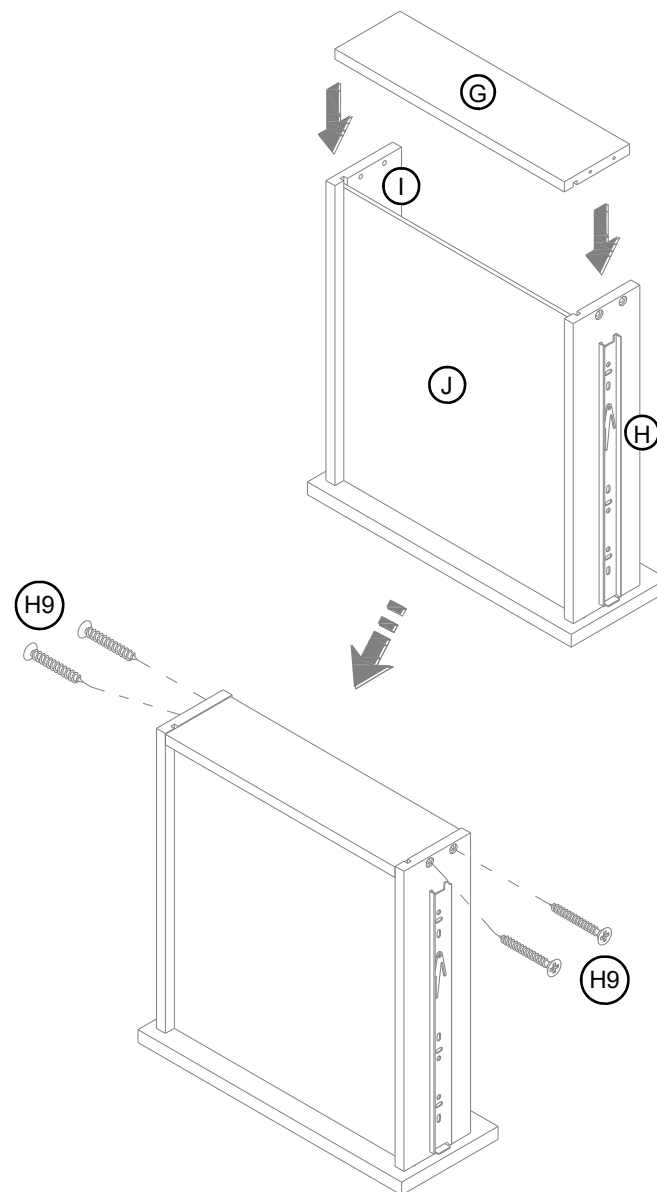
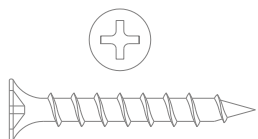

4.1. Fasten the utility drawer back panel (G) to both utility drawer side panels (H and I) with four 32 mm screws (H9).

step 5: install the utility drawer handle

(H10) x 2
22 mm handle bolt

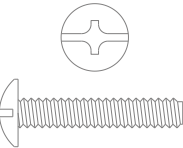

(H11) x 1
handle

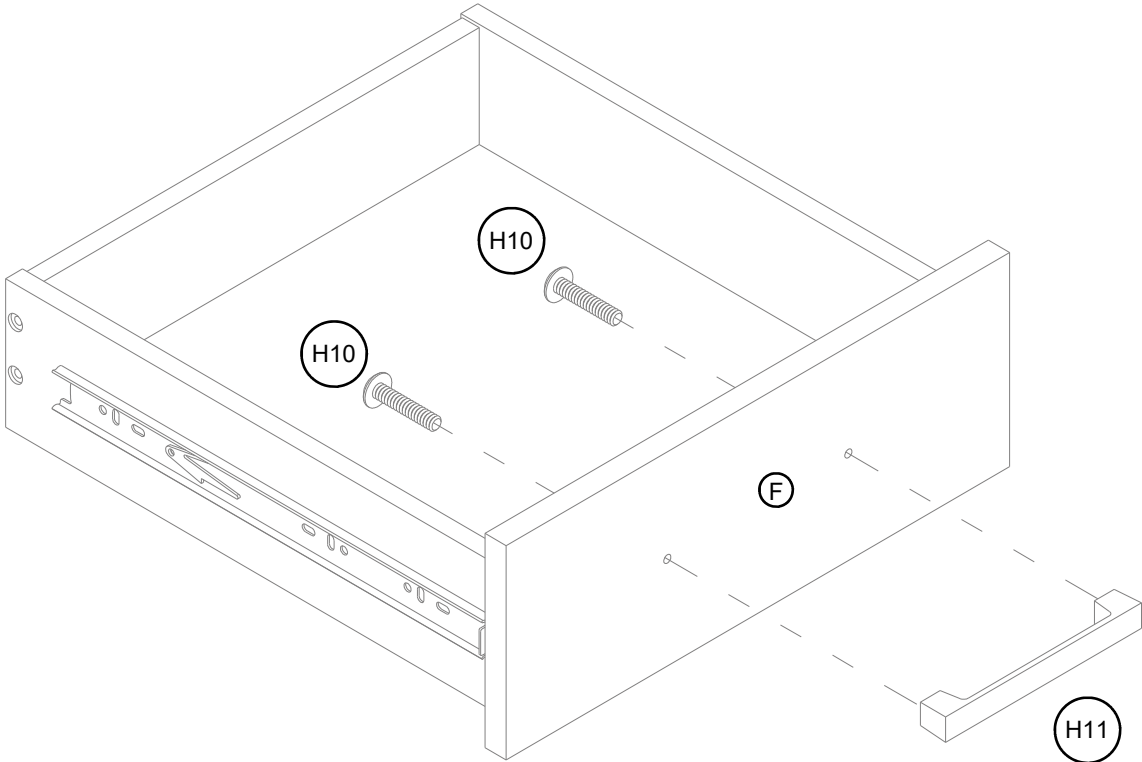
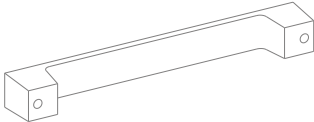

5.1. Fasten one handle (H11) to the front side of the utility drawer front panel (F) with two 22 mm handle bolts (H10).

step 6: attach the file drawer side panels

NOTE: DO NOT use power tools.

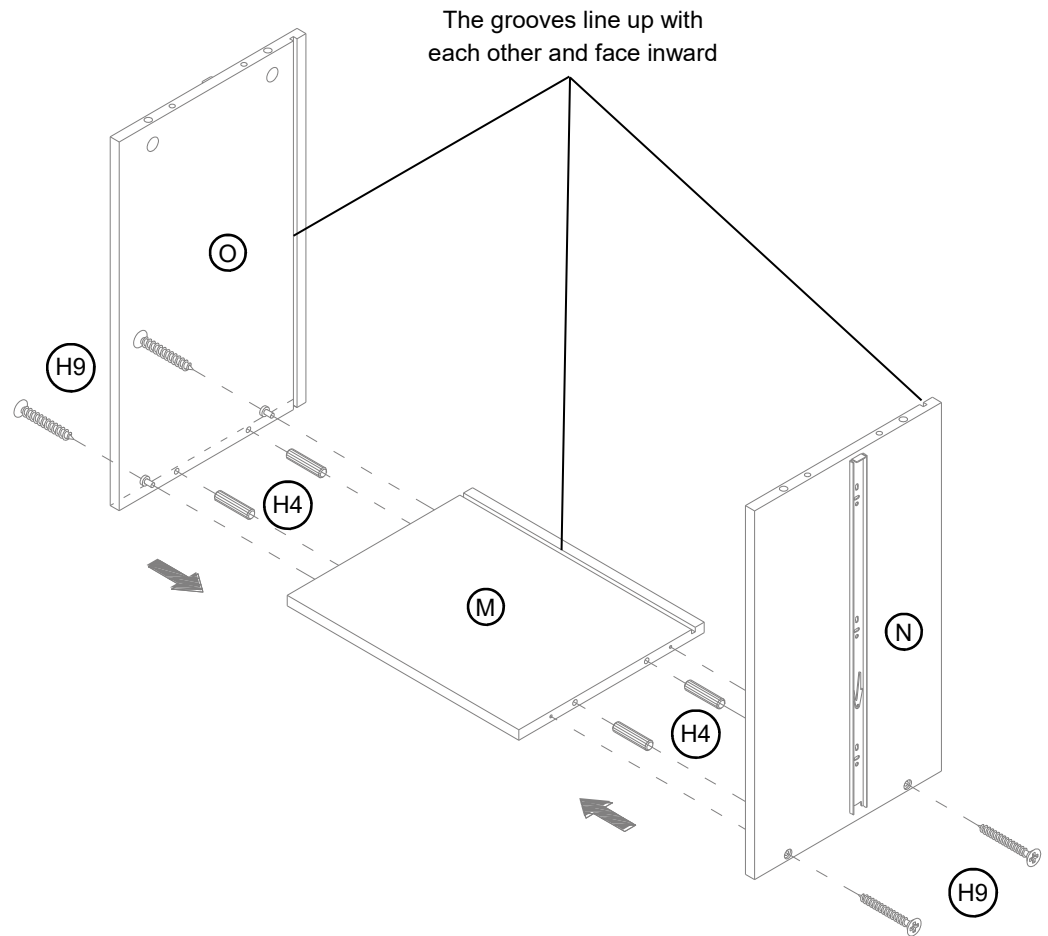
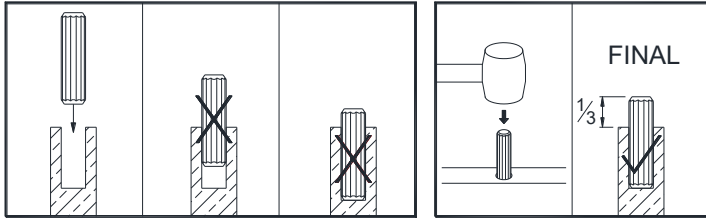

(H4) x 4
M6 x 30 mm wood dowel



(H9) x 4
M4 x 32 mm screw

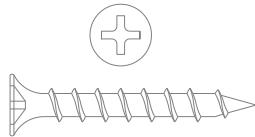

- 6.1. Insert four small wood dowels (H4) into the inner holes of the file drawer back panel (M) at both ends.
- 6.2. Align and attach the file drawer side panels (N and O) to the file drawer back panel (M) with four 32 mm screws (H9).

step 7: install the file drawer bottom panel

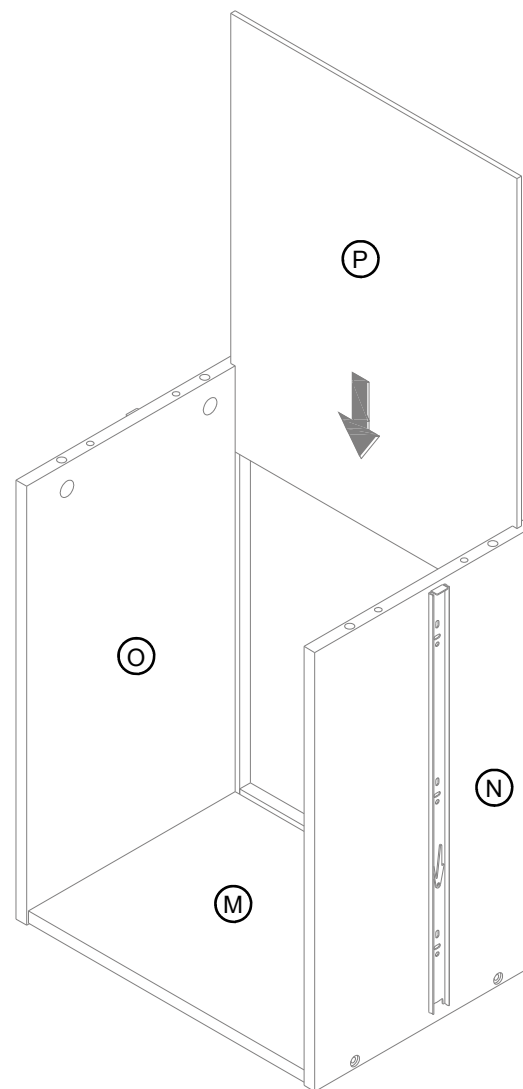

7.1. Slide the file drawer bottom panel (P) into the grooves between the drawer side panels (N and O) until fully inserted into the groove of the drawer back panel (M).

step 8: attach the file drawer front panel

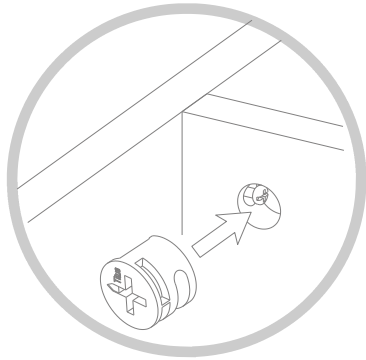

(H2) x 4
small cam bolt



(H4) x 4
M6 x 30 mm wood dowel

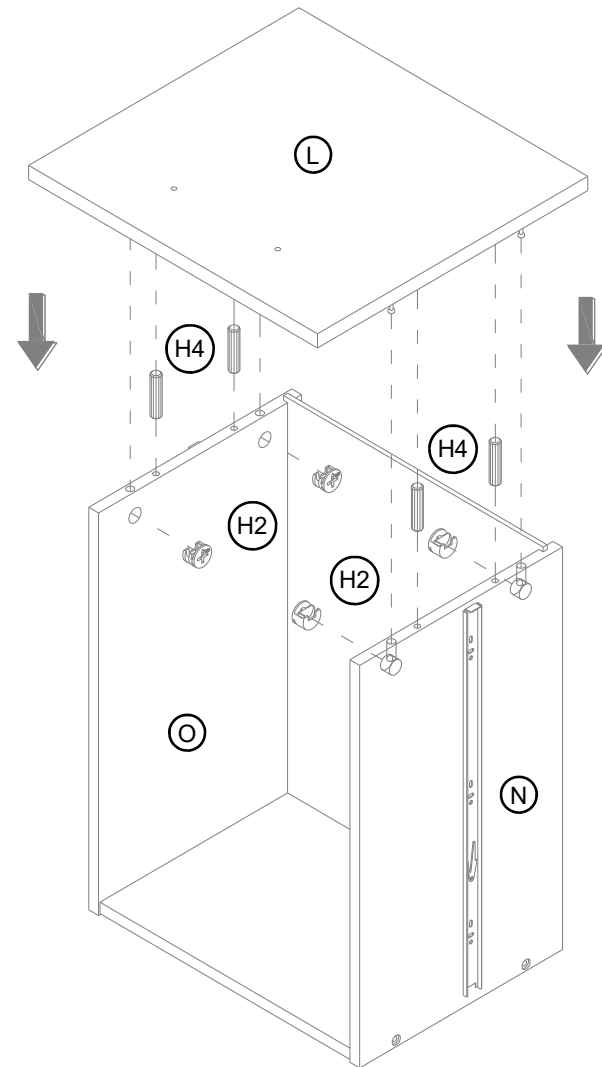

- 8.1. Insert four small wood dowels (H4) into the inner holes on the two file drawer side panels (N and O).
- 8.2. Align and attach the file drawer front panel (L) to the file drawer side panels (N and O) with four small cam bolts (H2).

step 9: install the file drawer handle

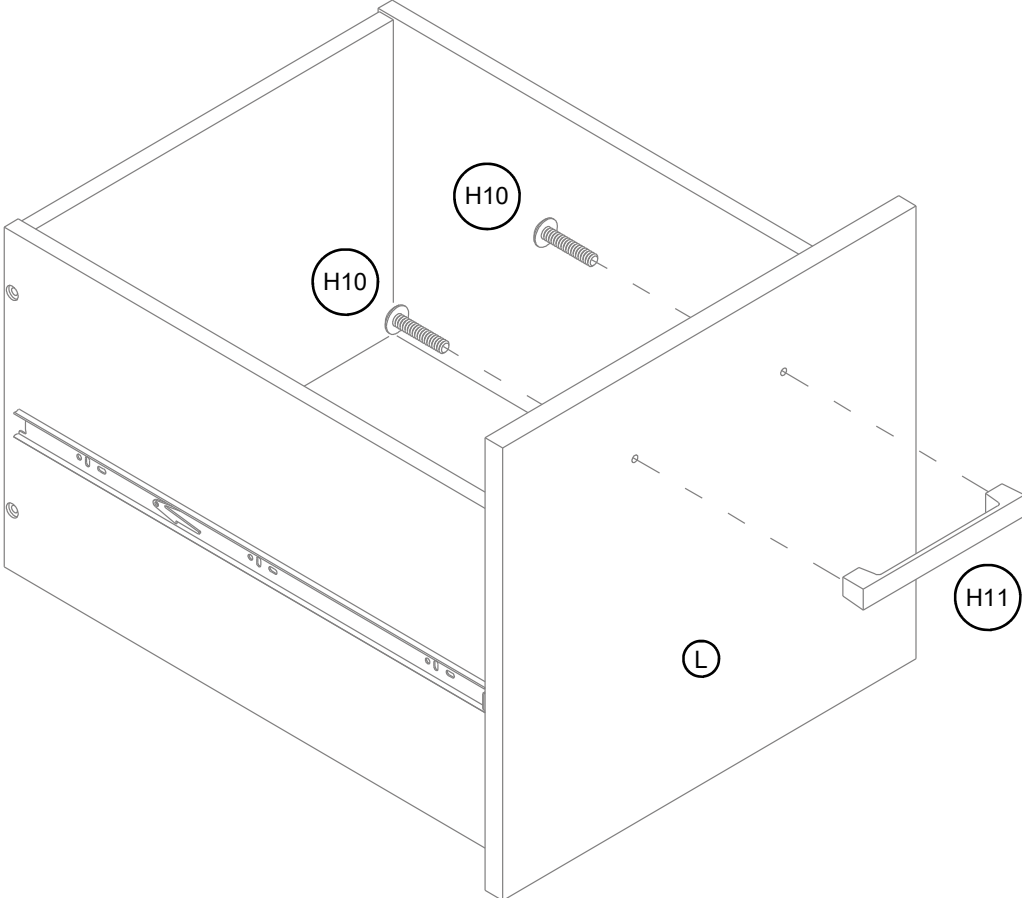

(H10) x 2
22 mm handle bolt

(H11) x 1
handle

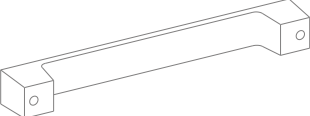
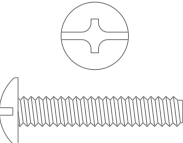

9.1. Fasten the other handle (H11) to the front side of the file drawer front panel (L) with two 22 mm handle bolts (H10).

step 10: position the guide rails and file hangers

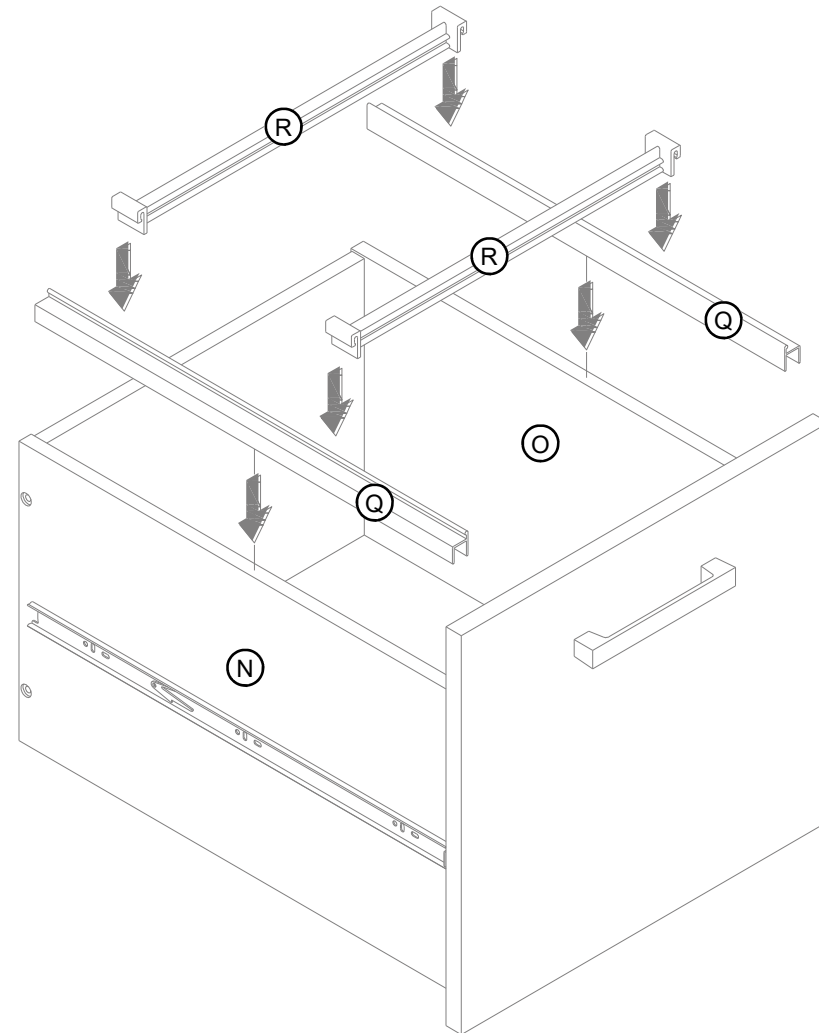

10.1. Position the guide rails (Q) onto the file drawer side panels (N and O) with the high side facing inward.

10.2. Hook the guide blocks of the file hangers (R) onto the high edge of the guide rails (Q). Slide the file hanger forward and backward to keep hanging files organized.

step 11: attach the feet

NOTE: DO NOT fully tighten all the bolts until you adjusted to even all the feet.

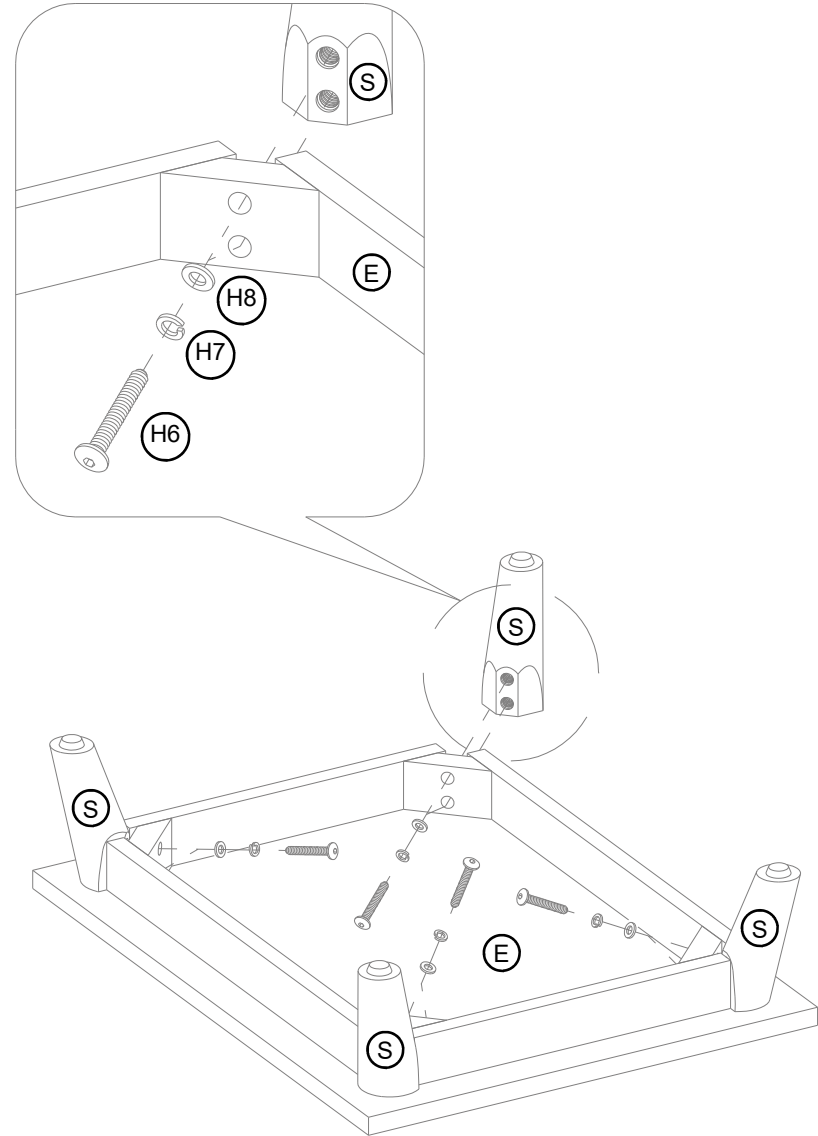

(H6) x 8
1/4" x 45 mm bolt

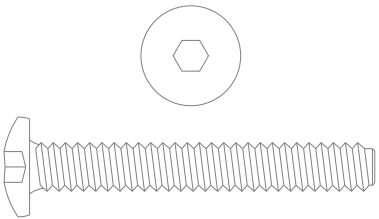

(H7) x 8
lock washer



(H8) x 8
flat washer

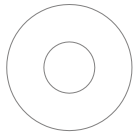

(H12) x 1
hex wrench

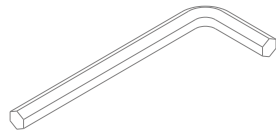

11.1. Attach four feet (S) to the bottom corners of the bottom panel (E) with eight 45 mm bolts (H6), eight lock washers (H7) and eight flat washers (H8).

step 12: prepare top panel and base assembly

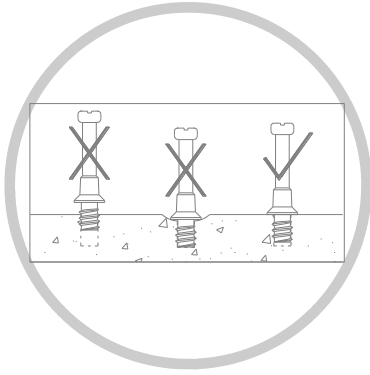

NOTE: Screw-in cam bolts must be screwed down flush.

(H3) x 12
cam bolt

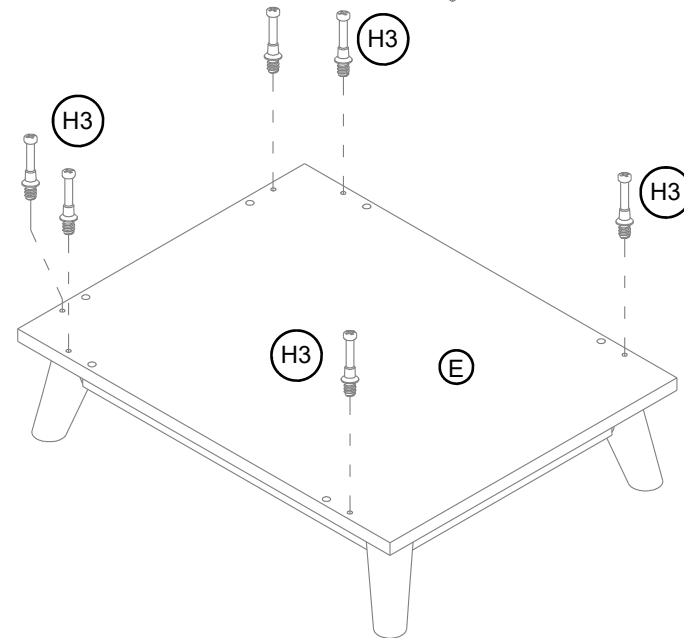
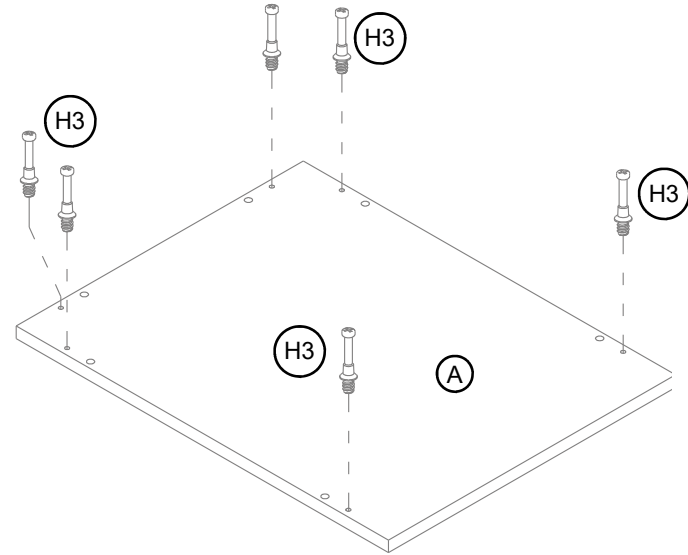
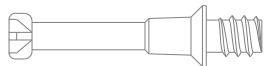

12.1. Securely screw the cam bolts (H3) into the designated small holes on the top panel (A) and bottom panel (E).

step 13: prepare side panels assembly

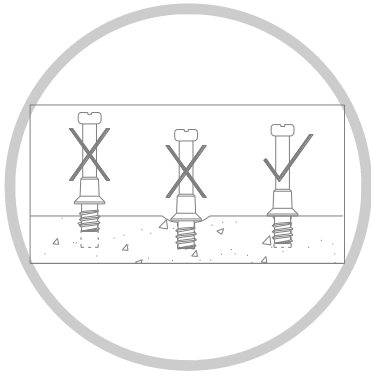

NOTE: Screw-in cam bolts must be screwed down flush.

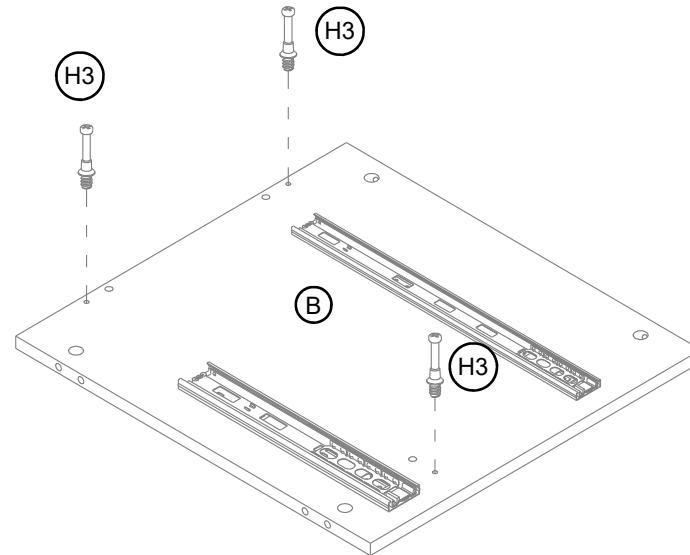

(H3) x 6
cam bolt

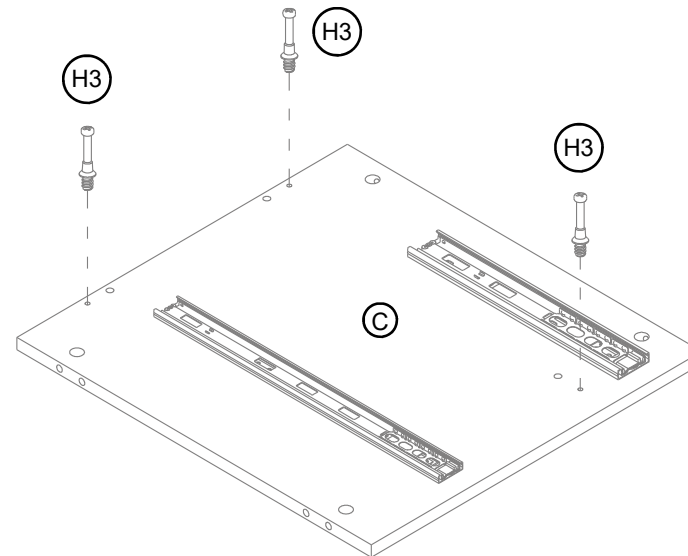
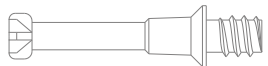

13.1. Securely screw the cam bolts (H3) into the designated small holes on the side panels (B and C).

step 14: install file cabinet frame

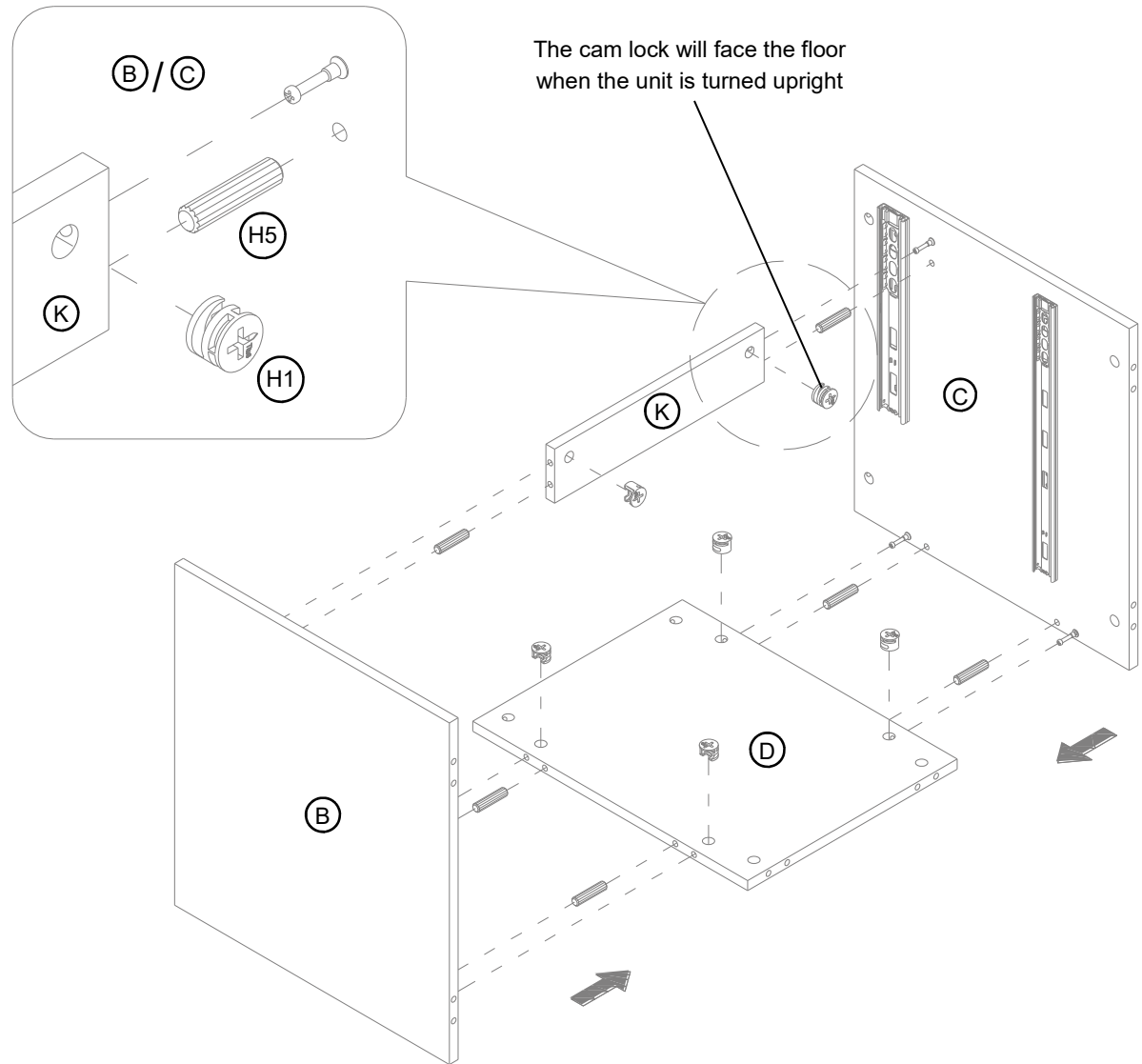
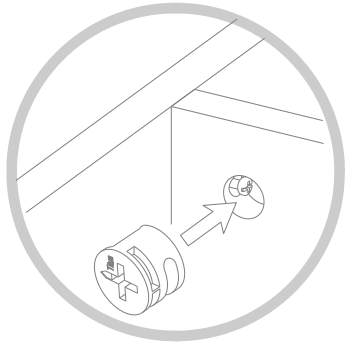

(H1) x 6
large cam lock



(H5) x 6
M8 x 30 mm wood dowel

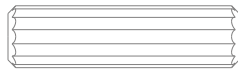

- 14.1. Insert four large wood dowels (H5) into the inner holes of the back panel (D) at both long ends.
- 14.2. Align and attach the left side panel (B) to the back panel (D) by engaging two large cam locks (H1).
- 14.3. Insert one large wood dowel (H5) into the end hole of front crossbar (K) and attach it to the left side panel (B) using one large cam lock (H1).
- 14.4. Repeat the same process to install the right side panel (C).

step 15: attach the top panel

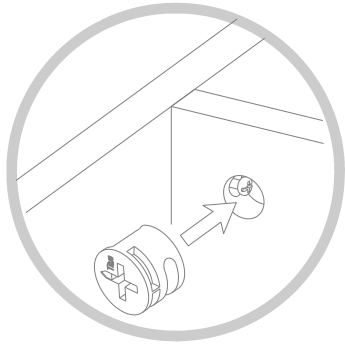

(H1) x 6
large cam lock



(H5) x 6
M8 x 30 mm wood dowel

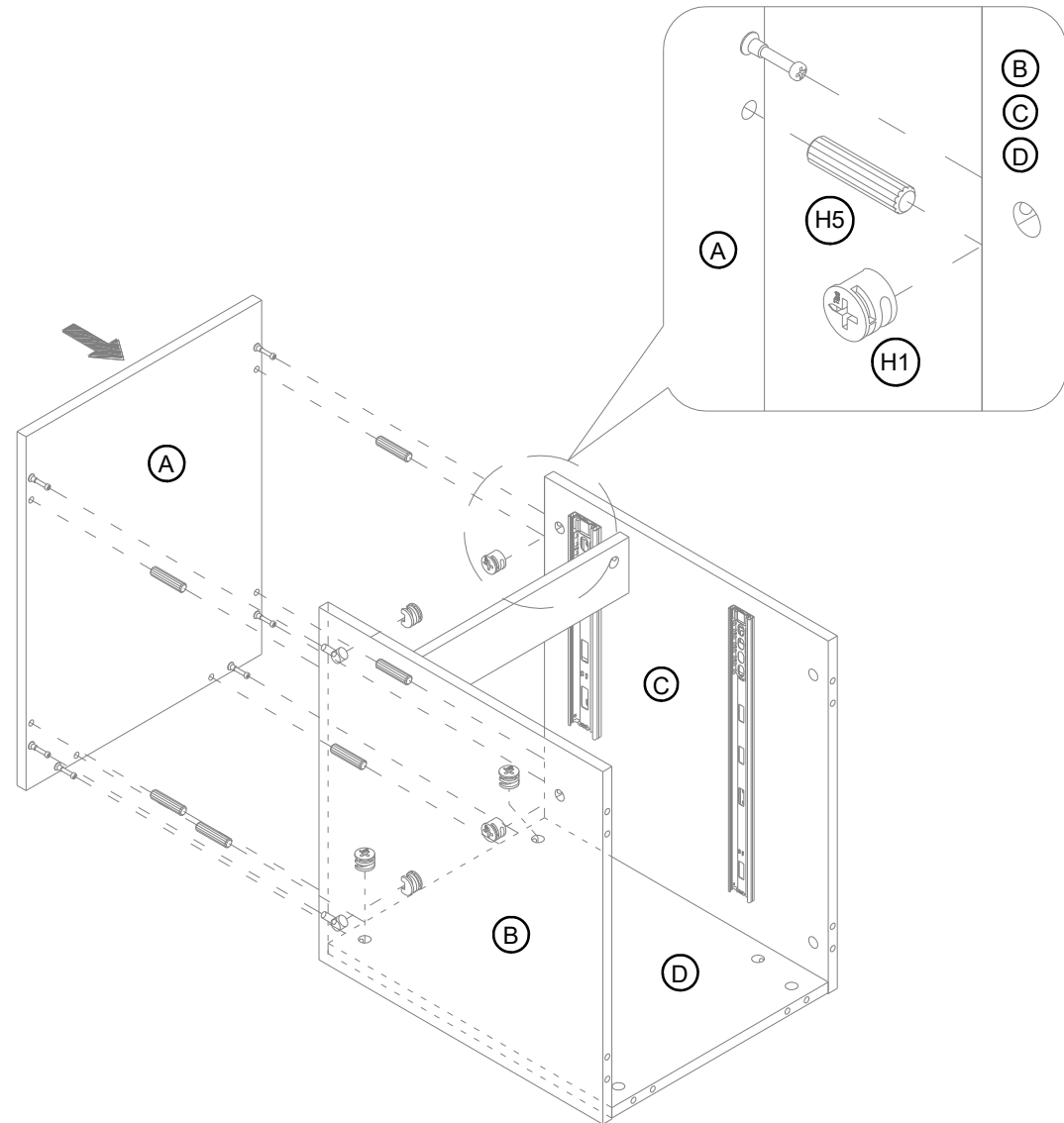
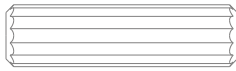

- 15.1. Insert six large wood dowels (H5) into the top inner holes on both side panels (B and C) and the back panel (D).
- 15.2. Align and attach the top panel (A) to both side panels (B and C) and the back panel (D) by engaging six large cam locks (H1).

step 16: attach the bottom panel

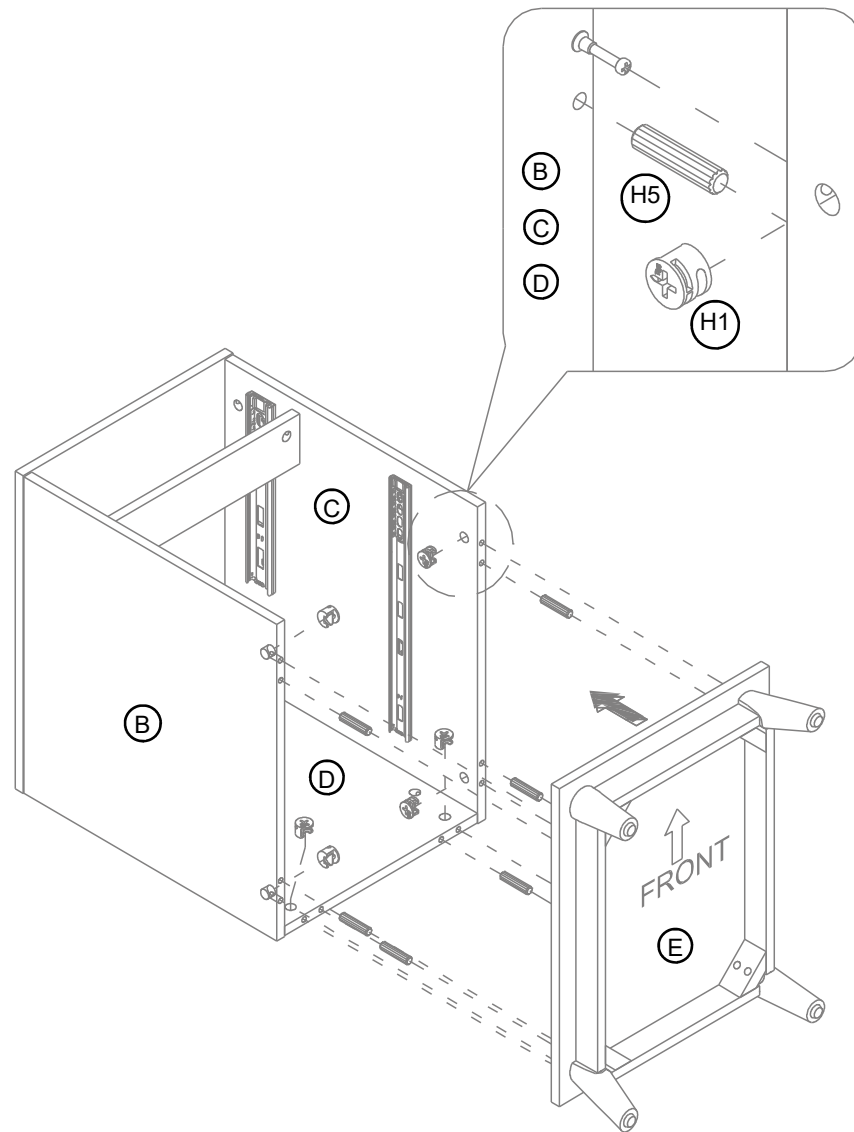

(H1) x 6
large cam lock



(H5) x 6
M8 x 30 mm wood dowel

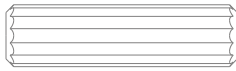

- 16.1. Insert six large wood dowels (H5) into the bottom inner holes on both side panels (B and C) and the back panel (D).
- 16.2. Orient and attach the assembled bottom panel (E) to both side panels (B and C) and the back panel (D) by engaging six large cam locks (H1).

step 17: install the drawers

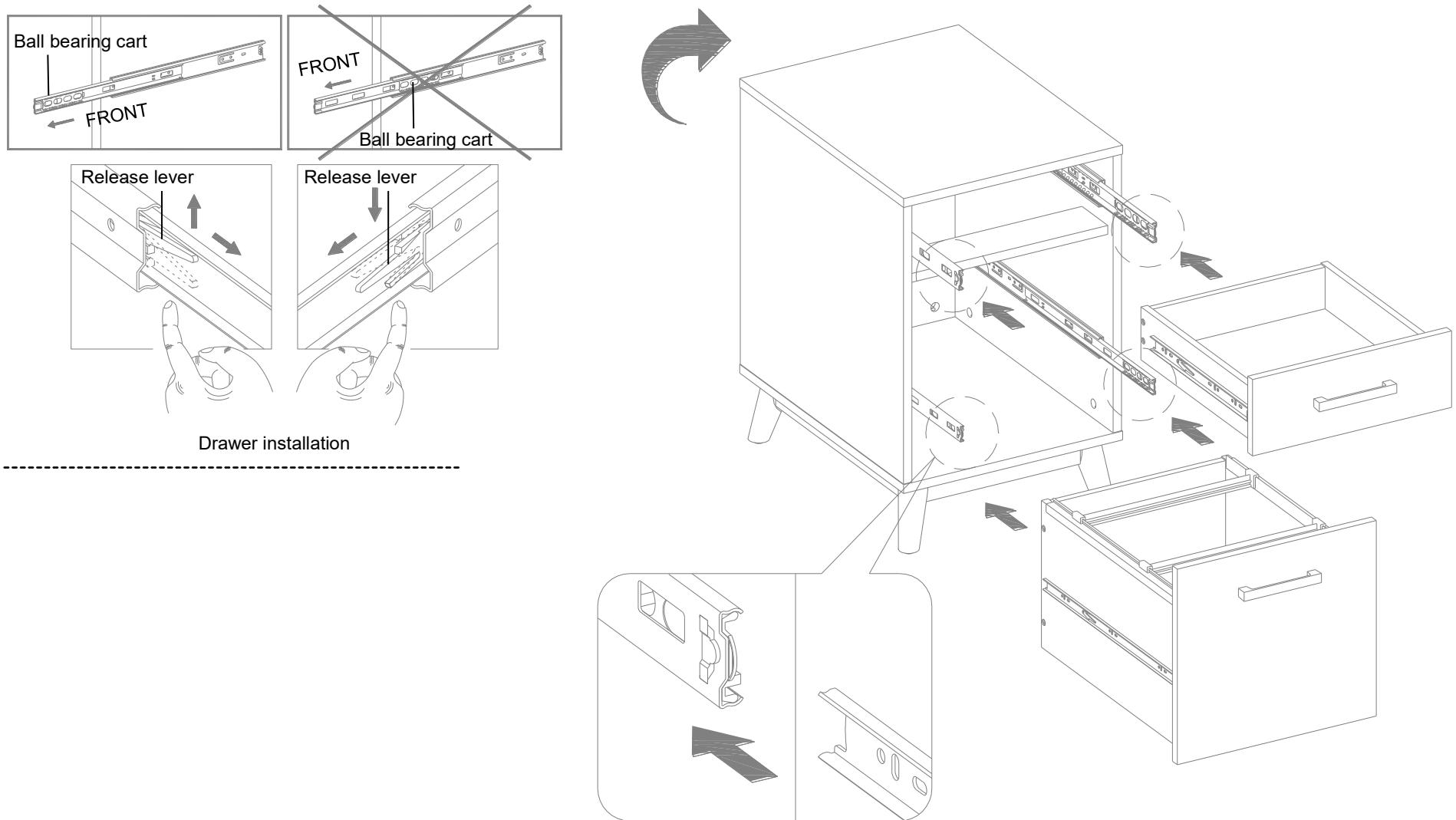

17.1. Now, go back and tighten all cam locks and screws. Make sure all the parts are tight and there are no gaps between the parts. This will help keep the unit square. Ask for assistance to lift the unit upright and put it near your desired location.

17.2. To insert the assembled drawers into the frame, extend the ball bearing slide tracks on the unit all the way forward (including ball bearing cart), then align the slide runners on the assembled drawers with the slide tracks and push the drawers carefully inside until they stop.

NOTE: If the drawer does not go in smoothly, please take it out and repeat the step. If you need to remove the drawer, please pull the drawer all the way out, then simultaneously push the plastic release lever of the ball bearing slides up on one side and down on the other side, and then pull it completely out.

step 18: adjust floor levelers

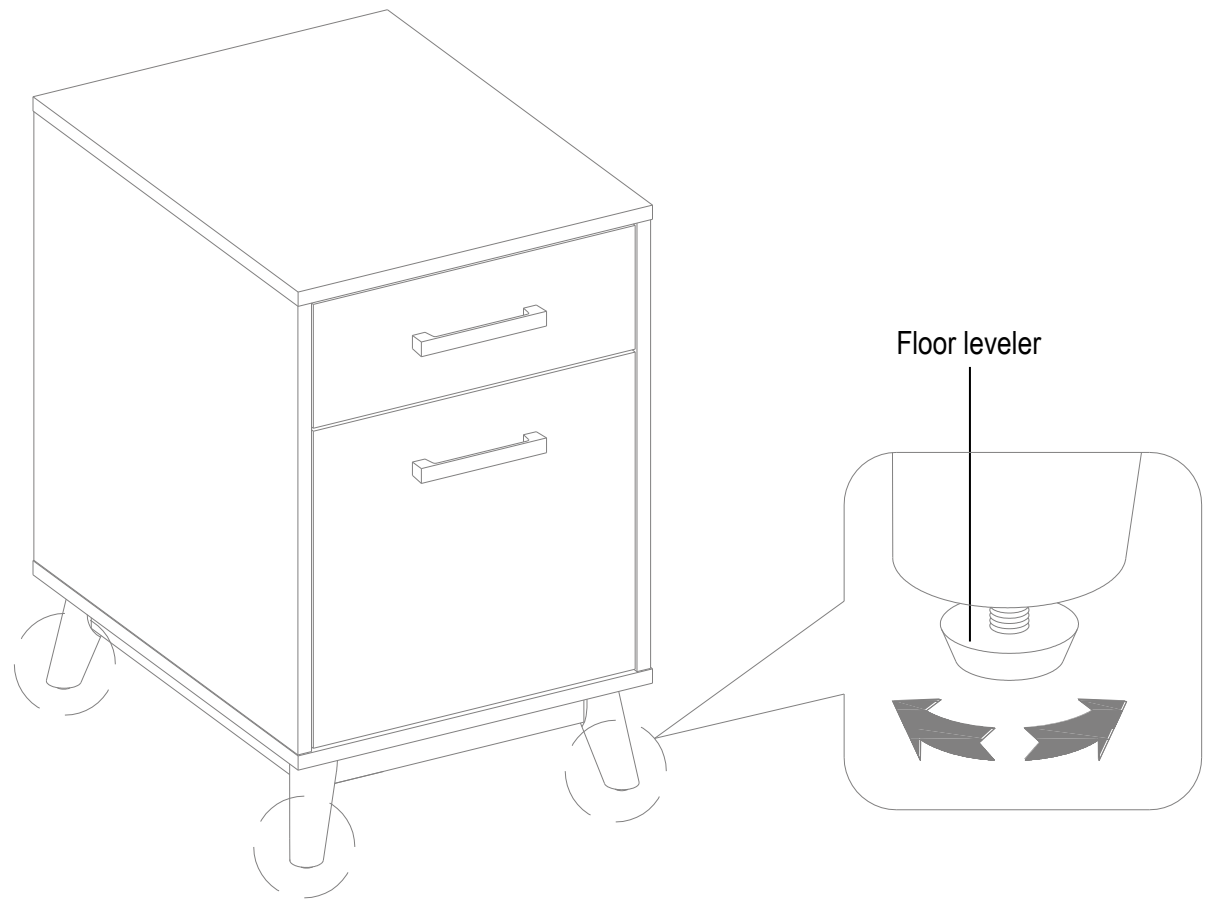

18.1. Adjust the floor levelers pre-attached at the bottom of the feet (S) to level the unit against a wall.

step 19: install the tipping restraint hardware kit



(H13) x 1
tipping restraint hardware kit
(inside plastic bag)

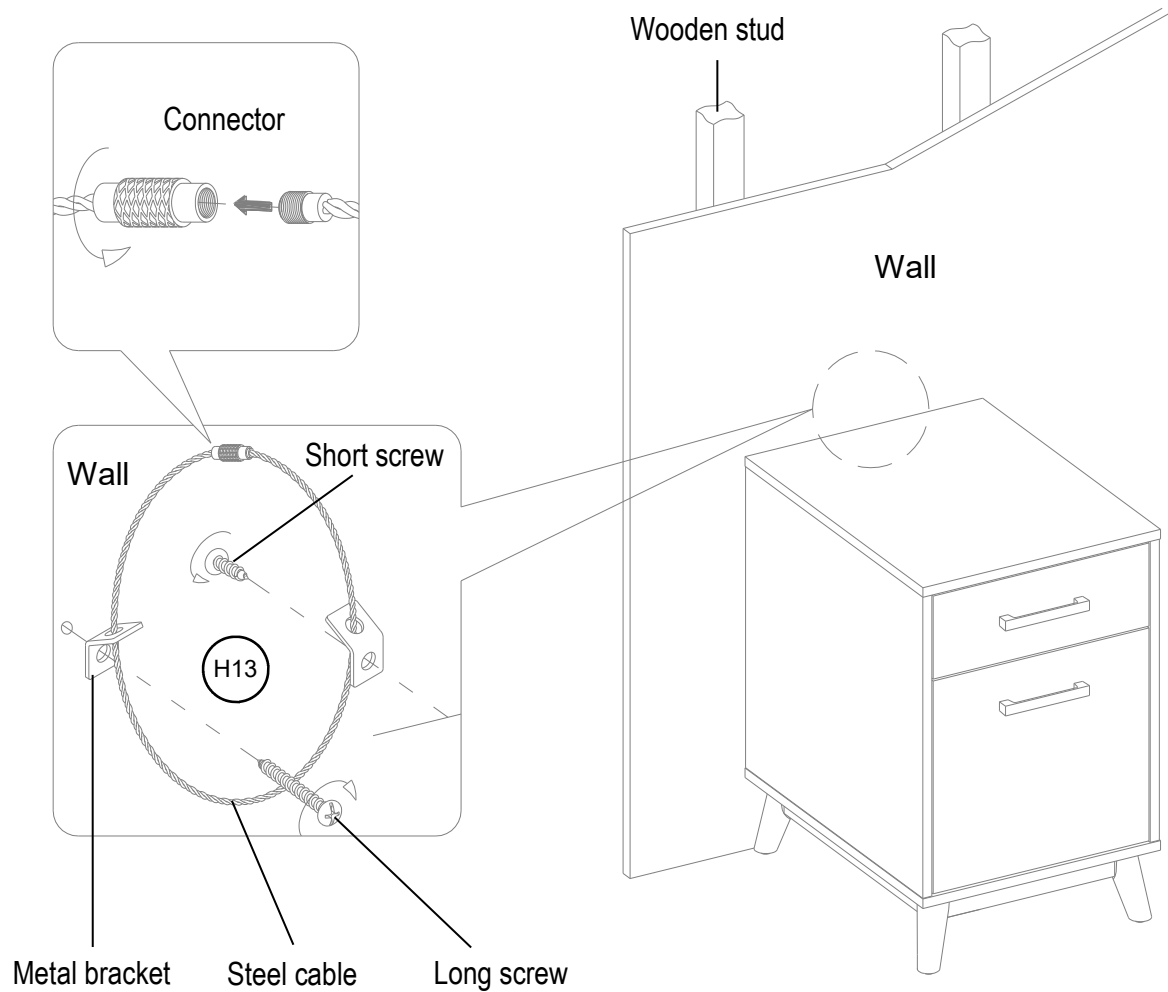
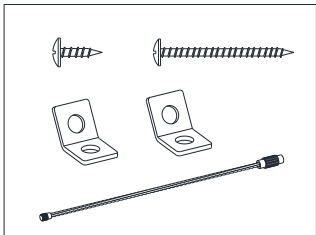

Tools required: Phillips screwdriver, stud finder, tape measure, pencil, power drill and 1/8" drill bit (not provided).

- 19.1. Follow the instructions printed on plastic bag containing tipping restraint hardware to attach tip-over restraint between the unit and wall.
NOTE: You must use this tipping restraint to attach this unit to the wall, to prevent accidents and/or injuries.

Care and Maintenance

- Use a soft, clean cloth that will not scratch the surface when dusting.
- Use of furniture polish is not necessary. Should you choose to use polish, test first in an inconspicuous area.
- Using solvents of any kind on your furniture may damage the finish.
- Never use water to clean your furniture as it may cause damage to the finish.
- Always use coasters under beverage glasses and flowerpots.
- Liquid spills should be removed immediately. Using a soft, clean cloth, blot the spill gently. Avoid rubbing.
- Always use protective pads under hot dishes and plates. Heat can cause chemical changes that may create spotting within the furniture finish.
- Stains or marks from crayons or ink markers will be difficult to remove.
- In the event that your furniture is stained or otherwise damaged during use, we recommend that you call a professional to repair your furniture.
- Check bolts/screws and nuts periodically and tighten them if necessary.

Further Advice about Wood Furniture Care

It is best to keep your furniture in a climate-controlled environment. Extreme temperature and humidity changes can cause fading, warping, shrinking and splitting of wood. It is advised to keep furniture away from direct sunlight as sun may damage the finish.

Proper care and cleaning at home will extend the life of your purchase. Following these important and helpful tips will enhance your furniture as it ages.

We hope you enjoy your purchase for many years.
Thank you for your purchase!

QUALITY GUARANTEE

We are confident that you will be delighted with your Whalen Furniture purchase.

Should this product be defective in workmanship or materials or fail under normal use, we will repair or replace it for up to one (1) year from date of purchase. Every Whalen Furniture product is designed to meet your highest expectations. We guarantee that you will immediately see the value of our fine furniture.

This warranty gives you specific legal rights and you may also have other rights which vary from state to state or province to province.

Customer Service: 1-855-MYTGTHOME (855-698-4846)
8:30 a.m. - 4:30 p.m., PST, Monday to Friday
www.whalenfurniture.com

MAXIMUM RECOMMENDED WEIGHT LOADS

MANUFACTURER: Whalen Furniture Manufacturing
CATALOG: 2-Drawer File Cabinet
MODEL # TGT15FC

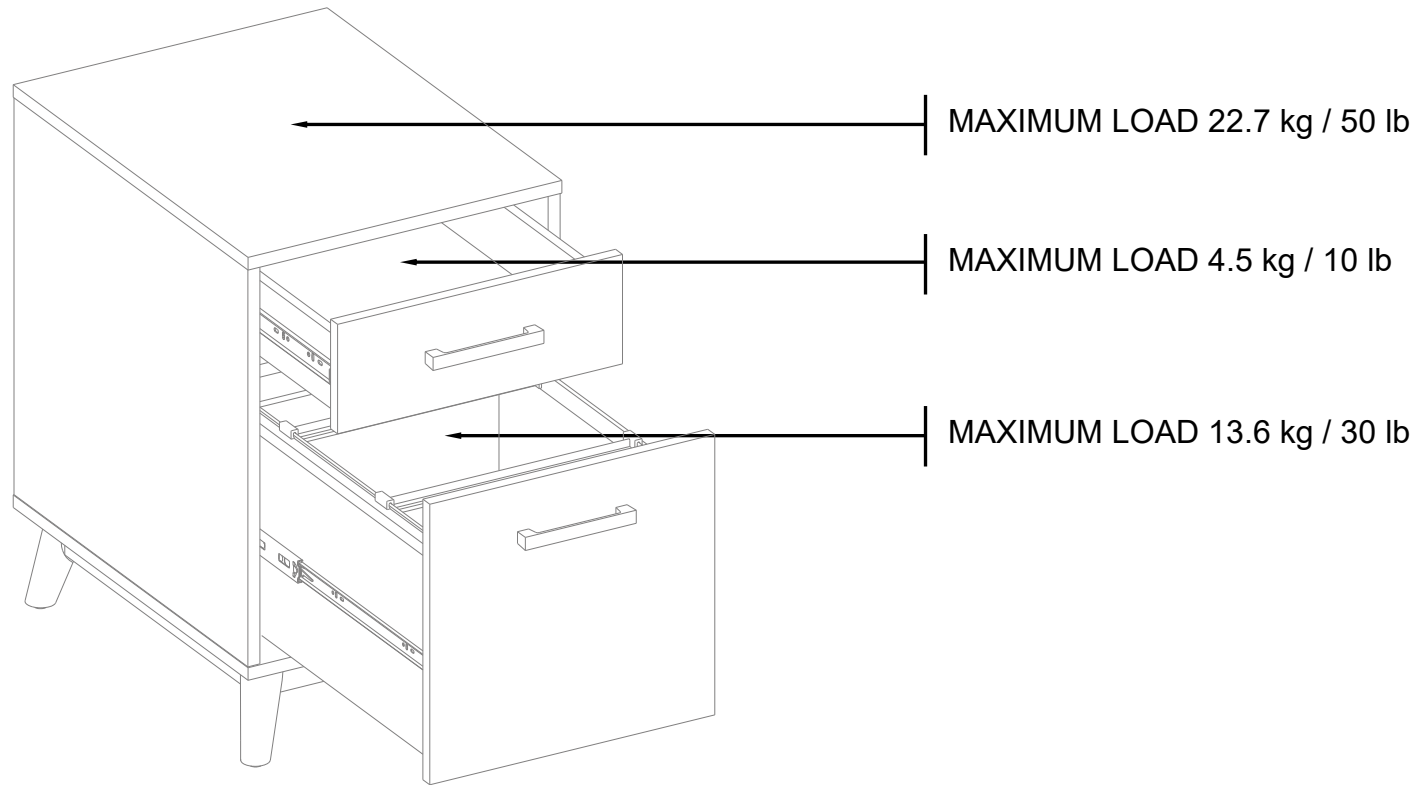

THIS UNIT IS INTENDED ONLY FOR USE WITHIN THE MAXIMUM WEIGHTS INDICATED. CENTER THE HEAVIER ITEM ON THE SUPPORTING SURFACE AS FAR BACK FROM THE FRONT AS POSSIBLE. USE WITH LOADS HEAVIER THAN THE MAXIMUM WEIGHTS INDICATED MAY RESULT IN INSTABILITY, CAUSING POSSIBLE INJURY.

The maximum recommended weight allowance is 22.7 kg / 50 lb for the top.

The maximum recommended weight allowance is 4.5 kg / 10 lb for the utility drawer.

The maximum recommended weight allowance is 13.6 kg / 30 lb for the file drawer.

 **WARNING**

Please use your furniture correctly and safely. Improper use can cause safety hazards, or damage to your furniture or household items. Carefully read the following safety information.

Death or serious injury may occur when children climb on audio and/or video equipment furniture. A remote control or toys placed on the furnishing may encourage a child to climb on the furnishing and as a result may tip over onto the child.

NEVER allow children to climb or play with the TV or furnishing supporting the TV.

NEVER place toys, food, remote, etc. on top of the TV or TV furnishing.

ALWAYS use either the safety hardware as instructed or other wall anchoring device.

Relocating audio and/or video equipment to furniture not specifically designed to support audio and/or video equipment may result in death or serious injury due to furniture collapse or over turning onto a child.

NEVER place a TV on furniture that is not intended to support a TV.

NEVER exceed the maximum size and weight of the TV shown in the instructions.

Be sure to refer to the TV warning label as shown in the instructions.

Overloading drawers and shelves may result in furniture that can break or sag, or tip-over which may result in injury.

NEVER exceed the weight limits shown in the instructions.

Place the heavier items on lower shelves as far back from the front as possible.

Load the bottom surfaces first to avoid top-heavy furniture.

Moving furniture that is not designed to be moved or equipped with casters may result in injury or damage to furnishings or personal property.

ALWAYS unload shelves and drawers, starting with the top surfaces, before moving.

NEVER push or pull furniture on carpet. Have a friend help lift properly to move and/or reposition it.

DO NOT use the unit as a seating surface.

FURNITURE TIPPING RESTRAINT

YOUNG CHILDREN MAY BE INJURED BY TIPPING FURNITURE AND YOU MUST USE THIS TIPPING RESTRAINT TO ATTACH THIS UNIT TO THE WALL, TO PREVENT ACCIDENTS AND/OR INJURIES.

THIS HARDWARE, MUST BE PROPERLY INSTALLED (FOLLOW ALL DIRECTIONS IN ORDER ON THIS INSTRUCTIONS), TO PROVIDE PROTECTION AGAINST THE UNEXPECTED TIPPING OF FURNITURE DUE TO IMPROPER USE.

THIS PRODUCT IS ONLY A DETERRENT. IT IS NOT A SUBSTITUTE FOR PROPER ADULT SUPERVISION. USE OF TIP-OVER RESTRAINTS MAY ONLY REDUCE, BUT NOT ELIMINATE, THE RISK OF TIP-OVER.

WARNING

- Unit must be placed on a level surface or leveled with included hardware (when applicable).
- Do not sit or stand on or allow children to climb, sit or stand on the assembled product.
- For safety reasons, it is imperative that this unit be mounted to the wall.
- Do not use without installing the tip restraint.
- Unit can tip over causing severe injury or death.
- Do not exceed the recommended weight limits.
- Evenly distribute the weight on each level and always keep the heavier loads on the bottom.
- Before cutting, drilling or hammering into any wall or floor surface, verify the location of electrical, plumbing and gas lines. Cutting may cause serious injury.